

AZ-300 Dumps

Microsoft Azure Architect Technologies

<https://www.certleader.com/AZ-300-dumps.html>



NEW QUESTION 1

You need to resolve a notification latency issue.

Which two actions should you perform? Each correct answer presents part of the solution. NOTE: Each correct selection is worth one point.

- A. Ensure that the Azure Function is set to use a consumption plan.
- B. Set Always On to false
- C. Set Always On to true
- D. Ensure that the Azure Function is using an App Service plan.

Answer: AC

NEW QUESTION 2

You need to add code at line EG15 in EventGridController.cs to ensure that the tag policy applies to all services.

How should you complete the code? To answer, drag the appropriate code segments to the correct locations. Each code segment may be used once, more than once, or not at all. You may need to drag the Split bar between panes or scroll to view content.

NOTE: Each correct selection is worth one point.

Code segments

- topic
- status
- eventType
- Succeeded
- operationName
- resourceProvider

Answer Area

```

if (
    @event[ "data" ][ "code segment" ].ToString() == "code segment"
    ||
    @event[ "data" ][ "code segment" ].ToString() == "Microsoft.Web/sites/write"
)
    
```

Answer:

Explanation:

Code segments

- topic
- status
- eventType
- Succeeded
- operationName
- resourceProvider

Answer Area

```

if (
    @event[ "data" ][ "eventType" ].ToString() == "resourceProvider"
    ||
    @event[ "data" ][ "topic" ].ToString() == "Microsoft.Web/sites/write"
)
    
```

NEW QUESTION 3

You need to ensure that the Policy service can implement the policy actions. Which code segment should you insert at line EG07 in EventGridController.cs?

- A.

```
if (HttpContext.Request.Headers["aeg-event-type"].FirstOrDefault()
    == "SubscriptionValidation")
{
    return new JsonResult(new
    {
        validationResponse = events[0]["validationCode"]
    });
}
```
- B.

```
if (events[0]["eventType"].ToString() == "SubscriptionValidation")
{
    return new JsonResult(new
    {
        validationResponse = events[0]["validationCode"]
    });
}
```
- C.

```
if (HttpContext.Request.Headers["aeg-event-type"].FirstOrDefault() ==
    "SubscriptionValidation")
{
    return new JsonResult(new
    {
        validationResponse = events[0]["data"]["validationCode"]
    });
}
```
- D.

```
if (events[0]["subject"].ToString() == "SubscriptionValidation")
{
    return new JsonResult(new
    {
        validationResponse = events[0]["data"]["validationCode"]
    });
}
```

- A. Option A
B. Option B
C. Option C
D. Option D

Answer: C

NEW QUESTION 4

You need to meet the technical requirement for VM4. What should you create and configure?

- A. an Azure Event Hub
B. an Azure Notification Hub
C. an Azure Logic App
D. an Azure Service Bus

Answer: C

NEW QUESTION 5

You need to implement Role1.

Which command should you run before you create Role1? To answer, select the appropriate options in the answer area.

NOTE: Each correct selection « worth one point.



Answer:

Explanation:



NEW QUESTION 6

You need to implement App2 to meet the application requirements.

What should you include in the implementation? To answer, select the appropriate options in the answer area. NOTE: Each correct selection is worth one point.

App Service plan pricing tier:

	V
Isolated	
Shared	
Standard	

Enabled feature:

	V
Always On	
Auto Swap	
Web Sockets	

Answer:

Explanation: References:

<https://azure.microsoft.com/en-us/pricing/details/app-service/plans/> <https://docs.microsoft.com/en-us/azure/azure-functions/functions-scale>

NEW QUESTION 7

You are developing a workflow solution using Azure technologies.

What should you implement to meet each requirement? To answer, select the appropriate options in the answer area.

NOTE: Each correct selection is worth one point.

Requirement	Tool
Debug the solution by using Visual Studio.	<div> <input type="checkbox"/> </div> <div> <input type="checkbox"/> Durable functions only <input type="checkbox"/> Logic Apps only <input type="checkbox"/> Durable functions and Logic Apps </div>
Use a collection of ready-made actions.	<div> <input type="checkbox"/> </div> <div> <input type="checkbox"/> Durable functions only <input type="checkbox"/> Logic Apps only <input type="checkbox"/> Durable functions and Logic Apps </div>
Deploy the component by using Visual Studio Team Services.	<div> <input type="checkbox"/> </div> <div> <input type="checkbox"/> Durable functions only <input type="checkbox"/> Logic Apps only <input type="checkbox"/> Durable functions and Logic Apps </div>

Answer:

Explanation:

Requirement

Tool

Debug the solution by using Visual Studio.

☐

☐ Durable functions only
 ☐ Logic Apps only
 ☐ Durable functions and Logic Apps

Use a collection of ready-made actions.

☐

☐ Durable functions only
 ☐ Logic Apps only
 ☐ Durable functions and Logic Apps

Deploy the component by using Visual Studio Team Services.

☐

☐ Durable functions only
 ☐ Logic Apps only
 ☐ Durable functions and Logic Apps

NEW QUESTION 8

You are developing a web app that uses a REST interface to connect to Azure Storage with HTTPS. This app uploads and streams video content that can be accessed from anywhere in the world.

You have different storage requirements for each part of the app. A hierarchical namespace must be created. Which storage services should you implement? To answer, select the appropriate services to the correct actions. Each service may be used once, more than once, or not at all. You may need to drag the split bar between panes or scroll to view content.

NOTE: Each correct selection is worth one point.

Storage services	Answer Area	
	Action	Storage service
Azure Blobs	Stream video content.	
Azure Table Storage	Perform random read/write operations.	
Azure HDInsight	Access application data from anywhere.	

Answer:

Explanation:

Storage services	Answer Area	
	Action	Storage service
Azure Blobs	Stream video content.	Azure Blobs
Azure Table Storage	Perform random read/write operations.	Azure Blobs
Azure HDInsight	Access application data from anywhere.	Azure Blobs

NEW QUESTION 9

You are developing a Docker/Go using Azure App Service Web App for Containers. You plan to run the container in an App Service on Linux. You identify a Docker container image to use.

None of your current resource groups reside in a location that supports Linux. You must minimize the number of resource groups. You need to create the application and perform an initial deployment required.

Which three Azure CLI commands should you use to develop the solution? To answer, move the appropriate commands from the list of commands to the answer area and arrange them in the correct order.

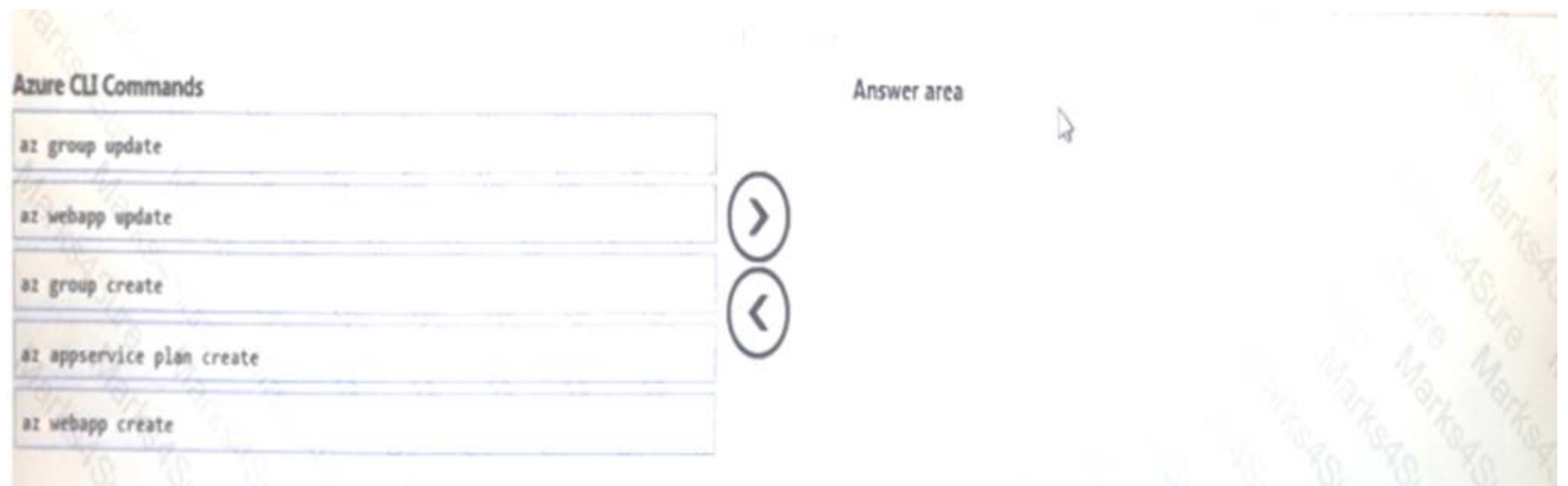

Answer:

Explanation: az group create
az appservice plan create az webapp create

NEW QUESTION 10

You have an Azure subscription named Subscription1 that contains an Azure virtual machine named VM1. VM1 is in a resource group named RG1. VM1 runs services that will be used to deploy resources to RG1. You need to ensure that a service running on VM1 can manage the resources in RG1 by using the identity of VM1. What should you do first?

- A. From the Azure portal, modify the Access control (IAM) settings of RG1.
- B. From the Azure portal, modify the Policies settings of RG1.
- C. From the Azure portal, modify the Access control (IAM) settings of VM1.
- D. From the Azure portal, modify the value of the Managed Service Identity option for VM1.

Answer: D

Explanation: References:
<https://docs.microsoft.com/en-us/azure/active-directory/managed-identities-azure-resources/overview>

NEW QUESTION 10

You have an Azure subscription named Subscription1 that contains a virtual network named VNet1. You add the users in the following table.

User	Role
User1	Owner
User2	Security Admin
User3	Network Contributor

Which user can perform each configuration? To answer, select the appropriate options in the answer area. NOTE: Each correct selection is worth one point.

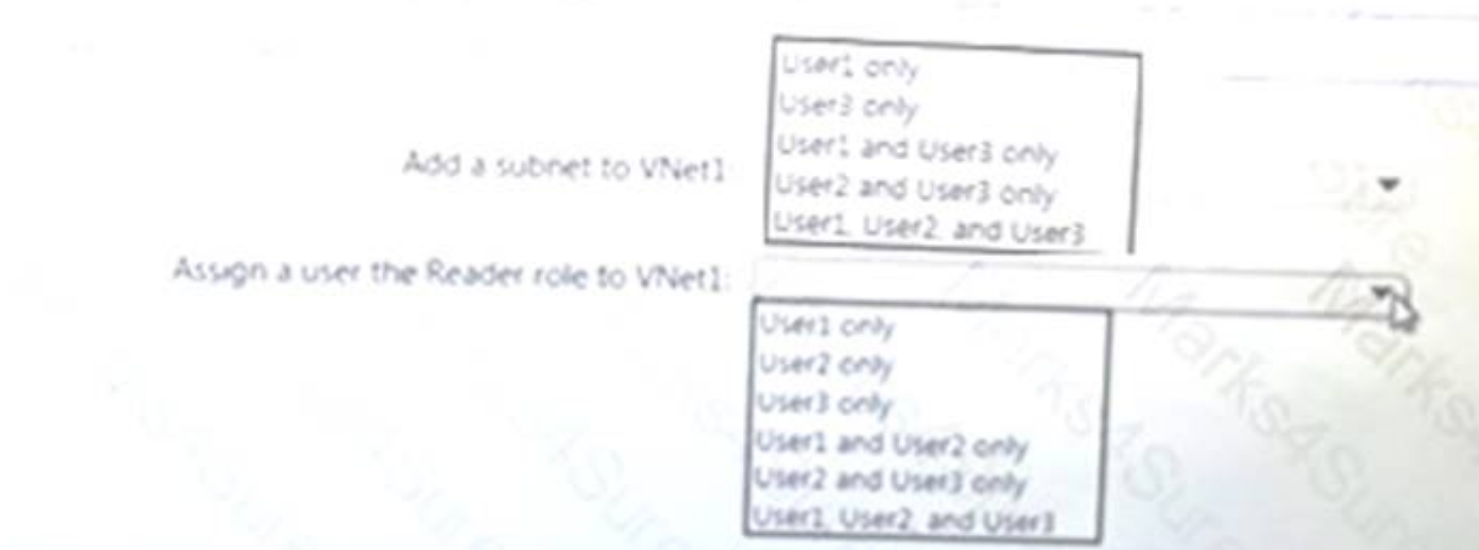

Answer:

Explanation:

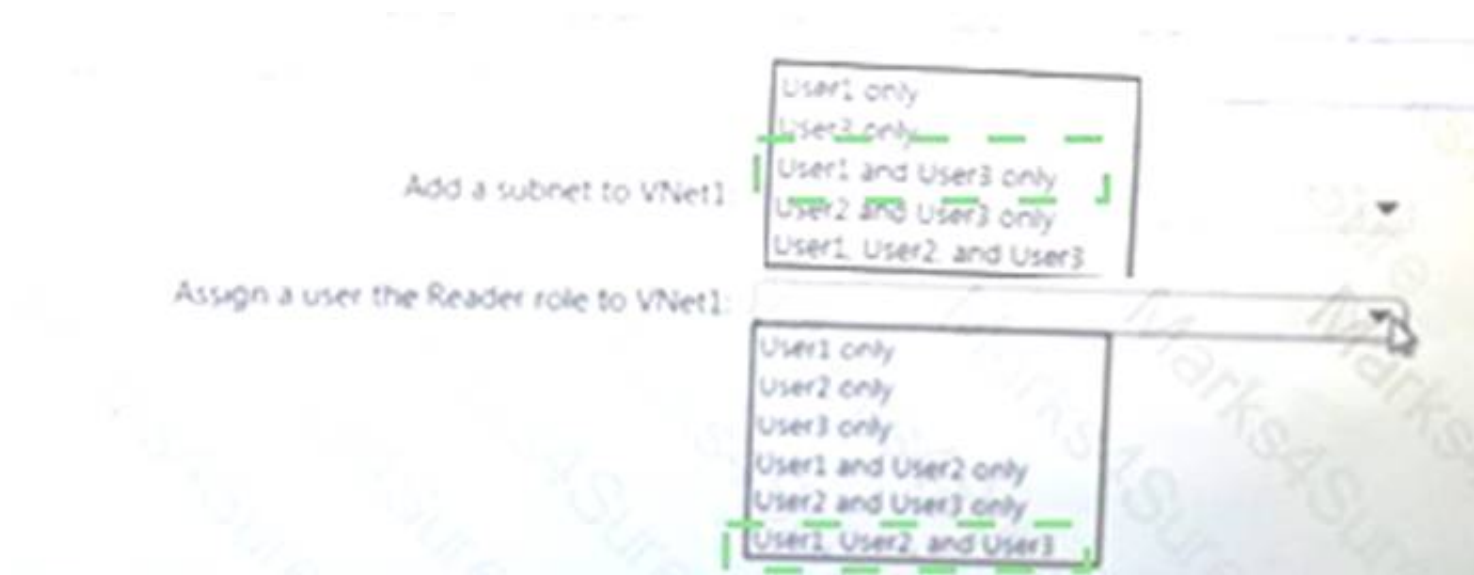

NEW QUESTION 12

You develop software solutions for a web services company. You have the following code. (Line numbers are for reference only.)

```

01 public class MessagesController : ApiController
02 {
03     public async Task<HttpResponseMessage> Post([FromBody]Activity activity)
04     {
05         if (activity.GetActivityType() == ActivityTypes.Message)
06         {
07             await Conversation.SendAsync(activity, () => new Dialogs.RootDialog());
08         }
09         else
10         {
11             HandleSystemMessage(activity);
12         }
13         var response = Request.CreateResponse(HttpStatusCode.OK);
14         return response;
15     }
16 }
17 [Serializable]
18 public class RootDialog : IDialog<object>
19 {
20     public Task StartAsync(IDialogContext context)
21     {
22         context.Wait(MessageReceivedAsync);
23         return Task.CompletedTask;
24     }
25     public virtual async Task MessageReceivedAsync(IDialogContext context, IAwaitable<IMessageActivity> result)
26     {
27         var message = await result;
28         if (message.Text.ToLower().Contains("help") || message.Text.ToLower().Contains("support"))
29         {
30             await context.Forward(new SupportDialog(), this.ResumeAfterSupportDialog, message);
31         }
32         else
33         {
34             await context.PostAsync($"Hello. I can help you with the following keywords : help | support");
35             context.Wait(MessageReceivedAsync);
36         }
37     }
38     private async Task ResumeAfterSupportDialog(IDialogContext context, IAwaitable<object> result)
39     {
40         try
41         {
42             var message = await result;
43         }
44         finally
45         {
46             context.Wait(this.MessageReceivedAsync);
47         }
48     }
49 }

```

You need to implement an immediate response customer support solution for the company's website. For each of the following statements, select, Yes if the statement is true. Otherwise, select No.

NOTE: Each correct selection is worth one point.

	Yes	No
A child dialog will handle any messages that contain the word support .	<input type="radio"/>	<input type="radio"/>
RootDialog will return to the top of the stack after SupportDialog handles a request.	<input type="radio"/>	<input type="radio"/>

Answer:

Explanation:



NEW QUESTION 14

Note: This question is part of series of questions that present the same scenario. Each question in the series contains a unique solution that might meet the stated goals. Some question sets might have more than one correct solution, while others might not have a correct solution.

After you answer a question in this section, you will NOT be able to return to it. As a result, these questions will not appear in the review screen.

A company backs up data to on-premises servers at their main facility. The company currently has 30 TB of archived data that infrequently used. The facility has download speeds of 100 Mbps and upload speeds of 20 Mbps.

You need to securely transfer all backups to Azure Blob Storage for long-term archival. All backup data must be sent within seven days.

Solution: Backup data to local disks and use the Azure Import/Export service to send backups to Azure Blob Storage.

Does this meet the goal?

A. Yes

B. No

Answer: A

NEW QUESTION 18

You are developing an application that consists of an ASP.NET Core Web API website and a WebJob that starts automatically and runs continuously. You are building the deployment process for the application.

You need to ensure that both the website and the WebJob are deployed.

How should you structure the deployment folders? To answer, drag the appropriate path segments to the correct locations. Each path segment may be used once, more than once, or not at all. You may need to drag the split bar between panes or scroll to view content.

NOTE: Each correct selection is worth one point.



Answer:

Explanation:

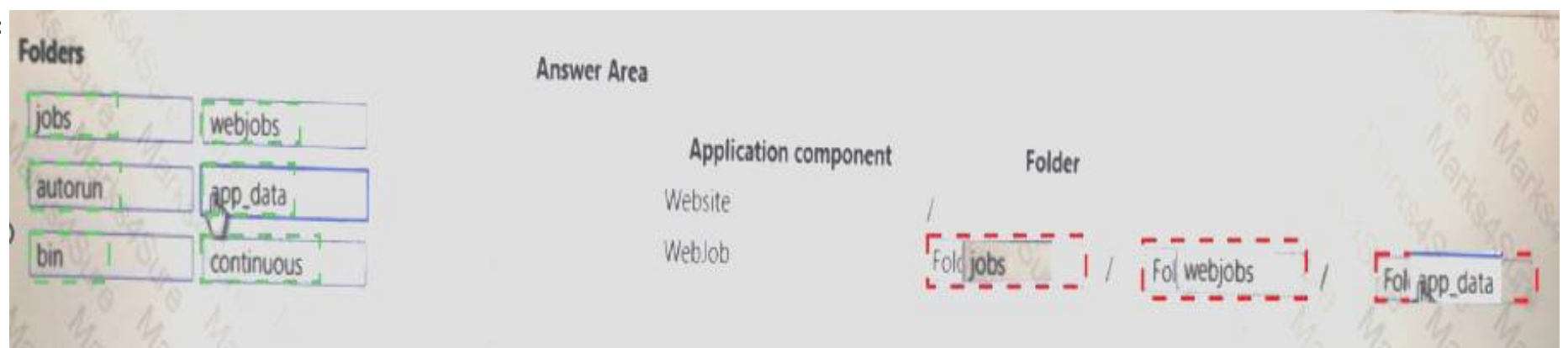

NEW QUESTION 23

Note: This question is part of series of questions that present the same scenario. Each question in the series contains a unique solution that might meet the stated goals. Some question sets might have more than one correct solution, while others might not have a correct solution.

After you answer a question in this section, you will NOT be able to return to it. As a result, these questions will not appear in the review screen.

A company backs up data to on-premises servers at their main facility. The company currently has 30 TB of archived data that infrequently used. The facility has download speeds of 100 Mbps and upload speeds of 20 Mbps.

You need to securely transfer all backups to Azure Blob Storage for long-term archival. All backup data must be sent within seven days.

Solution: Use the Set-AzureStorageBlobContent Azure PowerShell command to copy all backups asynchronously to Azure Blob Storage.

Does this meet the goal?

- A. Yes
- B. No

Answer: B

NEW QUESTION 25

You are developing a back-end Azure App Service that scales based on the number of messages contained in a Service Bus queue.

A rule already exists to scale up the App Service when the average queue length of unprocessed and valid queue messages is greater than 1000.

You need to add a new rule that will continuously scale down the App Service as long as the scale up condition is not met.

How should you configure the Scale rule? To answer, select the appropriate options in the answer area. NOTE: Each correct selection is worth one point.

Scale Rule

X

Metric source

Storage queue
Service Bus queue
Current resource
Storage queue(classic)

Resource type

Service Bus Namespaces v

Resource

MessageQueue1103 v

*Queues

itemqueue v

Criteria

*Metric name

Message Count
Active Message Count

1 minute time grain

*Time grain statistic ⓘ

Total
Maximum
Average
Count

*Operator

Greater than
Greater than or equal to
Less than
Less than or equal to

*Threshold

1000

Action

*Operation

Increase count by
Increase count to
Decrease count by
Decrease count to

Answer:

Explanation:

Scale Rule

X

Metric source

Storage queue
Service Bus queue
Current resource
Storage queue(classic)

Resource type

Service Bus Namespaces v

Resource

MessageQueue1103 v

*Queues

itemqueue v

Criteria

*Metric name

Message Count
Active Message Count

1 minute time grain

*Time grain statistic ⓘ

Total
Maximum
Average
Count

*Operator

Greater than
Greater than or equal to
Less than
Less than or equal to

*Threshold

1000

Action

*Operation

Increase count by
Increase count to
Decrease count by
Decrease count to

*Cool down (minutes) ⓘ

5

UPDATE

DELETE

NEW QUESTION 27

Contoso. Ltd. hosts the following ASP.NET workloads in Azure:

Workload	Server	Database
Sales	db_srv_sales_contoso	db_sales_contoso
Inventory	db_inventory_contoso	db_inventory_contoso

Users of the Sales software report mismatches between shown inventory at the time of sale and actual availability. Transactions across the two systems result in inconsistent reads and writes. You encapsulate Sales order creation and Inventory status updates in elastic transactions.

You need to recommend changes to code and the databases to support transactions.

Which actions should you recommend? To answer, select the appropriate options in the answer area. NOTE: Each correct selection is worth one point.

Step
Configure Database
Transactions

Action

Use the New-AzureRmSqlServerCommunicationsPool PowerShell cmdlet.
Use the Set-AzureRmSqlElasticPool PowerShell cmdlet.
Use the Set-AzureRmSqlElasticPoolRecommendedActionState PowerShell cmdlet.
Use the New-AzureRmSqlSyncGroup PowerShell cmdlet.

Use BEGIN-DISTRIBUTED-TRANSACTION in T-SQL.
Use TransactionScope in System.Transactions.
Use BEGIN-TRANSACTION in T-SQL.
Use BEGIN-DISTRIBUTED-TRANSACTION in T-SQL.
Use COMMIT TRANSACTION in T-SQL.

Answer:

Explanation:

Step
Configure Database
Transactions

Action

Use the New-AzureRmSqlServerCommunicationsPool PowerShell cmdlet.
Use the Set-AzureRmSqlElasticPool PowerShell cmdlet.
Use the Set-AzureRmSqlElasticPoolRecommendedActionState PowerShell cmdlet.
Use the New-AzureRmSqlSyncGroup PowerShell cmdlet.

Use BEGIN-DISTRIBUTED-TRANSACTION in T-SQL.
Use TransactionScope in System.Transactions.
Use BEGIN-TRANSACTION in T-SQL.
Use BEGIN-DISTRIBUTED-TRANSACTION in T-SQL.
Use COMMIT TRANSACTION in T-SQL.

NEW QUESTION 30

You are developing a solution that requires serverless code execution in Azure. The solution has two functions that must run in a specific order.

You need to ensure that the second function can use the output from the first function.

How should you complete the code? To answer, select the appropriate options in the answer area. NOTE: Each correct selection is worth one point.

```

public static async Task<object> Run (
{
try
{
var f1Result = await c.
return await c.
}
catch (Exception e)
{
...
}
}

```

DurableOrchestrationContext
DurableActivityContext
DurableOrchestrationClient
DurableOrchestrationStatus

CallActivityAsync
CallSuborchestratorAsync
WaitForExternalEvent

CallActivityAsync
CallSubOrchestratorAsync
WaitForExternalEvent

C)

<object>("AzureFunction01", null);

<object>("AzureFunction02", f1Result);

Answer:

Explanation:

```
public static async Task<object> Run (
{
    try
    {
        var flResult = await c.
        return await c.
    }
    catch (Exception e)
    {
        ...
    }
}
```

C)

DurableOrchestrationContext
DurableActivityContext
DurableOrchestrationClient
DurableOrchestrationStatus

CallActivityAsync
CallSuborchestratorAsync
WaitForExternalEvent

<object>("AzureFunction01", null);

CallActivityAsync
CallSubOrchestratorAsync
WaitForExternalEvent

<object>("AzureFunction02", flResult);

NEW QUESTION 34

You are creating an app that uses Event Grid to connect with other services. Your app's event data will be sent to a serverless function that checks compliance. This function is maintained by your company. You write a new event subscription at the scope of your resource. The event must be invalidated after a specific period of time. You need to configure Event Grid to ensure security. What should you implement? To answer, select the appropriate options in the answer area. NOTE: Each correct selection is worth one point.

Authentication

Type

WebHook event delivery

	▼
SAS tokens	
Key authentication	
JWT token	

Topic publishing

	▼
ValidationCode handshake	
ValidationURL handshake	
Management Access Control	

Answer:

Explanation: References:

<https://docs.microsoft.com/en-us/azure/event-grid/security-authentication>

NEW QUESTION 38

Fourth Coffee has an ASP.Net Core web app that runs in Docker. The app is mapped to the www.fourthcoffee.com domain.

Fourth Coffee is migrating this application to Azure.

You need to provision an App Service Web App to host this docker image and map the custom domain to the App Service web app.

A resource group named FourthCoffeePublicWebResourceGroup has been created in the WestUS region that contains an App Service Plan named AppServiceLinuxDockerPlan.

Which order should the CLI commands be used to develop the solution? To answer, move all of the Azure CLI commands from the list of commands to the answer area and arrange them in the correct order.

Azure CLI commands

Answer Area

```
az webapp config container set  
--docker-custom-image-name  
SdockerHubContainerPath  
--name SappName  
--resource-group  
fourthCoffeePublicWebResourceGroup
```

```
az webapp create  
--name SappName  
--plan AppServiceLinuxDockerPlan  
--resource-group  
fourthCoffeePublicWebResourceGroup
```

```
#!/bin/bash  
appName="FourthCofeePublicWebSrandom"  
location="WestUS"  
dockerHubContainerPath="FourthCofee/publicwe  
fqdn="http://fourthcofee.com">www.fourth
```

```
az webapp config hostname add  
--webapp-name SappName  
--resource-group  
fourthCoffeePublicWebResourceGroup \  
--hostname Sfqn
```

Answer:

Explanation:

Azure CLI commands

```
az webapp config container set
--docker-custom-image-name
SdockerHubContainerPath
--name SappName
--resource-group
fourthCoffeePublicWebResourceGroup
```

```
az webapp create
--name SappName
--plan AppServiceLinuxDockerPlan
--resource-group
fourthCoffeePublicWebResourceGroup
```

```
#!/bin/bash
appName="FourthCofeePublicWebSrandom"
location="WestUS"
dockerHubContainerPath="FourthCofee/publicwe
fqdn="http://fourthcofee.com">www.fourth
```

```
az webapp config hostname add
--webapp-name SappName
--resource-group
fourthCoffeePublicWebResourceGroup \
--hostname Sfqn
```

Answer Area

```
#!/bin/bash
appName="FourthCofeePublicWebSrandom"
location="WestUS"
dockerHubContainerPath="FourthCofee/publicwe
fqdn="http://fourthcofee.com">www.fourth
```

```
az webapp create
--name SappName
--plan AppServiceLinuxDockerPlan
--resource-group
fourthCoffeePublicWebResourceGroup
```

```
az webapp config container set
--docker-custom-image-name
SdockerHubContainerPath
--name SappName
--resource-group
fourthCoffeePublicWebResourceGroup
```

```
az webapp config hostname add
--webapp-name SappName
--resource-group
fourthCoffeePublicWebResourceGroup \
--hostname Sfqn
```

NEW QUESTION 39

You have a cloud solution that uses an Azure Functions consumption plan to scale hundreds of processes. A portion of the code is shown below. (Line numbers are included for reference only.)

```

01 [FunctionName("StartFunction")]
02 public static async Task<HttpStatusCode> RunSingle(
03     [HttpTrigger(AuthorizationLevel.Function, methods:
04         "post", Route = "orchestrators/contoso_function01/{instance_id}")]
05     HttpRequestMessage req,
06     [OrchestrationClient] DurableOrchestrationClient starter,
07     string functionName, string instanceId, TraceWriter log)
08 {
09     var existingInstance = await starter.GetStatusAsync(instanceId);
10     if (existingInstance == null)
11     {
12         dynamic eventData = await req.Content.ReadAsAsync<object>();
13         await starter.StartNewAsync(functionName, instanceId, eventData);
14         log.Info($"Created");
15         return starter.CreateCheckStatusResponse(req, instanceId);
16     }
17     else
18     {
19         return req.CreateErrorResponse(HttpStatusCode.Conflict, $"Cannot create");
20     }
21 }

```

For each of the following statements, select Yes if the statement is true. Otherwise, select No. NOTE: Each correct selection is worth one point

Answer Area	Yes	No
The code intends to create an Azure Function singleton instance.	<input type="radio"/>	<input type="radio"/>
If no instanceID is passed into StartNewAsync, a random id is generated for the function.	<input type="radio"/>	<input type="radio"/>
The code ensures that there will never be two instances of the same function running.	<input type="radio"/>	<input type="radio"/>

Answer:

Explanation:

Answer Area	Yes	No
The code intends to create an Azure Function singleton instance.	<input type="radio"/>	<input checked="" type="radio"/>
If no instanceID is passed into StartNewAsync, a random id is generated for the function.	<input checked="" type="radio"/>	<input type="radio"/>
The code ensures that there will never be two instances of the same function running.	<input checked="" type="radio"/>	<input type="radio"/>

NEW QUESTION 42

You have a Microsoft SQL Server Always On availability group on Azure virtual machines. You need to configure an Azure internal load balancer as a listener for the availability group. What should you do?

- A. Create an HTTP health probe on port 1433.
- B. Set Session persistence to Client IP.
- C. Set Session persistence to Client IP and protocol.
- D. Enable Floating IP.

Answer: D

Explanation: References:

<https://docs.microsoft.com/en-us/azure/virtual-machines/windows/sql/virtual-machines-windows-portal-sql-alwa>

NEW QUESTION 46

You are developing an ASP.NET web application that you will deploy to Azure. The solution must meet the following requirements:

- Store user session state by using only serializable data types.
- Provide customizable caching of session data.
- Support scaling out the number of web hosts-
- Maximize performance.

Which solution meets these requirements?

- A. Clustered Azure Redis Cache
- B. ASP.NET Output Cache provider for Azure Redis Cache
- C. in-memory session state provider
- D. SQL Server session state provider

Answer: C

NEW QUESTION 50

You are developing a stateful service to deploy to Azure Service Fabric. You plan to implement the RunAsync method.

You need to implement the methods to interface with an instance of the IReliable dictionary interface to increment a count each time the service is called. The first time the service is called, you must initialize the count to 1 if it does not yet exist and then update it by one each time it is called.

Which three methods should you run in sequence? To answer, move the appropriate methods from the list of methods to the answer area and arrange them in the correct order.



Answer:

Explanation:

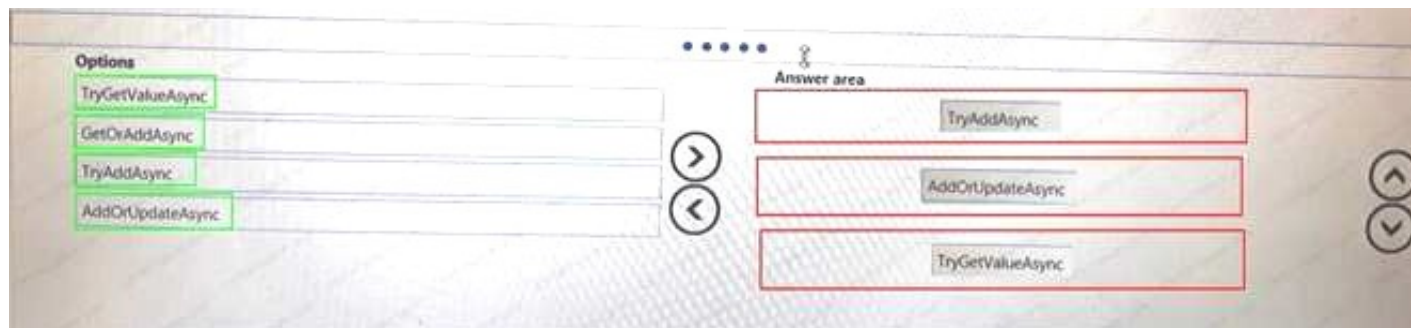

NEW QUESTION 54

You have an on-premises network that contains a Hyper-V host named Host1. Host1 runs Windows Server 2016 and hosts 10 virtual machines that run Windows Server 2016.

You plan to replicate the virtual machines to Azure by using Azure Site Recovery. You create a Recovery Services vault named ASR1 and a Hyper-V site named Site1. You need to add Host1 to ASR1.

What should you do?

- A. Download the installation file for the Azure Site Recovery Provider. Download the storage account key. Install the Azure Site Recovery Provider on each virtual machine and register the virtual machines.
- B. Download the installation file for the Azure Site Recovery Provider. Download the vault registration key. Install the Azure Site Recovery Provider on Host1 and register the server.
- C. Download the installation file for the Azure Site Recovery Provider. Download the storage account key. Install the Azure Site Recovery Provider on Host1 and register the server.
- D. Download the installation file for the Azure Site Recovery Provider. Download the vault registration key. Install the Azure Site Recovery Provider on each virtual machine and register the virtual machines.

Answer: B

Explanation: References:

<https://docs.microsoft.com/en-us/azure/site-recovery/hyper-v-azure-tutorial>

NEW QUESTION 56

You have an Azure Service Bus.

You create a queue named Queue1. Queue1 is configured as shown in the following exhibit.

Name Queue1 ✓

Max queue size 1 GB ✓

Message time to live

Days	Hours	Minutes	Seconds
0	2	0	0

Lock duration

Days	Hours	Minutes	Seconds
0	0	5	0

☐ Enable duplicate detection

☒ Enable dead lettering on message expiration

☐ Enable sessions

☒ Enable partitioning

Use the drop-down menus to select the answer choice that completes each statement based on the information presented in the graphic. NOTE: Each correct selection is worth one point

If a message that has a TTL of four hours is written to Queue1 and is never read, the message will be [answer choice]

If a message that has a TTL of two hours is written to Queue1, and then read after one hour, the message will be [answer choice]

deleted after two hours
deleted after four hours
deleted after two hours and five minutes
retained until manually deleted

deleted immediately
deleted in five minutes
deleted in one hour
retained until manually deleted

Answer:

Explanation:

If a message that has a TTL of four hours is written to Queue1 and is never read, the message will be [answer choice]

If a message that has a TTL of two hours is written to Queue1, and then read after one hour, the message will be [answer choice]

deleted after two hours
deleted after four hours
deleted after two hours and five minutes
retained until manually deleted

deleted immediately
deleted in five minutes
deleted in one hour
retained until manually deleted

NEW QUESTION 57

You maintain an existing Azure SQL Database instance. Management of the database is performed by an external party. All cryptographic keys are stored in an Azure Key Vault.

You must ensure that the external party cannot access the data in the SSN column of the Person table

Will each protection method meet the requirement? To answer, drag the appropriate responses to the correct protection methods. Each response may be used once, more than once, or not at all. You may need to drag the split bar between panes or scroll to view content.

NOTE: Each correct selection is worth one point

Responses

Yes

No

Answer Area

Protection method

Enable AlwaysOn encryption.

Set the column encryption setting to disabled.

Assign users to the Public fixed database role.

Store column encryption keys in the system catalog view in the database.

Response

Response

Response

Response

Answer:

Explanation: References:
<https://docs.microsoft.com/en-us/azure/security/azure-database-security-overview>

NEW QUESTION 61
You have the following resource groups:

Resource group	Comments
DevServer_WestCentralUS	This resource group is located in the West Central US region and contains a single virtual machine (VM) named DevServer. DevServer is connected to a private subnet in an Azure Virtual Network that has no internet access.
Workstation_EastUS	This resource group is located in the East US region and contains a VM named DevWorkstation. DevWorkstation is connected to a subnet in a Virtual Network and is configured with a public IP address. A network security group has been configured to allow public incoming remote desktop protocol (RDP) connections to the DevWorkstation.

Developers must connect to Dev Server only through Dev Workstation. To maintain security, Dev Server must not accept connections from the internet. You need to create a private connection between the Dev Workstation and Dev Server. Dev Workstation using their private IP addresses. Does the solution meet the goal?

A. Yes
B. NO

Answer: A

NEW QUESTION 63
You have an Azure Active Directory (Azure AD) tenant.
You have an existing Azure AD conditional access policy named Policy1. Policy1 enforces the use of Azure AD-joined devices when members of the Global Administrators group authenticate to Azure AD from untrusted locations.
You need to ensure that members of the Global Administrators group will also be forced to use multi-factor authentication when authenticating from untrusted locations.
What should you do?

- A. From the Azure portal, modify session control of Policy1.
B. From multi-factor authentication page, modify the user settings.
C. From multi-factor authentication page, modify the service settings.
D. From the Azure portal, modify grant control of Policy1.

Answer: D

NEW QUESTION 67
You create a virtual machine scale set named Scale1. Scale1 is configured as shown in the following exhibit.

INSTANCES

* Instance count ①

* Instance size (View full pricing details) ①

Deploy as low priority ① ☒ No ☐ Yes

Use managed disks ① ☐ No ☒ Yes

⌵ Show advanced settings

AUTOSCALE

Autoscale ① ☐ Disabled ☒ Enabled

* Minimum number of VMs ①

* Maximum number of VMs ①

Scale out

* CPU threshold (%) ①

* Number of VMs to increase by ①

Scale in

* CPU threshold (%) ①

* Number of VMs to decrease by ①

Use the drop-down menus to select the answer choice that completes each statement based on the information presented in the graphic.
NOTE: Each correct selection is worth one point.

If Scale1 is utilized at 85 percent for six minutes, Scale1 will be running [answer choice].

If Scale1 is first utilized at 25 percent for six minutes, and then utilized at 50 percent for six minutes, Scale1 will be running [answer choice].

Answer:

Explanation:

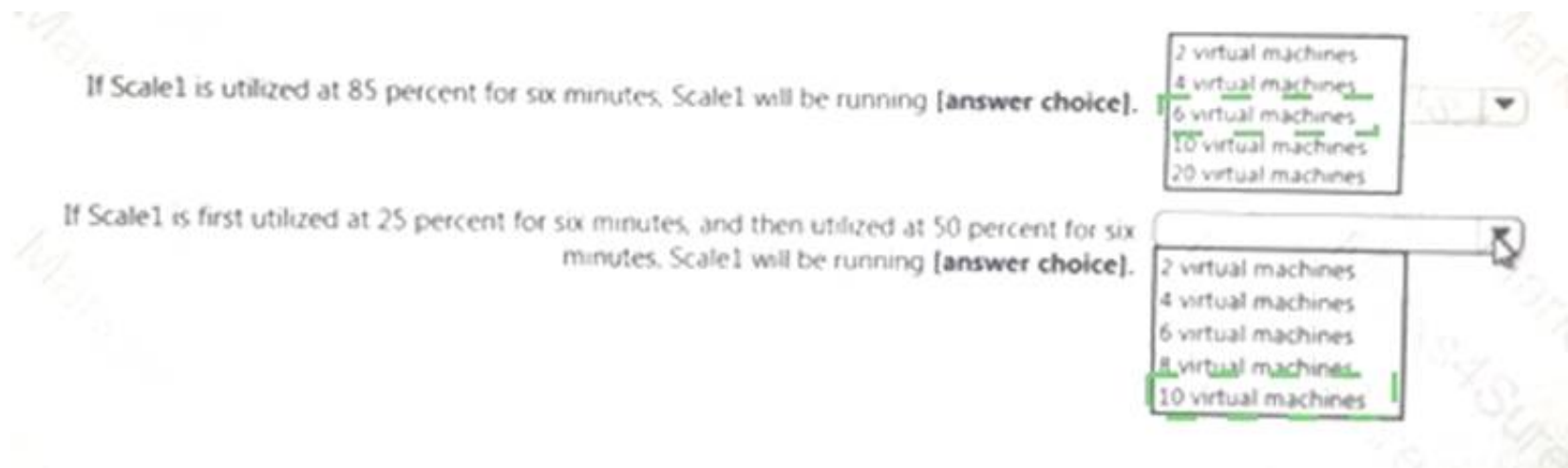

NEW QUESTION 72

You have an Azure Active Directory (Azure AD) tenant named contosodoud.onmicrosoft.com. Your company has a public DNS zone for contoso.com. You add contoso.com as a custom domain name to Azure AD. You need to ensure that Azure can verify the domain name. Which type of DNS record should you create?

- A. PTR
- B. TXT
- C. NSEC3
- D. DNSKEY

Answer: B

NEW QUESTION 73

You have an Azure subscription named Subscription1 that is used by several departments at your company. Subscription1 contains the resources in the following table.

Name	Type
Storage1	Storage account
RG1	Resource group
Container1	Blob container
Share1	File share

Another administrator deploys a virtual machine named VM1 and an Azure Storage account named Storage2 by using a single Azure Resource Manager template. You need to view the template used for the deployment. From which blade can you view the template that was used for the deployment?

- A. Contained
- B. VM1
- C. Storage2
- D. RG1

Answer: D

NEW QUESTION 78

From the MFA Server blade, you open the Block/unblock users blade as shown in the exhibit.

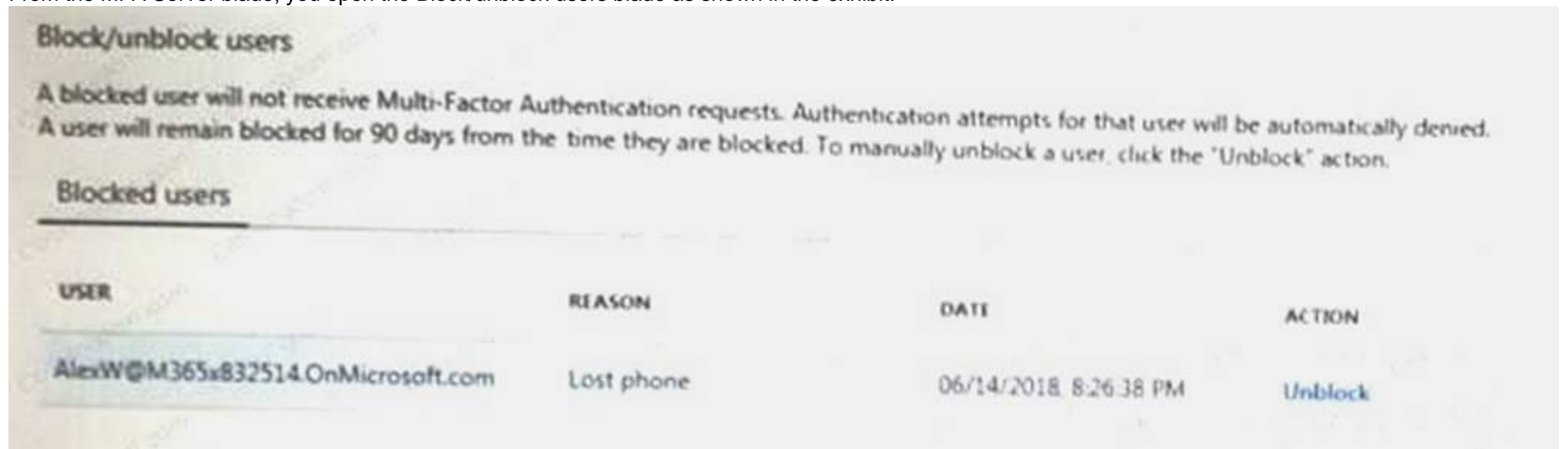

What caused AlexW to be blocked?

- A. The user account password expired.
- B. The user reported a fraud alert when prompted for additional authentication.
- C. An administrator manually blocked the user.
- D. The user entered an incorrect PIN four times within 10 minutes.

Answer: C

NEW QUESTION 80

You have the following resource groups:

Resource group	Comments
DevServer_WestCentralUS	This resource group is located in the West Central US region and contains a single virtual machine (VM) named DevServer. DevServer is connected to a private subnet in an Azure Virtual Network that has no internet access.
Workstation_EastUS	This resource group is located in the East US region and contains a VM named DevWorkstation. DevWorkstation is connected to a subnet in a Virtual Network and is configured with a public IP address. A network security group has been configured to allow public incoming remote desktop protocol (RDP) connections to the DevWorkstation.

Developers must connect to Dev Server only through Dev Workstation. To maintain security, DevS erver must not accept connections from the internet. You need to create a private connection between the Dev Workstation and Dev St Solution: Configure an IP address on each subnet within the same address space. Does the solution meet the goal?

- A. Yes
- B. NO

Answer: B

NEW QUESTION 82

You have an Azure subscription.

You have an on-premises virtual machine named VM1. The settings for VM1 are shown in the exhibit. (Click the Exhibit tab.)

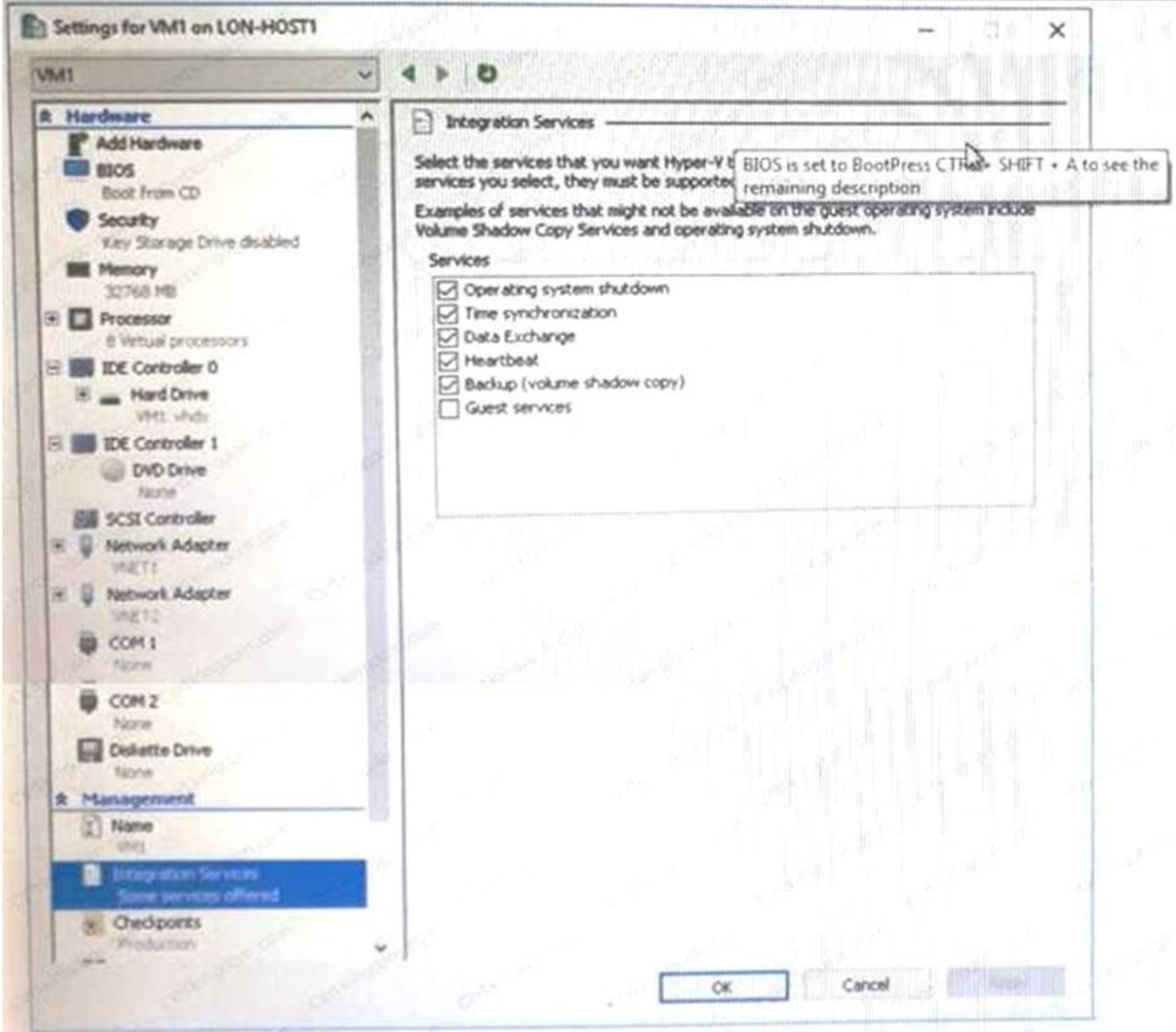

You need to ensure that you can use the disks attached to VM1 as a template for Azure virtual machines. What should you modify on VM1?

- A. the hard drive
- B. Integration Services
- C. the memory
- D. the network adapters

E. the processor

Answer: C

NEW QUESTION 87

You are creating a collaborative image hosting platform as an ASP.NET MVC web application. Users add, update, and modify images on the platform. Images are stored in Azure Blob storage.

More than one user at a time must be able to modify the same image. You need to implement optimistic concurrency for uploading images.

Which four actions should you perform in sequence? To answer, move the appropriate actions from the list of actions to the answer area and arrange them in the correct order.

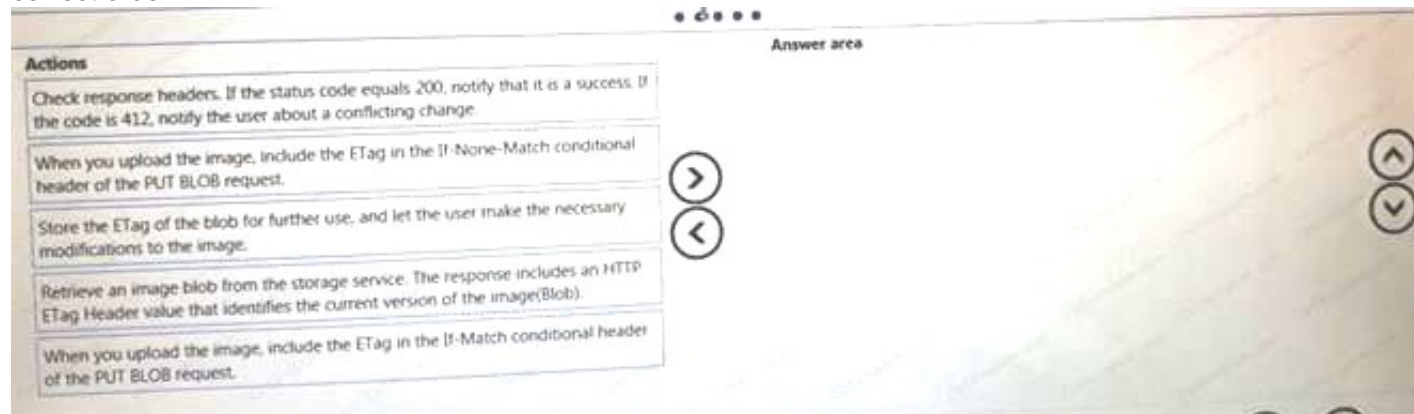

Answer:

Explanation:

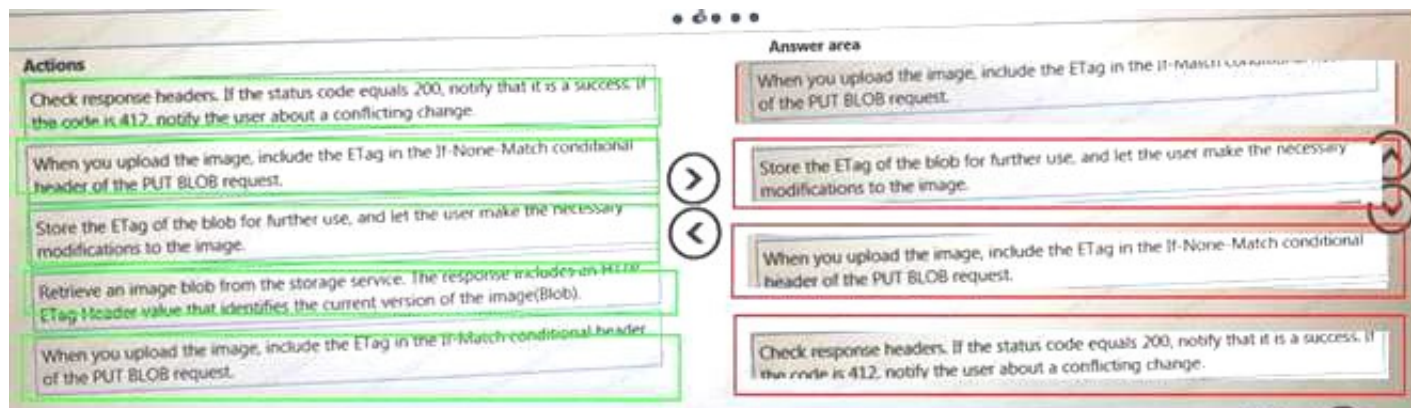

NEW QUESTION 88

You are creating an IoT solution using Azure Time Series Insights.

You configure the environment to ensure that all data for the current year is available. What should you do?

- A. Add a disaster recovery (DR) strategy.
- B. Set a value for the Data retention time setting.
- C. Change the pricing tier.
- D. Create a reference data set.

Answer: D

NEW QUESTION 93

You have an Azure subscription named Subscription1. Subscription1 contains the virtual networks in the following table:

Name	Address space	Subnet name	Subnet address range
VNet1	10.1.0.0/16	Subnet1	10.1.1.0/24
VNet2	10.10.0.0/16	Subnet2	10.10.1.0/24
VNet3	172.16.0.0/16	Subnet3	172.16.1.0/24

Subscription1 contains the virtual machines in the following table:

Name	Network	Subnet	IP address
VM1	VNet1	Subnet1	10.1.1.4
VM2	VNet2	Subnet2	10.10.1.4
VM3	VNet3	Subnet3	172.16.1.4

The firewalls on all the virtual machines are configured to allow all ICMP traffic. You add the peerings in the following table:

Virtual network	Peering network
VNet1	VNet3
VNet2	VNet3
VNet3	VNet1

For each of the following statements, select Yes if the statement is true. Otherwise, select No. NOTE: Each correct selection is worth one point.

Statements	Yes	No
VM1 can ping VM3.	<input type="checkbox"/>	<input type="checkbox"/>
VM2 can ping VM3.	<input type="checkbox"/>	<input type="checkbox"/>
VM2 can ping VM1.	<input type="checkbox"/>	<input type="checkbox"/>

Answer:

Explanation: References:

<https://docs.microsoft.com/en-us/azure/virtual-network/tutorial-connect-virtual-networks-portal>

NEW QUESTION 97

You plan to create a Docker image that runs an ASP.NET Core application named ContosoApp. You have a setup script named setupScript.ps1 and a series of application files including ContosoApp.dll.

You need to create a Dockerfile document that meets the following requirements:

Call setupScript.ps1 when the container is built.

Run ContosoApp.dll when the container starts.

The Dockerfile document must be created in the same folder where ContosoApp.dll and setupScript.ps1 are stored.

Which four commands should you use to develop the solution? To answer, move the appropriate commands from the list of commands to the answer area and arrange them in the correct order.

Commands

Answer Area

```
RUN powershell ./setupScript.ps1  
CMD ["dotnet", "ContosoApp.dll"]
```

```
FROM microsoft/aspnetcore:2.0
```

```
CMD powershell ./setupScript.ps1  
ENTRYPOINT ["dotnet",  
"ContosoApp.dll"]
```

```
WORKDIR /apps/ContosoApp
```

```
EXPOSE ./ContosoApp/ /apps/ContosoApp
```

```
COPY ./.
```

Answer:

Explanation:

Commands	Answer Area
RUN powershell ./setupScript.ps1 CMD ["dotnet", "ContosoApp.dll"]	FROM microsoft/aspnetcore:2.0
FROM microsoft/aspnetcore:2.0	WORKDIR /apps/ContosoApp
CMD powershell ./setupScript.ps1 ENTRYPOINT ["dotnet", "ContosoApp.dll"]	COPY ./.
WORKDIR /apps/ContosoApp	RUN powershell ./setupScript.ps1 CMD ["dotnet", "ContosoApp.dll"]
EXPOSE ./ContosoApp/ /apps/ContosoApp	
COPY ./.	

NEW QUESTION 102

You are developing an Azure Function that will be triggered using a webhook from an external application. The Azure Function will receive JSON data in the body of the request.

Calling applications send an account ID as part of the URL. The number at the end of the URL is an integer. The format for the URL resembles the following:
/api/account/1

The Azure Function must accept all incoming requests without requiring keys or tokens. You need to complete the attributes for the Azure Function.

How should you complete the code? To answer, select the appropriate options in the answer area. NOTE: Each correct selection is worth one point.

```
[
    {
        FunctionName
        RouteAttribute
        QueueTrigger
        HttpTrigger
    }
] ("ProcessItem")

public static async Task<HttpResponseMessage> Run(

[
    {
        BlobTrigger
        FileTrigger
        QueueTrigger
        HttpTrigger
    }
    (AuthorizationLevel.
    {
        Anonymous
        Admin
        User
        Function
    }
    , "post",

Route = "
    {
        /api/account/1
        ProcessItem/{accountId:int}
        account/{accountId:int}
        /account/
    }
    ") ]HttpRequestMessage req,

    {
        string accountId
        int accountId
        [FromBody] string accountId
        int account
    }
    , TraceWriter log)

{
    Item itemToProcess = await req.Content.ReadAsAsync<Item>();
    log.Info($"Processing item {itemToProcess.Id} for account {accountId}");
    var processedItem = DoItemProcessing(itemToProcess);
    return req.CreateResponse(HttpStatusCode.OK, processedItem);
}
```

Answer:

Explanation:

```
[
    {
        FunctionName
        RouteAttribute
        QueueTrigger
        HttpTrigger
    }
] ("ProcessItem")

public static async Task<HttpResponseMessage> Run(

[
    {
        BlobTrigger
        FileTrigger
        QueueTrigger
        HttpTrigger
    }
    (AuthorizationLevel.
    {
        Anonymous
        Admin
        User
        Function
    }
    , "post",

Route = "
    {
        /api/account/1
        ProcessItem/{accountId:int}
        account/{accountId:int}
        /account/
    }
    ") ]HttpRequestMessage req,

    {
        string accountId
        int accountId
        [FromBody] string accountId
        int account
    }
    , TraceWriter log)

{
    Item itemToProcess = await req.Content.ReadAsAsync<Item>();
    log.Info($"Processing item {itemToProcess.Id} for account {accountId}");
    var processedItem = DoItemProcessing(itemToProcess);
    return req.CreateResponse(HttpStatusCode.OK, processedItem);
}
```

NEW QUESTION 106

You have an Azure subscription named Subscription1 that contains a virtual network named VNet1. VNet1 is in a resource group named RG1. Subscription1 has a user named User1. User1 has the following roles:

- Reader
- Security Admin
- Security Reader

You need to ensure that User1 can assign the Reader role for VNet1 to other users. What should you do?

- A. Assign User1 the Owner role for VNet1.
- B. Assign User1 the Network Contributor role for VNet1.
- C. Remove User1 from the Security Reader and Reader roles for Subscription1. Assign User1 the Contributor role for Subscription1.
- D. Remove User1 from the Security Reader and Reader roles for Subscription1.

Answer: A

NEW QUESTION 108

You have an Azure subscription.

You have 100 Azure virtual machines.

You need to quickly identify underutilized virtual machines that can have their changed to a less expensive offering.

Which Wade should you use?

- A. Metrics
- B. Monitor
- C. Customer insights
- D. Advisor

Answer: B

NEW QUESTION 113

You are developing an internal website for employee to view sensitive data. The website uses Azure Directory (AAD) for authentication.

You need to implement multifactor authentication for the website. What should you do? Each correct answer presents part of the solution. NOTE: Each connect selection is worth one point.

- A. Upgrade to Azure AD premium.
- B. In Azure ACL enable application pages.
- C. Configuration the website to user Azure AD BDC.
- D. In Azure AD conditional access enable the baseline policy.
- E. In Azure AD create a new conditional access policy.

Answer: CE

NEW QUESTION 117

You have an on-premises network that includes a Microsoft SQL Server instance named SQL1. You create an Azure Logic App named App1.

You need to ensure that App1 can query a database on SQL1.

Which three actions should you perform in sequence? To answer, move the appropriate actions from the list of actions to the answer area and arrange them in the correct order.

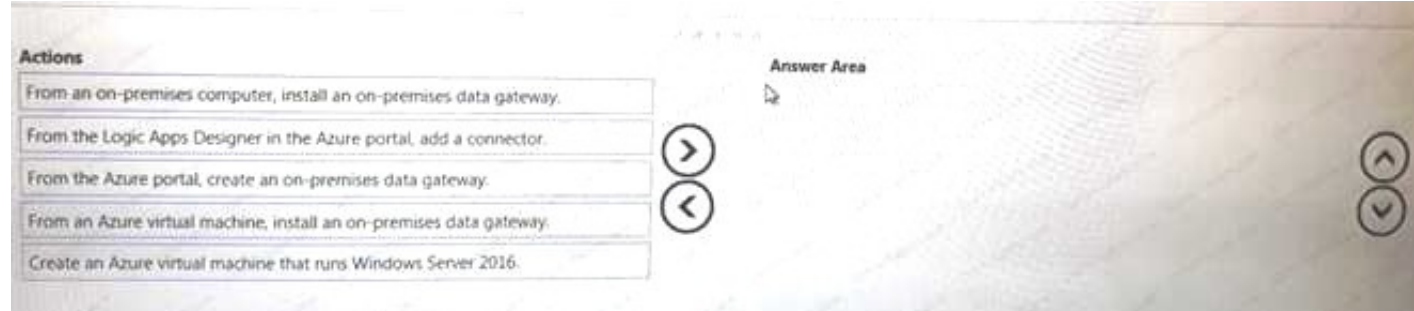

Answer:

Explanation:

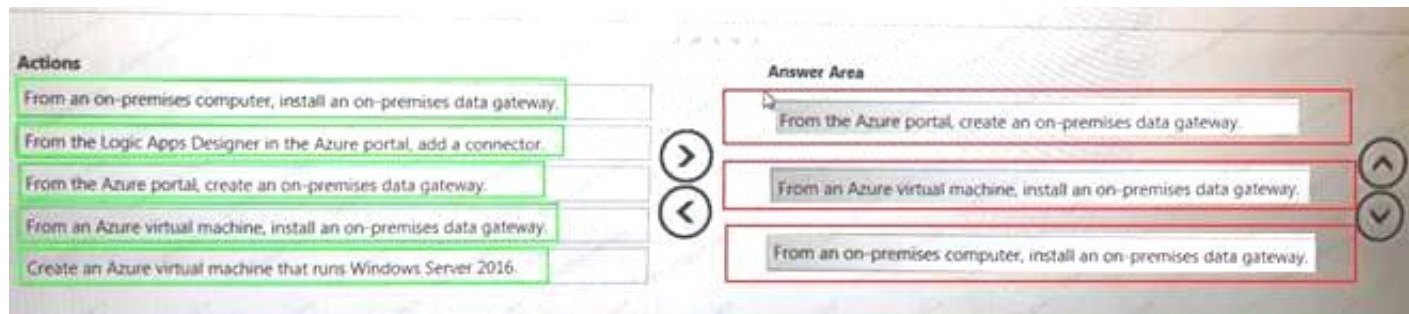

NEW QUESTION 120

You have several Azure virtual machines on a virtual network named VNet1. You configure an Azure Storage account as shown in the following exhibit

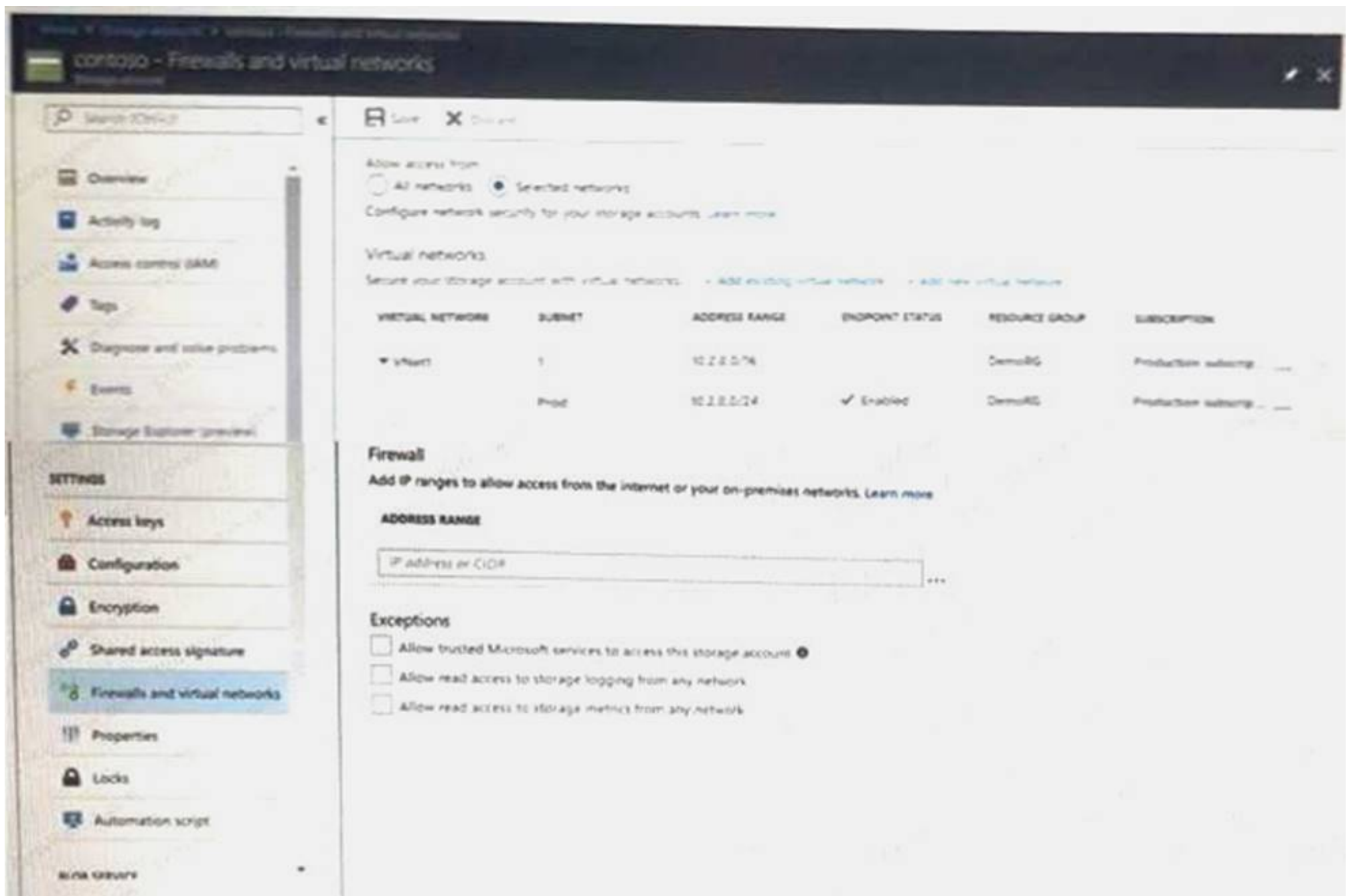

Use the drop-down menus to select the answer choice that completes each statement based on the information presented in the graphic. NOTE: Each correct selection is worth one point



Answer:

Explanation:



NEW QUESTION 121

You need to debug the user greeting issue. What should you use?

- A. Azure Application Insights
- B. Bot Framework Emulator
- C. Bot Framework Channel Inspector
- D. Bot Connector service
- E. Azure Compute Emulator

Answer: A

NEW QUESTION 124

You need to resolve the language processing issue.

Which three actions should you perform in sequence? To answer, move the appropriate actions from the list of actions to the answer area and arrange them on the correct order.

Actions

Answer Area

Publish the LUIS app.

Add new utterances and entities.

Add new intents.

Create a new LUIS app.

Train the LUIS app.

Add names for Italian cuisine to
Azure Search.

Add the Azure Search provider to the bot.

Answer:

Explanation:

Actions

Publish the LUIS app.

Add new utterances and entities.

Add new intents.

Create a new LUIS app.

Train the LUIS app.

Add names for Italian cuisine to Azure Search.

Add the Azure Search provider to the bot.

Answer Area

Create a new LUIS app.

Train the LUIS app.

Publish the LUIS app.

NEW QUESTION 127

You need to resolve the delivery API error. What should you do?

- A. Implement simple retry by using the EnableRetryOnFailure feature of Entity Framework.
- B. Implement exponential backoff by using the EnableRetryOnFailure feature of Entity Framework.
- C. Implement a Circuit Breaker pattern by using the EnableRetryOnFailure feature of Entity Framework.
- D. Invoke a custom execution strategy in Entity Framework.

Answer: B

Explanation: References:

<https://docs.microsoft.com/en-us/azure/sql-database/sql-database-develop-error-messages>

NEW QUESTION 131

You need to implement the purchase requirement. What should you do?

- A. Use the Bot Framework REST API conversation operations to send the user's voice and the Speech Service API to recognize intents.
- B. Use the Direct Line REST API to send the user's voice and the Speech Service API to recognize intents.
- C. Use the Speech Service API to send the user's voice and the Bot Framework REST API conversation operations to recognize intents.
- D. Use the Bot Framework REST API attachment operations to send the user's voice and the Speech Service API to recognize intents.

Answer: A

NEW QUESTION 136

Note: This question is part of a series of questions that present the same scenario. Each question in the series contains a unique solution. Determine whether the solution meets the stated goals.

You need to meet the vendor notification requirement.

Solution: Configure notifications in the Azure API Management instance. Does the solution meet the goal?

- A. Yes
- B. No

Answer: A

Explanation: References:

<https://docs.microsoft.com/en-us/azure/api-management/api-management-howto-configure-notifications>

NEW QUESTION 138

You need to meet the security requirements. What should you use?

- A. HTTP Strict Transport Security (HSTS)
- B. Direct Line API
- C. Multi-Factor Authentication (MFA)
- D. Bot Framework Portal
- E. Bot Framework authentication

Answer: E

NEW QUESTION 142

.....

Thank You for Trying Our Product

* 100% Pass or Money Back

All our products come with a 90-day Money Back Guarantee.

* One year free update

You can enjoy free update one year. 24x7 online support.

* Trusted by Millions

We currently serve more than 30,000,000 customers.

* Shop Securely

All transactions are protected by VeriSign!

100% Pass Your AZ-300 Exam with Our Prep Materials Via below:

<https://www.certleader.com/AZ-300-dumps.html>