

AZ-300 Dumps

Microsoft Azure Architect Technologies

<https://www.certleader.com/AZ-300-dumps.html>



NEW QUESTION 1

- (Exam Topic 1)

You need to access user claims in the e-commerce web app. What should you do first?

- A. Write custom code to make a Microsoft Graph API call from the e commerce web app.
- B. Assign the Contributor RBAC role to the e-commerce web app by using the Resource Manager create role assignment API
- C. Update the e-commerce web app to read the HTTP request header values.
- D. Using the Azure CU, enable Cross-origin resource sharing (CORS) from the e-commerce checkout API to the e-commerce web

Answer: A

NEW QUESTION 2

- (Exam Topic 3)

You need to meet the technical requirement for VM4. What should you create and configure?

- A. an Azure Event Hub
- B. an Azure Notification Hub
- C. an Azure Logic App
- D. an Azure Service Bus

Answer: C

NEW QUESTION 3

- (Exam Topic 5)

You are developing a web app that uses a REST interface to connect to Azure Storage with HTTPS. This app uploads and streams video content that can be accessed from anywhere in the world.

You have different storage requirements for each part of the app. A hierarchical namespace must be created. Which storage services should you implement? To answer, select the appropriate services to the correct

actions. Each service may be used once, more than once, or not at all. You may need to drag the split bar between panes or scroll to view content.

NOTE: Each correct selection is worth one point.

Storage services	Answer Area	
	Action	Storage service
Azure Blobs	Stream video content.	
Azure Table Storage	Perform random read/write operations.	
Azure HDInsight	Access application data from anywhere.	

- A. Mastered
- B. Not Mastered

Answer: A

Explanation:

Storage services		Answer Area	
		Action	Storage service
Azure Blobs		Stream video content.	Azure Blobs
Azure Table Storage		Perform random read/write operations.	Azure Blobs
Azure HDInsight		Access application data from anywhere.	Azure Blobs

NEW QUESTION 4

- (Exam Topic 5)

You have an on-premises network that you plan to connect to Azure by using a site-to-site VPN.

In Azure, you have an Azure virtual network named VNet1 that uses an address space of 10.0.0.0/16. VNet1 contains a subnet named Subnet1 that uses an address space of 10.0.0.0/24.

You need to create a site-to-site VPN to Azure.

Which four actions should you perform in sequence? To answer, move the appropriate actions from the list of actions to the answer area and arrange them in the correct order.

NOTE: More than one order of answer choices is correct. You will receive credit for any of the correct orders you select.

Actions	Answer Area
Create a gateway subnet.	
Create a custom DNS server.	
Create a local gateway.	
Create an Azure Content Delivery Network (CDN) profile.	
Create a VPN gateway.	
Create a VPN connection.	

- A. Mastered
- B. Not Mastered

Answer: A

Explanation:

Actions

Create a gateway subnet.

Create a custom DNS server.

Create a local gateway.

Create an Azure Content
Delivery Network (CDN) profile.

Create a VPN gateway.

Create a VPN connection.

Answer Area

Create a gateway subnet.

Create a VPN gateway.

Create a local gateway.

Create a VPN connection.

NEW QUESTION 5

- (Exam Topic 5)

You are developing a SMS-based testing solution. The solution sends users a question by using SMS. Early responders may qualify for prizes.

Users must respond with an answer choice within 90 seconds. You must be able to track how long it takes each user to respond. You create a durable Azure Function named SendSmsQuizQuestion that uses Twilio to send messages.

You need to write the code for MessageQuiz.

How should you complete the code? To answer, select the appropriate options in the answer area. NOTE: Each correct selection is worth one point.

```
[FunctionName("MessageQuiz")]
public static async Task<bool> Run([OrchestrationTrigger]
DurableOrchestrationContext context)
{
    string phoneNumber = context.GetInput<string>();
    int correctAnswerCode = await context.CallActivityAsync<int>
("SendSmsQuizQuestion", phoneNumber);
    using (var cts = new CancellationTokenSource())
    {
```

DateTime expiration = DateTime.UtcNow;
DateTime expiration = DateTime.UtcNow.AddSeconds(90);
DateTime expiration = DateTime.Now();
DateTime expiration = context.CurrentUtcDateTime.AddSeconds(90);

var timeoutTask = context.CallActivityAsync<DateTime>("timeout", expiration);
var timeoutTask = context.CreateTimer(expiration, cts.Token);
var timeoutTask = context.WaitForExternalEvent("timeout", 90000);
var timeoutTask = context.CallSubOrchestratorAsync("timeout", expiration);

```
bool isWinner = false;
for (int retryCount = 0; retryCount <= 3; retryCount++)
{
    Task<int> challengeResponseTask =
context.WaitForExternalEvent<int>("SmsQuizResponse");
    Task winner = await Task.WhenAny(challengeResponseTask,
timeoutTask);
    if (winner == challengeResponseTask)
    {
        if(challengeResponseTask.Result == correctAnswerCode)
        {
            isWinner = true;
            break;
        }
    }
    else
    {
        break;
    }
}
```

if (!timeoutTask.IsCompleted)
if (!timeoutTask.IsCanceled)
if (!context.IsReplaying)
if (!cts.IsCancellationRequested)

```
{
    cts.Cancel();
}
return isWinner;
}
```

- A. Mastered
- B. Not Mastered

Answer: A

Explanation:

```
[FunctionName("MessageQuiz")]
public static async Task<bool> Run([OrchestrationTrigger]
DurableOrchestrationContext context)
{
    string phoneNumber = context.GetInput<string>();
    int correctAnswerCode = await context.CallActivityAsync<int>
("SendSmsQuizQuestion", phoneNumber);
    using (var cts = new CancellationTokenSource())
    {
        DateTime expiration = DateTime.UtcNow;
        DateTime expiration = DateTime.UtcNow.AddSeconds(90);
        DateTime expiration = DateTime.Now();
        DateTime expiration = context.CurrentUtcDateTime.AddSeconds(90);

        var timeoutTask = context.CallActivityAsync<DateTime>("timeout", expiration);
        var timeoutTask = context.CreateTimer(expiration, cts.Token);
        var timeoutTask = context.WaitForExternalEvent("timeout", 90000);
        var timeoutTask = context.CallSubOrchestratorAsync("timeout", expiration);

        bool isWinner = false;
        for (int retryCount = 0; retryCount <= 3; retryCount++)
        {
            Task<int> challengeResponseTask =
            context.WaitForExternalEvent<int>("SmsQuizResponse");
            Task winner = await Task.WhenAny(challengeResponseTask,
            timeoutTask);
            if (winner == challengeResponseTask)
            {
                if(challengeResponseTask.Result == correctAnswerCode)
                {
                    isWinner = true;
                    break;
                }
            }
            else
            {
                break;
            }
        }

        if (!timeoutTask.IsCompleted)
        if (!timeoutTask.IsCanceled)
        if (!context.IsReplaying)
        if (!cts.IsCancellationRequested)
        {
            cts.Cancel();
        }
        return isWinner;
    }
}
```

NEW QUESTION 6

- (Exam Topic 5)

You are developing a Docker/Go using Azure App Service Web App for Containers. You plan to run the container in an App Service on Linux. You identify a Docker container image to use.

None of your current resource groups reside in a location that supports Linux. You must minimize the number of resource groups. You need to create the application and perform an initial deployment required.

Which three Azure CLI commands should you use to develop the solution? To answer, move the appropriate commands from the list of commands to the answer area and arrange them in the correct order.

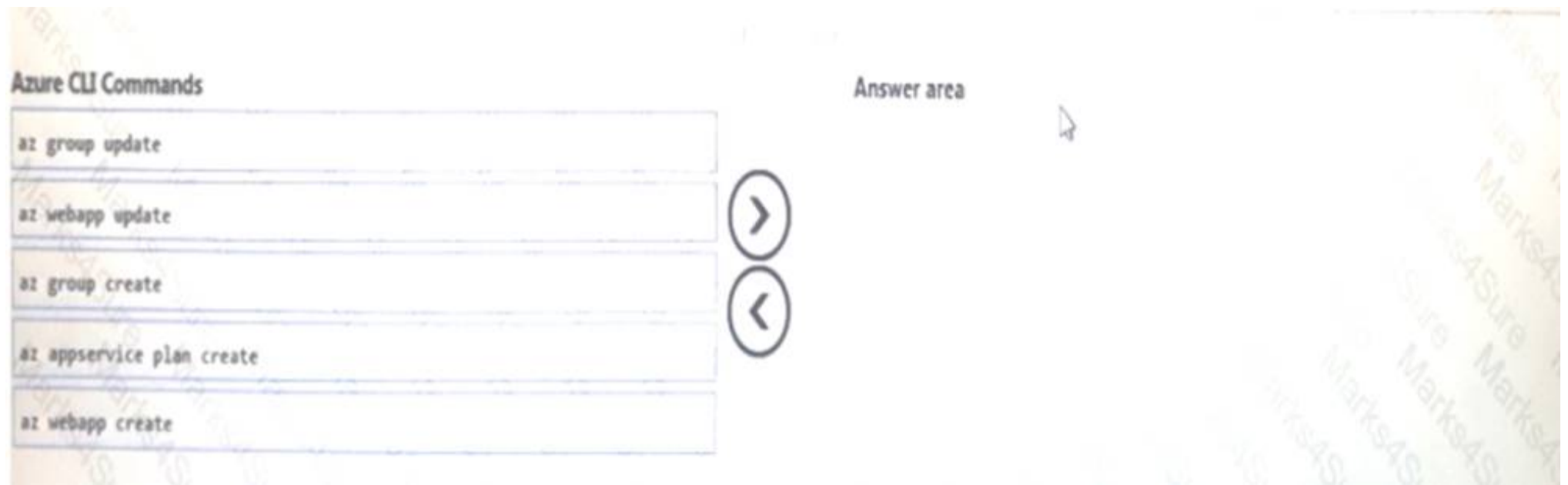

- A. Mastered
- B. Not Mastered

Answer: A

Explanation:

az group create
az appservice plan create az webapp create

NEW QUESTION 7

- (Exam Topic 5)

You have an Azure App Service API that allows users to upload documents to the cloud with a mobile device. A mobile app connects to the service by using REST API calls.

When a new document is uploaded to the service, the service extracts the document metadata. Usage statistics for the app show significant increases in app usage.

The extraction process is CPU-intensive. You plan to modify the API to use a queue.

You need to ensure that the solution scales, handles request spikes, and reduces costs between request spikes. What should you do?

- A. Configure a CPU Optimized virtual machine (VM) and install the Web App service on the new instance.
- B. Configure a series of CPU Optimized virtual machine (VM) instances and install extraction logic to process a queue.
- C. Move the extraction logic into an Azure Function
- D. Create a queue triggered function to process the queue.
- E. Configure Azure Container Service to retrieve items from a queue and run across a pool of virtual machine (VM) nodes using the extraction logic.

Answer: C

NEW QUESTION 8

- (Exam Topic 5)

You have an Azure subscription named Subscription1 that contains an Azure virtual machine named VM1. VM1 is in a resource group named RG1. VM1 runs services that will be used to deploy resources to RG1.

You need to ensure that a service running on VM1 can manage the resources in RG1 by using the identity of VM1.

What should you do first?

- A. From the Azure portal, modify the Access control (IAM) settings of RG1.
- B. From the Azure portal, modify the Policies settings of RG1.
- C. From the Azure portal, modify the Access control (IAM) settings of VM1.
- D. From the Azure portal, modify the value of the Managed Service Identity option for VM1.

Answer: D

Explanation:

References:

<https://docs.microsoft.com/en-us/azure/active-directory/managed-identities-azure-resources/overview>

NEW QUESTION 9

- (Exam Topic 5)

You have an Azure Storage accounts as shown in the following exhibit.

Storage accounts

Contoso

+ Add

≡ Edit columns

↺ Refresh

◆ Assign Tags

🗑 Delete

Subscriptions: All 2 selected = Don't see a subscription? Switch directories

*Filter by name

All subscriptions ▾



All resource groups ▾

All types ▾

All locations ▾

No grouping ▾

3 items

<input type="checkbox"/>	NAME ↑	TYPE	KIND	RESOURCE...	LOCATION	SYBSCRIPTI..	ACCESS T...	REPLICAT..
<input type="checkbox"/>	 storageaccount1	Storage account	Storage	ContosoRG1	East US	Subscription 1	-	Read-access ge..
<input type="checkbox"/>	 storageaccount2	Storage account	StorageV2	ContosoRG1	Central US	Subscription 1	Hot	Geo-redundant
<input type="checkbox"/>	 storageaccount3	Storage account	BlobStorage	ContosoRG1	East US	Subscription 1	Hot	Locally-redund

Use the drop-down menus to select the answer choice that completes each statement based on the information presented in the graphic.
NOTE: Each correct selection is worth one point.

You can use [answer choice] for Azure Table Storage.

storageaccount1 only

storageaccount2 only

storageaccount3 only

storageaccount1 and storageaccount2 only

storageaccount2 and storageaccount3 only

You can use [answer choice] for Azure Blob Storage.

storageaccount3 only

storageaccount2 and storageaccount3 only

storageaccount1 and storageaccount3 only

all the storage accounts

- A. Mastered
- B. Not Mastered

Answer: A

Explanation:

References:

https://docs.microsoft.com/en-us/azure/storage/common/storage-account-overview

NEW QUESTION 10

- (Exam Topic 5)

You develop a web app that uses the tier 1)1 app service plan by using the Web Apps feature ol Microsoft Azure App Service. Spikes in traffic have caused increases in page load times. You need to ensure that the web app automatically scales when CPU load is about 85 percent and minimize costs. Which four actions should you perform in sequence? To answer, move the appropriate actions from the list of actions to the answer area and arrange them in the correct order.



- A. Mastered

B. Not Mastered

Answer: A

Explanation:



NEW QUESTION 10

- (Exam Topic 5)

Note: This question is part of series of questions that present the same scenario. Each question in the series contains a unique solution that might meet the stated goals. Some question sets might have more than one correct solution, while others might not have a correct solution.

After you answer a question in this section, you will NOT be able to return to it. As a result, these questions will not appear in the review screen.

A company backs up data to on-premises servers at their main facility. The company currently has 30 TB of archived data that infrequently used. The facility has download speeds of 100 Mbps and upload speeds of 20 Mbps.

You need to securely transfer all backups to Azure Blob Storage for long-term archival. All backup data must be sent within seven days.

Solution: Backup data to local disks and use the Azure Import/Export service to send backups to Azure Blob Storage.

Does this meet the goal?

A. Yes

B. No

Answer: A

NEW QUESTION 14

- (Exam Topic 5)

Note: This question is part of series of questions that present the same scenario. Each question in the series contains a unique solution that might meet the stated goals. Some question sets might have more than one correct solution, while others might not have a correct solution.

After you answer a question in this section, you will NOT be able to return to it. As a result, these questions will not appear in the review screen.

A company backs up data to on-premises servers at their main facility. The company currently has 30 TB of archived data that infrequently used. The facility has download speeds of 100 Mbps and upload speeds of 20 Mbps.

You need to securely transfer all backups to Azure Blob Storage for long-term archival. All backup data must be sent within seven days.

Solution: Create a file share in Azure Files. Mount the file share to the server and upload the files to the file share. Transfer the files to Azure Blob Storage.

Does this meet the goal?

A. Yes

B. No

Answer: B

NEW QUESTION 16

- (Exam Topic 5)

You download an Azure Resource Manager template based on an existing virtual machine. The template will be used to deploy 100 virtual machines.

You need to modify the template to reference an administrative password. You must prevent the password from being stored in plain text.

What should you create to store the password?

A. an Azure Key Vault and an access policy.

B. an Azure Storage account and an access policy.

C. Azure Active Directory (AD) Identity Protection and an Azure policy.

D. a Recovery Services vault and a backup policy.

Answer: A

NEW QUESTION 20

- (Exam Topic 5)

Note: This question is part of series of questions that present the same scenario. Each question in the series contains a unique solution that might meet the stated goals. Some question sets might have more than one correct solution, while others might not have a correct solution.

After you answer a question in this section, you will NOT be able to return to it. As a result, these questions will not appear in the review screen.

A company backs up data to on-premises servers at their main facility. The company currently has 30 TB of archived data that infrequently used. The facility has download speeds of 100 Mbps and upload speeds of 20 Mbps.

You need to securely transfer all backups to Azure Blob Storage for long-term archival. All backup data must be sent within seven days.

Solution: Use the Set-AzureStorageBlobContent Azure PowerShell command to copy all backups asynchronously to Azure Blob Storage.

Does this meet the goal?

A. Yes

B. No

Answer: B

NEW QUESTION 25

- (Exam Topic 5)

You have an Active Directory forest named contoso.com.

You install and configure AD Connect to use password hash synchronization as the single sign-on(SSO) method. Staging mode is enabled.

You review the synchronization results and discover that the Synchronization Service Manager does not display any sync jobs.

You need to ensure that the synchronization completes successfully.

What should you do?

- A. From Azure PowerShell, run Start-AdSyncSyncCycle –PolicyType Initial.
- B. Run Azure AD Connect and set the SSO method to Pass-through Authentication.
- C. From Synchronization Service Manager, run a full import.
- D. Run Azure AD Connect and disable staging mode.

Answer: D

Explanation:

References:

<https://docs.microsoft.com/en-us/azure/active-directory/hybrid/how-to-connect-sync-operations>

NEW QUESTION 26

- (Exam Topic 5)

You have an Azure subscription named Subscription1. Subscription1 contains the virtual machines in the following table.

Name	IP address
VM1	10.0.1.4
VM2	10.0.2.4
VM3	10.0.3.4

Subscription1 contains a virtual network VNet1 that has the subnets in the following table.

Name	Address space	Connected virtual machine
Subnet1	10.0.1.0/24	VM1
Subnet2	10.0.2.0/24	VM2
Subnet3	10.0.3.0/24	VM3

VM3 has multiple network adapters, including a network adapter named N1C3. IP forwarding is enabled on NIC3. Routing is enabled on VM3. You create a route table named RT1. RT1 is associated to Subnet1 and Subnet2 and contains the routes in the following table.

Address prefix	Next hop type	Next hop address
10.0.1.0/24	Virtual appliance	10.0.3.4
10.0.2.0/24	Virtual appliance	10.0.3.4

You apply RT1 to Subnet1

For each of the following statements, select Yes if the statement is true. Otherwise, select No. NOTE: Each correct selection is worth one point.

Statements	Yes	No
Network traffic from VM3 can reach VM1.	<input type="radio"/>	<input type="radio"/>
If VM3 is turned off, network traffic from VM2 can reach VM1.	<input type="radio"/>	<input type="radio"/>
Network traffic from VM1 can reach VM2.	<input type="radio"/>	<input type="radio"/>

- A. Mastered
- B. Not Mastered

Answer: A

Explanation:

Statements	Yes	No
Network traffic from VM3 can reach VM1.	<input checked="" type="radio"/>	<input type="radio"/>
If VM3 is turned off, network traffic from VM2 can reach VM1.	<input type="radio"/>	<input checked="" type="radio"/>
Network traffic from VM1 can reach VM2.	<input type="radio"/>	<input checked="" type="radio"/>

NEW QUESTION 30

- (Exam Topic 5)

Your company has offices in New York and Los Angeles.
You have an Azure subscription that contains an Azure virtual network named VNet1. Each office has a site-to-site VPN connection to VNet1.
Each network uses the address spaces shown in the following table:

Location	IP address space
VNet1	192.168.0.0/20
New York	10.0.0.0/16
Los Angeles	10.10.0.0/16

You need to ensure that all Internet-bound traffic from VNet1 is routed through the New York office. What should you do? To answer, select the appropriate options in the answer area.
NOTE: Each correct selection is worth one point.

In Azure, run:

V

New-AzureRmLocalNetworkGateway

New-AzureRmVirtualNetworkGatewayConnection

Set-AzureRmVirtualNetworkGatewayDefaultSite

On a VPN device in the New York office, set the traffic selectors to:

V

0.0.0.0/0

10.0.0.0/16

192.168.0.0/20

- A. Mastered
- B. Not Mastered

Answer: A

Explanation:

In Azure, run:

V

New-AzureRmLocalNetworkGateway

New-AzureRmVirtualNetworkGatewayConnection

Set-AzureRmVirtualNetworkGatewayDefaultSite

On a VPN device in the New York office, set the traffic selectors to:

V

0.0.0.0/0

10.0.0.0/16

192.168.0.0/20

NEW QUESTION 31

- (Exam Topic 5)
You have an Azure Active Directory (Azure AD) tenant that has the initial domain name. You have a domain name of contoso.com registered at a third-party registrar.
You need to ensure that you can create Azure AD users that have names containing a suffix of @contoso.com. Which three actions should you perform in sequence? To answer, move the appropriate cmdlets from the list of cmdlets to the answer area and arrange them in the correct order.

Actions	Answer Area
Add an Azure AD tenant.	
Create an Azure DNS zone.	
Verify the domain.	
Configure company branding.	
Add a record to the public contoso.com DNS zone.	
Add a custom domain name.	

- A. Mastered
- B. Not Mastered

Answer: A

Explanation:

References:

<https://docs.microsoft.com/en-us/azure/active-directory/fundamentals/add-custom-domain>

NEW QUESTION 36

- (Exam Topic 5)

You have a cloud solution that uses an Azure Functions consumption plan to scale hundreds of processes. A portion of the code is shown below. (Line numbers are included for reference only.)

```
01 [FunctionName("StartFunction")]
02 public static async Task<HttpResponseMessage> RunSingle(
03     [HttpTrigger(AuthorizationLevel.Function, methods:
04         "post", Route = "orchestrators/contoso_function01/<instance_id>")]
05     HttpRequestMessage req,
06     [OrchestrationClient] DurableOrchestrationClient starter,
07     string functionName, string instanceId, TraceWriter log)
08 {
09     var existingInstance = await starter.GetStatusAsync(instanceId);
10     if (existingInstance == null)
11     {
12         dynamic eventData = await req.Content.ReadAsAsync<object>();
13         await starter.StartNewAsync(functionName, instanceId, eventData);
14         log.Info($"Created");
15         return starter.CreateCheckStatusResponse(req, instanceId);
16     }
17     else
18     {
19         return req.CreateErrorResponse(HttpStatusCode.Conflict, $"Cannot create");
20     }
21 }
```

For each of the following statements, select Yes if the statement is true. Otherwise, select No. NOTE: Each correct selection is worth one point

Answer Area	Yes	No
The code intends to create an Azure Function singleton instance.	<input type="radio"/>	<input type="radio"/>
If no instanceID is passed into StartNewAsync, a random id is generated for the function.	<input type="radio"/>	<input type="radio"/>
The code ensures that there will never be two instances of the same function running.	<input type="radio"/>	<input type="radio"/>

- A. Mastered
- B. Not Mastered

Answer: A

Explanation:

Answer Area

	Yes	No
The code intends to create an Azure Function singleton instance.	<input type="radio"/>	<input checked="" type="radio"/>
If no instanceID is passed into StartNewAsync, a random id is generated for the function.	<input checked="" type="radio"/>	<input type="radio"/>
The code ensures that there will never be two instances of the same function running.	<input checked="" type="radio"/>	<input type="radio"/>

NEW QUESTION 38

- (Exam Topic 5)

You develop an IoT solution by using Nodejs. The solution is ready to deploy to the production environment. You must implement the device twin capabilities of Azure IoT Hub. You must register a sensor named Sensor00. The IoT Hub name is Hub01.

You need to register the endpoint with ContosoHub01 so that you can configure them from your solution. Which four commands should you use to develop the solution? To answer, move the appropriate commands from the list of commands to the answer area and arrange them in the correct order.

Commands

```
npm install azure-iot-device azure-iot-device-mqtt --save
```

```
az iot hub show-connection-string --name {Sensor00} --output table
```

```
az extension add --name azure-cli-iot-ext
```

```
az iot hub device-identity create --hub-name {Hub01} --device-id Sensor00
```

```
az iot hub device-identity create --hub-name {Hub01} --device-id Sensor00
```

Answer area

- A. Mastered
- B. Not Mastered

Answer: A

Explanation:

az extension add --name azure-cli-iot-ext

NEW QUESTION 41

- (Exam Topic 5)

You are developing an ASP.NET web application that you will deploy to Azure. The solution must meet the following requirements:

- Store user session state by using only serializable data types.
- Provide customizable caching of session data.
- Support scaling out the number of web hosts-
- Maximize performance.

Which solution meets these requirements?

- A. Clustered Azure Redis Cache
- B. ASP.NET Output Cache provider for Azure Redis Cache
- C. in-memory session state provider
- D. SQL Server session state provider

Answer: C

NEW QUESTION 42

- (Exam Topic 5)

You are developing a stateful service to deploy to Azure Service Fabric. You plan to implement the RunAsync method.

You need to implement the methods to interface with an instance of the IReliable dictionary interface to increment a count each time the service is called- The first

time the service is called, you must initialize the count to 1 if it does not yet exist and then update it by one each time it is called.

Which three methods should you run in sequence? To answer, move the appropriate methods from the list of methods to the answer area and arrange them in the correct order.



- A. Mastered
- B. Not Mastered

Answer: A

Explanation:



NEW QUESTION 43

- (Exam Topic 5)

You have an on-premises network that contains a Hyper-V host named Host1. Host1 runs Windows Server 2016 and hosts 10 virtual machines that run Windows Server 2016.

You plan to replicate the virtual machines to Azure by using Azure Site Recovery. You create a Recovery Services vault named ASR1 and a Hyper-V site named Site1. You need to add Host1 to ASR1.

What should you do?

- A. Download the installation file for the Azure Site Recovery Provider. Download the storage account key. Install the Azure Site Recovery Provider on each virtual machine and register the virtual machines.
- B. Download the installation file for the Azure Site Recovery Provider. Download the vault registration key. Install the Azure Site Recovery Provider on Host1 and register the server.
- C. Download the installation file for the Azure Site Recovery Provider. Download the storage account key. Install the Azure Site Recovery Provider on Host1 and register the server.
- D. Download the installation file for the Azure Site Recovery Provider. Download the vault registration key. Install the Azure Site Recovery Provider on each virtual machine and register the virtual machines.

Answer: B

Explanation:

References:

<https://docs.microsoft.com/en-us/azure/site-recovery/hyper-v-azure-tutorial>

NEW QUESTION 45

- (Exam Topic 5)

You maintain an existing Azure SQL Database instance. Management of the database is performed by an external party. All cryptographic keys are stored in an Azure Key Vault.

You must ensure that the external party cannot access the data in the SSN column of the Person table

Will each protection method meet the requirement? To answer, drag the appropriate responses to the correct protection methods. Each response may be used once, more than once, or not at all. You may need to drag the split bar between panes or scroll to view content.

NOTE: Each correct selection is worth one point

Responses	Answer Area	
<div>Yes</div> <div>No</div>	<p>Protection method</p> <p>Enable AlwaysOn encryption.</p> <p>Set the column encryption setting to disabled.</p> <p>Assign users to the Public fixed database role.</p> <p>Store column encryption keys in the system catalog view in the database.</p>	<div>Response</div> <div>Response</div> <div>Response</div> <div>Response</div>

- A. Mastered
B. Not Mastered

Answer: A

Explanation:

References:

<https://docs.microsoft.com/en-us/azure/security/azure-database-security-overview>

NEW QUESTION 50

- (Exam Topic 5)

Your network contains an Active Directory domain named adatum.com and an Azure Active Directory (Azure AD) tenant named adatum.onmicrosoft.com. Adatum.com contains the user accounts in the following table.

Name	Member of
User1	Domain Admins
User2	Schema Admins
User3	Incoming Forest Trust Builders
User4	Replicator
User5	Enterprise Admins

Adatum.onmiaosoft.com contains the user accounts in the following table.

Name	Role
UserA	Global administrator
UserB	User administrator
UserC	Security administrator
UserD	Service administrator

You need to implement Azure AD Connect. The solution must follow the principle of least privilege. Which user accounts should you use? To answer, select the appropriate options in the answer area.

NOTE: Each correct selection is worth one point.

Adatum.com:

User1
User2
User3
User4
User5

Adatum.onmicrosoft.com:

UserA
UserB
UserC
UserD

- A. Mastered
B. Not Mastered

Answer: A

Explanation:



NEW QUESTION 55

- (Exam Topic 5)

You have the following resource groups:

Resource group	Comments
DevServer_WestCentralUS	This resource group is located in the West Central US region and contains a single virtual machine (VM) named DevServer. DevServer is connected to a private subnet in an Azure Virtual Network that has no internet access.
Workstation_EastUS	This resource group is located in the East US region and contains a VM named DevWorkstation. DevWorkstation is connected to a subnet in a Virtual Network and is configured with a public IP address. A network security group has been configured to allow public incoming remote desktop protocol (RDP) connections to the DevWorkstation.

Developers must connect to Dev Server only through Dev Workstation. To maintain security, Dev Server must not accept connections from the internet. You need to create a private connection between the Dev Workstation and Dev Server.

Dev Workstation using their private IP addresses. Does the solution meet the goal?

- A. Yes
- B. NO

Answer: A

NEW QUESTION 59

- (Exam Topic 5)

You have an Azure subscription named Subscription1 that is used by several departments at your company. Subscription1 contains the resources in the following table.

Name	Type
Storage1	Storage account
RG1	Resource group
Container1	Blob container
Share1	File share

Another administrator deploys a virtual machine named VM1 and an Azure Storage account named Storage2 by using a single Azure Resource Manager template. You need to view the template used for the deployment.

From which blade can you view the template that was used for the deployment?

- A. Contained
- B. VM1
- C. Storage2
- D. RG1

Answer: D

NEW QUESTION 61

- (Exam Topic 5)

From the MFA Server blade, you open the Block/unblock users blade as shown in the exhibit.



What caused AlexW to be blocked?

- A. The user account password expired.
- B. The user reported a fraud alert when prompted for additional authentication.
- C. An administrator manually blocked the user.
- D. The user entered an incorrect PIN four times within 10 minutes.

Answer: C

NEW QUESTION 66

- (Exam Topic 5)

You have an Azure Service Bus.

You need to implement a Service Bus queue that guarantees first-in-first-out (FIFO) delivery of messages. What should you do?

- A. Enable partitioning
- B. Enable duplicate detection
- C. Set the Lock Duration setting to 10 seconds
- D. Enable sessions
- E. Set the Max Size setting of the queue to 5 GB

Answer: D

Explanation:

References:

<https://docs.microsoft.com/en-us/azure/service-bus-messaging/service-bus-azure-and-service-bus-queuescompar>

NEW QUESTION 67

- (Exam Topic 5)

You plan to deploy five virtual machines to a virtual network subnet.

Each virtual machine will have a public IP address and a private IP address. Each virtual machine requires the same inbound and outbound security rules.

What is the minimum number of network interfaces and network security groups that you require? To answer, select the appropriate options in the answer area.

NOTE: Each correct selection is worth one point.

Minimum number of network interfaces:

<input type="checkbox"/>	v
5	
10	
15	
20	

Minimum number of network security groups:

<input type="checkbox"/>	v
1	
2	
5	
10	

- A. Mastered
- B. Not Mastered

Answer: A

Explanation:

Minimum number of network interfaces:

5

10

15

20

▼

Minimum number of network security groups:

1

2

5

10

▼

NEW QUESTION 70

- (Exam Topic 5)

Note: This question is part of a series of questions that present the same scenario. Each question in the series contains a unique solution. Determine whether the solution meets the stated goals. You have the following resource groups:

Resource group	Comments
DevServer_WestCentralUS	<p>This resource group is located in the West Central US region and contains a single virtual machine named DevServer.</p> <p>DevServer is connected to a private subnet in an Azure Virtual Network that has no internet access.</p>
Workstation_EastUs	<p>This resource group is located in the East US region and contains a virtual machine named DevWorkstation.</p> <p>DevWorkstation is connected to a subnet in a Virtual Network and is configured with a public IP address. A network security group has been configured to allow public incoming remote desktop protocol (RDP) connections to the DevWorkstation.</p>

Developers must connect to DevServer only through DevWorkstation. To maintain security, DevServer must not accept connections from the internet. You need to create a private connection between the DevWokstation and DevServer.
Solution: Configure a public IP address on DevServer_WestCentral. Configure the Network Security Group to allow all incoming ports. Does the solution meet the goal?

- A. Yes
- B. NO

Answer: A

NEW QUESTION 75

- (Exam Topic 5)

You are creating a collaborative image hosting platform as an ASP.NET MVC web application. Users add, update, and modify images on the platform. Images are stored in Azure Blob storage.
More than one user at a time must be able to modify the same image. You need to implement optimistic concurrency for uploading images. Which four actions should you perform in sequence? To answer, move the appropriate actions from the list of actions to the answer area and arrange them in the correct order.

Actions

Check response headers. If the status code equals 200, notify that it is a success. If the code is 412, notify the user about a conflicting change.

When you upload the image, include the ETag in the If-None-Match conditional header of the PUT BLOB request.

Store the ETag of the blob for further use, and let the user make the necessary modifications to the image.

Retrieve an image blob from the storage service. The response includes an HTTP ETag Header value that identifies the current version of the image(Blob).

When you upload the image, include the ETag in the If-Match conditional header of the PUT BLOB request.

Answer area

- A. Mastered
- B. Not Mastered

Answer: A

Explanation:

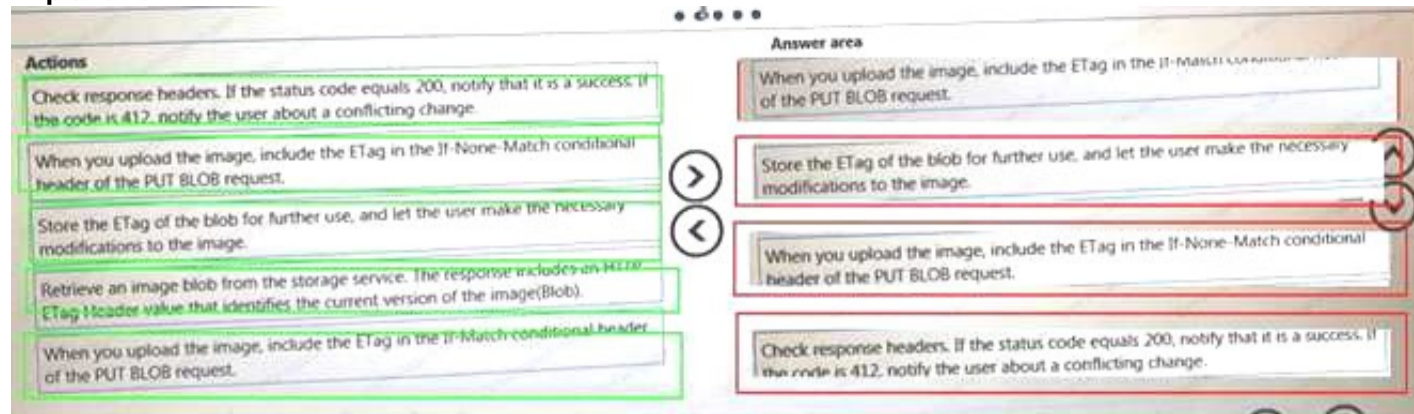

NEW QUESTION 80

- (Exam Topic 5)

You are developing an Azure web application to store and archive patient medical records in Azure. You need to configure data storage to meet the following policies:

- Ensure that you can configure a retention period for patient records.
- Archived data must be readable.
- Archived data must not be modified or deleted. Which Azure storage service should you use?

- A. Azure Tables
- B. Azure Blobs
- C. Azure Queues
- D. Azure Files

Answer: A

NEW QUESTION 84

- (Exam Topic 5)

You are creating a CU script that creates an Azure web app and related services in Azure App Service. The web app uses the following variables:

Variable name	Value
\$gitrepo	https://github.com/Contos/webapp
\$webappname	Webapp1103

You need to automatically deploy code from GitHub to the newly created web app.

How should you complete the script? To answer, select the appropriate options in the answer area. NOTE: Each correct selection is worth one point.

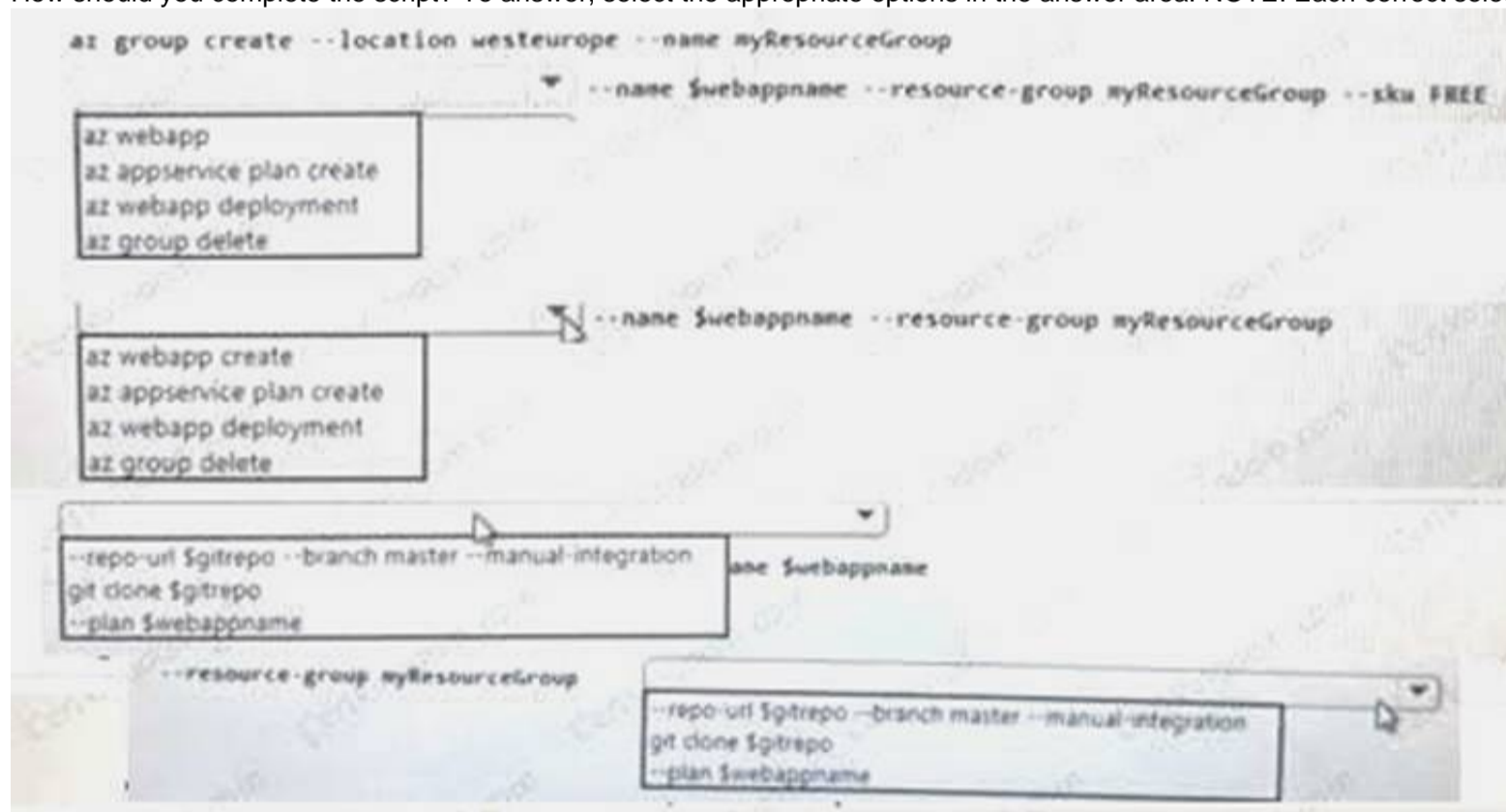

- A. Mastered
- B. Not Mastered

Answer: A

Explanation:

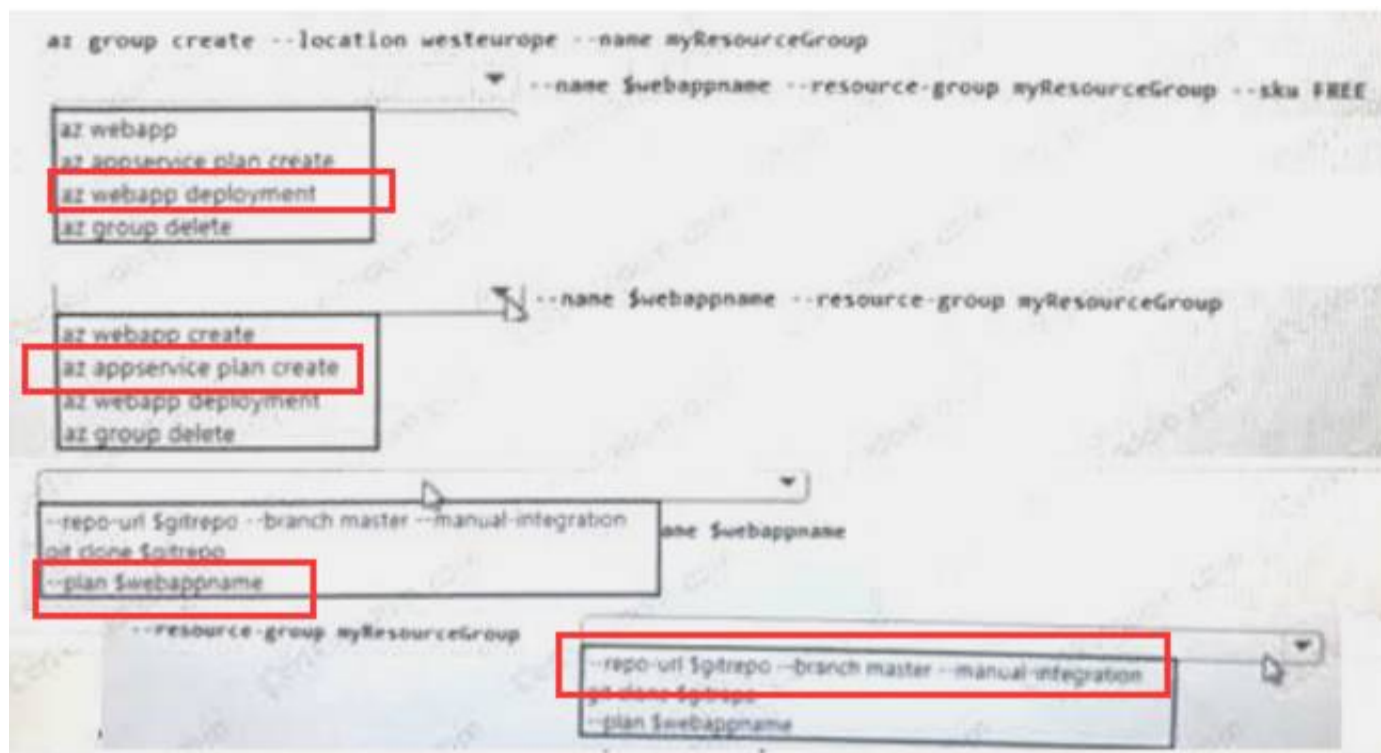

NEW QUESTION 85

- (Exam Topic 5)

You are developing an internal website for employee to view sensitive data. The website uses Azure Directory (AAD) for authentication.

You need to implement multifactor authentication for the website. What should you do? Each correct answer presents part of the solution. NOTE: Each correct selection is worth one point.

- A. Upgrade to Azure AD premium.
- B. In Azure ACL enable application pages.
- C. Configuration the website to user Azure AD BDC.
- D. In Azure AD conditional access enable the baseline policy.
- E. In Azure AD create a new conditional access policy.

Answer: CE

NEW QUESTION 89

- (Exam Topic 5)

You set the multi-factor authentication status for a user named admin1@contoso.com to Enabled.

Admin1 accesses the Azure portal by using a web browser.

Which additional security verifications can Admin1 use when accessing the Azure portal?

- A. an app password, a text message that contains a verification code, and a verification code sent from the Microsoft Authenticator app
- B. a phone call, a text message that contains a verification code, and a notification or a verification code sent from the Microsoft Authenticator app
- C. a phone call, an email message that contains a verification code, and a text message that contains an app password
- D. an app password, a text message that contains a verification code, and a notification sent from the Microsoft Authenticator app

Answer: B

Explanation:

References:

<https://docs.microsoft.com/en-us/azure/active-directory/authentication/concept-authentication-methods>

NEW QUESTION 93

- (Exam Topic 6)

Note: This question is part of a series of questions that present the same scenario. Each question in the series contains a unique solution. Determine whether the solution meets the stated goals.

You need to meet the vendor notification requirement.

Solution: Update the Delivery API to send emails by using a Microsoft Office 365 SMTP server. Does the solution meet the goal?

- A. Yes
- B. No

Answer: B

Explanation:

References:

<https://docs.microsoft.com/en-us/azure/api-management/api-management-howto-configure-notifications>

NEW QUESTION 98

- (Exam Topic 6)

You need to update the Inventory API.

Which development tools should you use? To answer, select the appropriate options in the answer area. NOTE: Each correct selection is worth one point.

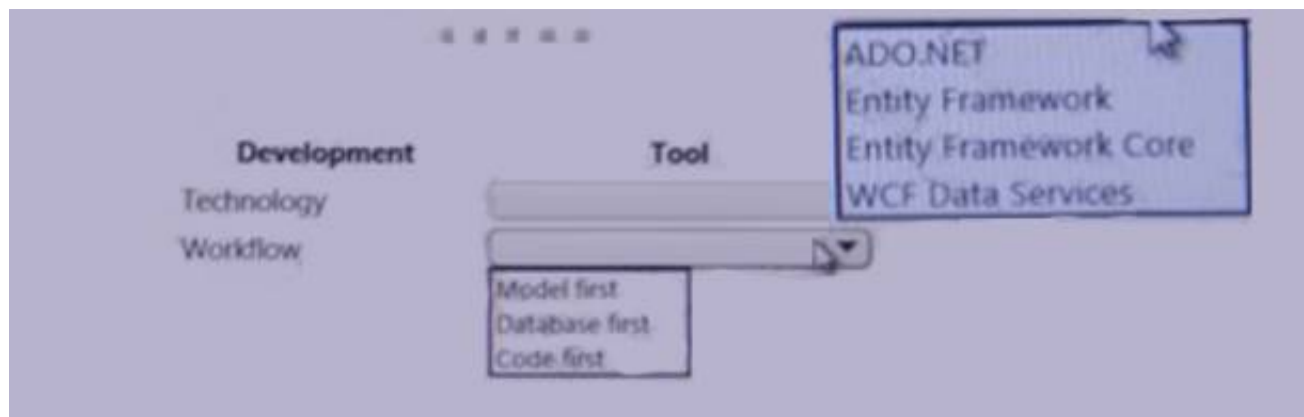

- A. Mastered
- B. Not Mastered

Answer: A

Explanation:

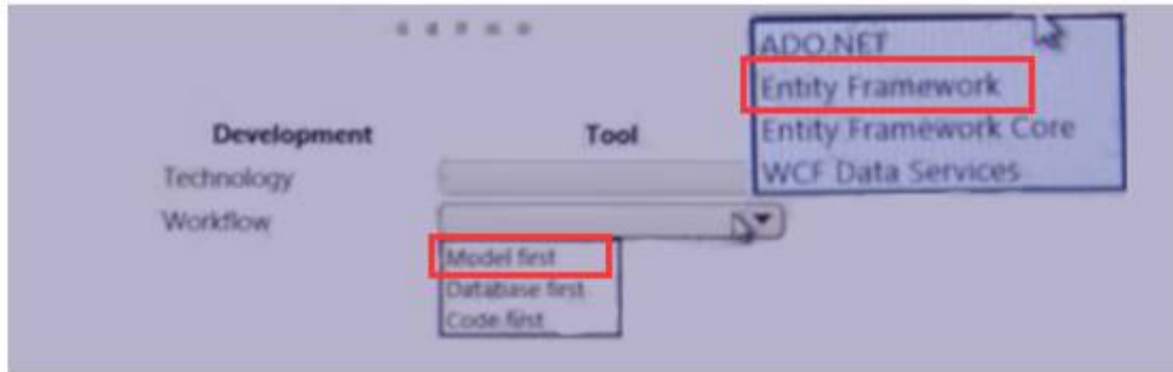

NEW QUESTION 102

- (Exam Topic 6)

You need to implement the purchase requirement. What should you do?

- A. Use the Bot Framework REST API conversation operations to send the user's voice and the Speech Service API to recognize intents.
- B. Use the Direct Line REST API to send the user's voice and the Speech Service API to recognize intents.
- C. Use the Speech Service API to send the user's voice and the Bot Framework REST API conversation operations to recognize intents.
- D. Use the Bot Framework REST API attachment operations to send the user's voice and the Speech Service API to recognize intents.

Answer: A

NEW QUESTION 105

.....

Thank You for Trying Our Product

* 100% Pass or Money Back

All our products come with a 90-day Money Back Guarantee.

* One year free update

You can enjoy free update one year. 24x7 online support.

* Trusted by Millions

We currently serve more than 30,000,000 customers.

* Shop Securely

All transactions are protected by VeriSign!

100% Pass Your AZ-300 Exam with Our Prep Materials Via below:

<https://www.certleader.com/AZ-300-dumps.html>