



Microsoft

Exam Questions PL-100

Microsoft Power Platform App Maker

About Exambible

[Your Partner of IT Exam](#)

Found in 1998

Exambible is a company specialized on providing high quality IT exam practice study materials, especially Cisco CCNA, CCDA, CCNP, CCIE, Checkpoint CCSE, CompTIA A+, Network+ certification practice exams and so on. We guarantee that the candidates will not only pass any IT exam at the first attempt but also get profound understanding about the certificates they have got. There are so many alike companies in this industry, however, Exambible has its unique advantages that other companies could not achieve.

Our Advances

* 99.9% Uptime

All examinations will be up to date.

* 24/7 Quality Support

We will provide service round the clock.

* 100% Pass Rate

Our guarantee that you will pass the exam.

* Unique Gurantee

If you do not pass the exam at the first time, we will not only arrange FULL REFUND for you, but also provide you another exam of your claim, ABSOLUTELY FREE!

NEW QUESTION 1

HOTSPOT - (Topic 4)

HOTSPOT

A company uses Microsoft Teams and Microsoft 365. Employees use Microsoft Excel to create checklist and capture measurements.

The company requires a Microsoft Power Platform app to consolidate the checklists and perform the measurements- Network connectivity may not be available when measurements are taken.

Which features should you use? To answer, select the appropriate options in the answer area

NOTE: Each correct selection is worth one point.

Answer Area

Requirement	Feature
App type	<div>Model-driven app</div> <div>Canvas app</div> <div>Model-driven app</div>
Data source	<div>Cloud Excel table</div> <div>Local Excel table</div> <div>Cloud Excel table</div>
Offline mode	<div>Power Apps mobile</div> <div>Field Service Mobile</div> <div>Power Apps mobile</div> <div>Power Apps for Windows</div> <div>Power Apps wrap</div>

- A. Mastered
- B. Not Mastered

Answer: A

Explanation:

Answer Area

Requirement	Feature
App type	<div>Model-driven app</div> <div>Canvas app</div> <div>Model-driven app</div>
Data source	<div>Cloud Excel table</div> <div>Local Excel table</div> <div>Cloud Excel table</div>
Offline mode	<div>Power Apps mobile</div> <div>Field Service Mobile</div> <div>Power Apps mobile</div> <div>Power Apps for Windows</div> <div>Power Apps wrap</div>

NEW QUESTION 2

- (Topic 4)

Note: This question is part of a series of questions that present the same scenario. Each question in the series contains a unique solution that might meet the stated goals. Some question sets might have more than one correct solution, while others might not have a correct solution.

After you answer a question in this section, you will NOT be able to return to it. As a result, these questions will not appear in the review screen.

A company is deploying Microsoft Power Platform components to streamline a job candidate screening process.

The human resources (HR) representatives of the company plan to attend school career fairs. The HR representatives must qualify and enter potential job candidates into a Power Apps app. The HR representatives must enter the following information for each candidate:

Field name	Data type	Criteria for follow up
Name	Text	No
Degree	Text	Yes
First available hire date	Date	Yes
Initial impression	Integer 0-10	Yes
Resume	Picture	No
Not currently viable	Boolean	Yes
Follow up	Boolean	NA

If a candidate is currently unqualified for a job position but would eventually qualify based on follow-up criteria, the follow-up checkbox must be selected or cleared in the system immediately.

The company plans to create a similar Power Apps app that will contain the same business use case, but for internal employees and promotions.

You need to create a Power Apps app solution to automatically mark the candidate for follow up.

Proposed solution: Use a Common Data Service workflow with a PowerQuery on the data entity.

Does the solution meet the goal?

- A. Yes

B. No

Answer: A

Explanation:

Process (Workflow) table/entity reference is a set of logical rules that define the steps necessary to automate a specific business process, task, or set of actions to be performed.

Common Data Service workflow support: Filter triggers based on which attributes change - You can control which field changes trigger your automated flows. For example, trigger your flow only when the status field changes while ignoring all other fields that may change.

Reference:

<https://docs.microsoft.com/en-us/business-applications-release-notes/april19/microsoft->

NEW QUESTION 3

HOTSPOT - (Topic 4)

You are configuring security to enable users to analyze data by using Microsoft Excel templates.

You create a security role named TemplateAdministrator and configure the role as shown below and assign the role to a user named User1.

Power Apps

FileSave and CloseActionsHelp

Security role: TemplateAdministratorWorking on solutions: Default Solution

DetailsCore RecordsMarketingSalesServiceBusiness ManagementService ManagementCustomizationMissing EntitiesBusiness Process FlowsCustom Entities

Entity	Create	Read	Write	Delete	Append	Append To	Assign	Share
Business Unit								
Channel Property Group								
Currency								
Document Template								
Mailbox Auto Tracking Folder								
Organization								
Personal Document Template								

Privacy Related Privileges

Enabling these privileges will allow users to extract customer data from Microsoft Dynamics 365. For more information, review the corresponding user documentation.

Document Generation		Dynamics 365 for mobile	
Export to Excel		Go Offline in Outlook	
Mail Merge		Print	
Sync to Outlook		Use Dynamics 365 App for Outlook	

Miscellaneous Privileges

Act on Behalf of Another User		Approve Email Addresses for Users or Queues	
Assign manager for a user		Assign position for a user	
Assign Territory to User		Bulk Edit	

Key

None Selected User Business Unit Parent: Child Business Unit Organization

Use the drop-down menus to select the answer choice that answers each question based on the information presented in the graphic.

NOTE: Each correct selection is worth one point.

You need to ensure that User1 can see the pre-configured example templates.
Which permission should you change?

Bulk Edit

Export to Excel

Read on Document Template

Read on Personal Document Template

You need to ensure that User1 can download the file to create an Excel template.
Which permission should you change?

Bulk Edit

Export to Excel

Read on Document Template

Read on Personal Document Template

- A. Mastered
- B. Not Mastered

Answer: A

Explanation:

You need to ensure that User1 can see the pre-configured example templates.
 Which permission should you change?

	▼
Bulk Edit	
Export to Excel	
Read on Document Template	
Read on Personal Document Template	

You need to ensure that User1 can download the file to create an Excel template.
 Which permission should you change?

	▼
Bulk Edit	
Export to Excel	
Read on Document Template	
Read on Personal Document Template	

NEW QUESTION 4

- (Topic 4)

You create a Power Platform solution. Solution data is stored in a variety of documented cloud services.

You must also be able to connect to one or more industry data sources. You need to configure the data sources.

What should you do?

- A. Create a business process flow.
- B. Create a data policy template.
- C. Create a UI flow.
- D. Use an existing data connector.

Answer: D

Explanation:

In Power Apps, add a data connection to an existing canvas app or to an app that you're building from scratch. Your app can connect to SharePoint, Common Data Service, Salesforce, OneDrive, or many other data sources.

Note:

Add data source

- * 1. In the center pane, select connect to data to open the Data pane.
- * 2. Select Add data source.
- * 3. If the list of connections includes the one that you want, select it to add it to the app. Otherwise, skip to the next step.
- * 4. Select New connection to display a list of connections.
- * 5. In the search bar, type or paste the first few letters of the connection you want, and then select the connection when it appears.

Data

×

×

←

My connections

MySQL

💡

💎

PostgreSQL

💡

💎

SQL Server

💡

💎

- * 6. Select Create to both create the connection and add it to your app.

Reference:

<https://docs.microsoft.com/en-us/powerapps/maker/canvas-apps/add-data-connection>

NEW QUESTION 5

- (Topic 4)

You are creating a canvas app that displays a list of accounts.

Users must be able to select an account and view details for the account. The app must include a feature that brings the user back to the list of accounts.

You add a blank screen named Screen_Accounts and add a gallery named Gallery_Accounts to the screen. You set the data source of Gallery_Accounts to Accounts and add another blank screen named Screen_AccountDetail.

You need to complete the app.

What are two possible ways to achieve the goal? Each correct answer presents a complete solution.

NOTE: Each correct selection is worth one point.

- A. Add an edit form to Screen_AccountDetail and set the Default Mode of the form to Vie
- B. Set the OnSelect property of Gallery_Accounts to Navigate(Screen_AccountDetail).Set the data source of the form to Account
- C. Set the Item property of the form to Selected.Add a back icon on Screen_AccountDetail and set its OnSelect property to Navigate(Screen_Accounts).
- D. Add an edit form to Screen_AccountDetail and set the Default Mode of the form to Vie
- E. Set the OnSelect property of Gallery_Accounts to Navigate(Screen_AccountDetail).Set the data source of the form to Accounts.Set the Item property of the form to First(Accounts).Add a back icon on Screen_AccountDetail and set its OnSelect property to Navigate(Screen_Accounts).
- F. Add an edit form to Screen_AccountDetail and set the Default Mode of the form to Ne
- G. Set the OnSelect property of Gallery_Accounts to Navigate(Screen_AccountDetail).Set the data source of the form to Account
- H. Set the Item property of the form to Selected.Add a back icon on Screen_AccountDetail and set its OnSelect property to Navigate(Screen_Accounts).
- I. Add a display form to Screen_AccountDetail.Set the data source of the form to Account
- J. Set the Item property of the form to Selected.Add a back icon on Screen_AccountDetail and set its OnSelect property to Navigate(Screen_Accounts).

Answer: AD

Explanation:

Reference:

<https://docs.microsoft.com/en-us/powerapps/maker/canvas-apps/functions/function-form>

NEW QUESTION 6

- (Topic 4)

You create a canvas app.

You need to make the app available to other people in your company.

What are two possible ways to achieve the goal? Each correct answer presents a complete solution.

NOTE: Each correct selection is worth one point.

- A. Grant access to individual users in your company.
- B. Share the app with a Microsoft Exchange distribution list.
- C. Grant access to a Microsoft Teams team.
- D. Share the app with a Microsoft Azure Active Directory security group.

Answer: AD

Explanation:

After you build a canvas app that addresses a business need, specify which users in your organization can run the app and which can modify and even reshare it. Specify each user by name, or specify a security group in Azure Active Directory.

Reference:

<https://docs.microsoft.com/en-us/powerapps/maker/canvas-apps/share-app>

NEW QUESTION 7

- (Topic 4)

You create a canvas app for technicians at a computer store. You assign technicians cases to work on. The technicians update cases at the end of customer site visit.

The manager wants the technicians to sell warranties to the customers. If a customer agrees to purchase a warranty, technicians use the canvas app to immediately alert the sales team, and then the technician records details about the warranty into the app.

You need to create a flow to alert the sales team. Which type of trigger should you use?

- A. Flow button for mobile
- B. Office 365 Outlook
- C. Common Data Service

Answer: A

Explanation:

Create a button flow to run routine tasks by simply tapping a button. Customize your flow by allowing the user to provide specific details that will be used when the flow runs.

Note: There are many repetitive tasks that we all wish we could run with just a tap of a button. For example, you may need to quickly email your team to remind them to join the daily team sync, or you may want to start a new Visual Studio Codespaces build of your code base after you've been notified that there are no more checkins planned for the day. Button flows allow you to accomplish these and many other tasks simply by tapping a button on your mobile device.

Reference:

<https://docs.microsoft.com/en-us/power-automate/button-flow-with-user-input-tokens>

NEW QUESTION 8

DRAG DROP - (Topic 4)

You are creating a canvas app that reads and writes to a data source.

You need to configure the app to perform create and update data operations.

Which functions should you use? To answer, drag the appropriate functions to the correct data operations. Each function may be used once, more than once, or not at all. You may need to drag the split bar between panes or scroll to view content.

NOTE; Each correct selection is worth one point.

Functions		Answer Area	
<div>Patch</div>	⋮	Data operation	Function
<div>Update</div>		Replace an entire record.	<div></div>
<div>AddColumns</div>		Update specific columns.	<div></div>

- A. Mastered
B. Not Mastered

Answer: A

Explanation:

Functions		Answer Area	
<div>Patch</div>	⋮	Data operation	Function
<div>Update</div>		Replace an entire record.	<div>Patch</div>
<div>AddColumns</div>		Update specific columns.	<div>AddColumns</div>

NEW QUESTION 9

- (Topic 4)

You create a canvas app that connects to a Common Data Service database. Users report that they do not see any data in the app. You need to ensure that users can view data in the app. What should you do?

- A. Share the app with the users
B. Add a Power Apps license to the users
C. Assign a security role to the users
D. Publish the app

Answer: C

Explanation:

Sharing access to the data in the Common Data Service. The users need permission to access the entities the app uses. To grant them access, you will need to:

- * 1. Create a security role
- * 2. Assign users to the security role

Note: Common Data Service for Apps has a powerful enterprise grade security model that allows you to group users in security roles and give those roles varying levels of access to entities that some of our most sophisticated business apps are built on.

Reference:

<https://powerapps.microsoft.com/en-us/blog/sharing-a-canvas-app-built-on-top-of-common-data-service/D18912E1457D5D1DDCBD40AB3BF70D5D>

NEW QUESTION 10

- (Topic 4)

Each maker at a company has a separate Common Data Service environment. You are customizing a canvas app. You create two new entities in your environment.

You are leaving for a vacation. Another maker will continue customizing the app in your absence.

You need to transfer the work to the other maker and ensure that you can work on the updated app when you return from your vacation.

What should you export?

- A. unmanaged solution that includes all customizations
B. the default solution
C. a managed solution that includes all customizations
D. the app

Answer: A

Explanation:

Unmanaged Solution: The beginning state of solution is the unmanaged solution state. During this phase, you can add, edit, update, remove, delete, and test any of the components of the solution.

Reference:

<https://powerusers.microsoft.com/t5/Power-Apps-Pro-Dev-ISV/Managed-vs->

NEW QUESTION 10

DRAG DROP - (Topic 4)

You create a canvas app for a store.

The logo must appear as the background image for the app. A loading spinner must display on the screen as the app loads.

You need to add the features to the app.

What should you modify? To answer, drag the appropriate form areas to the correct requests. Each form area may be used once, more than once, or not at all.

You may need to drag the split bar between panes or scroll to view content.

NOTE: Each correct selection is worth one point.

Screen areas

Form

Gallery

Screen

Feature request

Add logo.

Add loading spinner.

Screen area

- A. Mastered
- B. Not Mastered

Answer: A

Explanation:

Box 1: Screen
You can add an image to a screen in several different ways. One way is to upload an image to the app, go to the Media tab, and then click on the image to add it to a screen.
Note: Configure graphical elements in your app, including images, photos, and elements of a pen control.
BackgroundImage – The name of an image file that appears in the background of a screen. Applies to the Screen control.
Box 2: Screen
Out Of Box Canvas App, provide a property called LoadingSpinner and LoadingSpinnerColor.
LoadingSpinner property is used to displaying a Canvas App OOB Loader Image unless your screen finishes loading.
Click on the Screen in your Canvas App and then You'll be able to see LoadingSpinner and LoadingSpinnerColor Property.

NEW QUESTION 12

- (Topic 4)
You create a model-driven app for salespeople.
Users must interact with a business process flow that invokes multiple tables. You need to instruct users where to find the business process flow, which component should you use?

- A. form
- B. command bar
- C. dashboard
- D. site map

Answer: D

NEW QUESTION 14

- (Topic 4)
A company receives its marketing campaign performance report as a Microsoft Excel file. The company stores the file in Microsoft SharePoint.
A user updates the Excel file daily with updated data.
The company needs a solution that automatically displays the latest analytics.
You need to create a basic report that contains pie charts that display the most profitable channels.
You need to propose the right solution.
Solution: Model-driven application using native charts. Does the solution meet the goal?

- A. Yes

Answer: B

NEW QUESTION 15

DRAG DROP - (Topic 4)
A company plans to use Microsoft Power Platform to modernize their business.
Sales commissions are given only to the representatives who sell items from a designated category of products. The company wants to minimize the effort needed to manage data security.
You need to describe how to store real-world objects to the business stakeholders.
What should you use? To answer, drag the appropriate tables to the correct objects. Each table may be used once, more than once, or not at all. You may need to drag the split bar between panes or scroll to view content.
NOTE: Each correct selection is worth one point.

Tables

Organization-owned standard table

User-owned standard table

Activity table

Virtual table

Answer Area

Object

Item manufacturer

Item model

Item inventory

Table

- A. Mastered
- B. Not Mastered

Answer: A

Explanation:

Tables

Organization-owned standard table

User-owned standard table

Activity table

Virtual table

Answer Area

Object

Item manufacturer

Item model

Item inventory

Table

Organization-owned standard table

User-owned standard table

Virtual table

NEW QUESTION 18

DRAG DROP - (Topic 4)
DRAG DROP

A company uses Microsoft Power Platform. All users in the company have read/write and create access to SharePoint. You create a canvas app that displays data from a SharePoint list. A group of users must use the app without the ability to change the data source. You need to shore the app with the users. What should you do? To answer, drag the appropriate actions to the correct components. Each action may be used once, more than once, or not at all. You may need to drag the split bar between panes or scroll to view content. NOTE: Each correct selection is worth one point.

Actions

Send all users an email invitation.

Enable Can use permission.

Set the users as co-owners.

Enable Can edit permission.

Answer Area

Component

Canvas app

SharePoint connection

Action

- A. Mastered
- B. Not Mastered

Answer: A

Explanation:

Actions

Send all users an email invitation.

Enable Can use permission.

Set the users as co-owners.

Enable Can edit permission.

Answer Area

Component

Canvas app

SharePoint connection

Action

Send all users an email invitation.

Enable Can use permission.

NEW QUESTION 22

DRAG DROP - (Topic 4)
DRAG DROP

A company is creating Power Apps apps for their customer service team. You must create a final released solution to export to their test environment that cannot be changed in the new environment. You need to determine the types of solutions to use. Which type of solution should you use? To answer, drag the appropriate solution types to the correct conditions. Each solution type may be used once, more than once, or not at all. You may need to drag the split bar between panes or scroll to view content. NOTE: Each correct selection is worth one point.

Solution type

Managed

Unmanaged

Answer Area

Condition

Assign a publisher for the first time

Export the solution

Solution type

Solution type

Solution type

- A. Mastered
- B. Not Mastered

Answer: A

Explanation:

Box 1: Unmanaged
Unmanaged solutions are used in development environments while you make changes to your application.
Box 2: Managed
Managed solutions are used to deploy to any environment that isn't a development environment for that solution.

NEW QUESTION 26

DRAG DROP - (Topic 4)
DRAG DROP

A company uses Microsoft Power Platform. Users create charts based on specific needs in You create a solution in a development environment. You rebuild personal charts of the users inside the solution. All charts must appear on one page. You need to create a single page that includes all charts without switching to classic. Which three steps should you perform in sequence? To answer, move the appropriate actions from the list of actions to the answer area and arrange them in the correct order.

Actions

Create a new dashboard.

Open the solution in the Maker portal.

Add the charts to the dashboard.

Create a new interactive experience dashboard.

>

<

Answer Area

>

<

- A. Mastered
- B. Not Mastered

Answer: A

Explanation:

Actions

Create a new dashboard.

Open the solution in the Maker portal.

Add the charts to the dashboard.

Create a new interactive experience dashboard.

>

<

Answer Area

Open the solution in the Maker portal.

Add the charts to the dashboard.

Create a new interactive experience dashboard.

>

<

NEW QUESTION 27

DRAG DROP - (Topic 4)
DRAG DROP

A commercial bakery uses an inventory system to track ingredients consumed in their production line. The workers use iPads to interact with the system and reserve the ingredients for the next batch. Data from the system is extracted as a .csv file. You need to create a Power BI report from the extracted data by using only an iPad. Which five actions should you perform in sequence? To answer, move the appropriate actions from the list of actions to the answer area and arrange them in the correct order.

Actions

Select manual data.

Log into the Power BI service.

Install Power BI Desktop and log in.

Select **Create**.

Select **Use first row as headers**.

Paste the data.

>

<

Answer Area

>

<

- A. Mastered
- B. Not Mastered

Answer: A

Explanation:

Actions

Select manual data.

Log into the Power BI service.

Install Power BI Desktop and log in.

Select **Create**.

Select **Use first row as headers**.

Paste the data.

>

<

Answer Area

Log into the Power BI service.

Install Power BI Desktop and log in.

Select **Create**.

Select **Use first row as headers**.

Paste the data.

>

<

NEW QUESTION 30

HOTSPOT - (Topic 4)

A company uses Microsoft Dataverse to store holiday employee request data. An HR manager needs a report that displays overview information about the employee requests. You need to design a report that visualizes request data over time and type. Which Microsoft Power BI functionalities should you use to complete each step? To answer, select the appropriate options in the answer area. NOTE: Each correct selection is worth one point.

Answer Area

Step	Functionality
Create additional relationships between tables	<div>Model view</div> <div>Model view</div> <div>Data view</div> <div>Report view</div>
Change the data type of a column	<div>Data view</div> <div>Model view</div> <div>Data view</div> <div>Report view</div>
Design visuals	<div>Report view</div> <div>Model view</div> <div>Data view</div> <div>Report view</div>
Choose data for import	<div>Navigator</div> <div>Data view</div> <div>Report view</div> <div>Navigator</div>

- A. Mastered
- B. Not Mastered

Answer: A

Explanation:

Answer Area

Step	Functionality
Create additional relationships between tables	<div>Model view</div> <div>Model view</div> <div>Data view</div> <div>Report view</div>
Change the data type of a column	<div>Data view</div> <div>Model view</div> <div>Data view</div> <div>Report view</div>
Design visuals	<div>Report view</div> <div>Model view</div> <div>Data view</div> <div>Report view</div>
Choose data for import	<div>Navigator</div> <div>Data view</div> <div>Report view</div> <div>Navigator</div>

NEW QUESTION 34

DRAG DROP - (Topic 4)

A company is building multiple Power Apps apps to support a mobile sales team. The apps must all share a common control that has custom properties. You need to create a solution for the apps. Which objects should you use? To answer, drag the appropriate objects to the correct to drag the split bar between panes or scroll to view content. NOTE: Each correct selection is worth one point.

Objects	Requirement	Object
Entity	Reuse the custom control for multiple canvas apps.	
Component		
Component library	Receive input data through a custom property.	
Component framework		

- A. Mastered
- B. Not Mastered

Answer: A

Explanation:

Box 1: Component library

Components are reusable building blocks for canvas apps so that app makers can create custom controls to use inside an app, or across apps using a component library. Components can use advanced features such as custom properties and enable complex capabilities. By creating a component library, app makers easily share and update one or more components with other makers. Component libraries are containers of component definitions that make it easy to: Discover and search components. Publish updates. Notify app makers of available component updates.

Box 2: Component

A component can receive input values and emit data if you create one or more custom properties.

NEW QUESTION 39

- (Topic 4)

A company has hundreds of warehouses. You are developing an app for the shipping department at the company. The app must be able to provide the warehouse address for shipments. You need to create the warehouse field on the app form. Which field type should you use?

- A. Lookup
- B. Choice
- C. Choices
- D. Text

Answer: A

NEW QUESTION 43

- (Topic 4)

A company plans to roll out several Power Apps apps to multiple business units across international operations.

The apps must be managed through an application lifecycle management (ALM) solution to provide a consistent and predictable use experience. All changes to the app must be traceable and documented in a single location. You must be able to revert to a previous version of an app. The app release cycles must be as streamlined as possible.

You need to create an application for the apps.

Which two tools should you use? Each correct answer presents part of the solution.

NOTE: Each correct selection is worth one point.

- A. Microsoft Azure DevOps
- B. Microsoft Visual Studio
- C. Lifecycle Services
- D. AppSource
- E. Common Data Service

Answer: AD

Explanation:

A: DevOps is the combining of two historically disparate disciplines: software development

and IT operations. The primary goal of DevOps is to shorten the software development lifecycle and provide continuous integration and continuous delivery (CI/CD) with high software quality. You can use Power Apps build tools to automate common build and deployment tasks related to Power Apps if your DevOps platform is Azure DevOps.

D: Microsoft AppSource is now embedded in the Dynamics 365 home page and throughout the common navigation. It now includes a private gallery of apps available to you within your company. Select Get more apps from the home page or task pane, and navigate to the My Organization tab to see apps that are available to you.

Reference:

<https://docs.microsoft.com/en-us/power-platform/alm/devops-build-tools> <https://docs.microsoft.com/en-us/powerapps/user/app-source>

NEW QUESTION 47

- (Topic 3)

You need to resolve the instructor's issue and ensure that the same issue does not occur again. What should you use?

- A. Gallery
- B. Combo box
- C. Custom component
- D. Choices

Answer: D

NEW QUESTION 49

DRAG DROP - (Topic 3)

You need to create the food bank notification.

Which four actions should you perform in sequence? To answer, move the appropriate

Actions	Answer area
Create a food bank topic.	
Retrieve the food bank locations.	
Authenticate the food bank user.	
Retrieve meals in food pool filtered by location.	
Filter the list of food available to the food pool.	
Prompt the user to select a location.	
Prompt the user to select meals.	

- A. Mastered
- B. Not Mastered

Answer: A

Explanation:

Actions	Answer area
Create a food bank topic.	
Retrieve the food bank locations.	
Authenticate the food bank user.	
Retrieve meals in food pool filtered by location.	
Filter the list of food available to the food pool.	
Prompt the user to select a location.	
Prompt the user to select meals.	

NEW QUESTION 52

- (Topic 2)

You need to create a flow for moving data from the Sales Log to the Job Setup entity. Which type of flow should you use?

- A. a scheduled flow for the Job Setup entity
- B. an instant (button) flow for the Sales Log

- C. a business process flow for the Job Setup entity
- D. an automated flow for the Sales Log

Answer: A

Explanation:

Scenario: Automatically perform the following actions immediately when a sale is won:

? Generate a sequential job number.

? Copy key sales information to the Job Setup entity used by manufacturing.

NEW QUESTION 55

- (Topic 2)

You need to connect to the data source for the Job Setup app. What should you do?

- A. Configure a scheduled synchronization with the Common Data Service database
- B. Configure SQL Server database permissions
- C. Create a stored procedure that retrieves time records for a specific employee
- D. Configure an on-premises data gateway

Answer: D

Explanation:

Scenario: The Job Setup entity must store its data in the existing on-premises SQL Server instance.

The on-premises data gateway acts as a bridge to provide quick and secure data transfer between onpremises data (data that isn't in the cloud) and several Microsoft cloud services. These cloud services include Power BI, Power Apps, Power Automate, Azure Analysis Services, and Azure Logic Apps. By using a gateway, organizations can keep databases and other data sources on their on-premises networks, yet securely use that on-premises data in cloud services.

Reference:

<https://docs.microsoft.com/en-us/powerapps/maker/canvas-apps/gateway-reference>

NEW QUESTION 58

HOTSPOT - (Topic 2)

You need to meet the requirement for the time tracking app.

Which controls should you use? To answer, select the appropriate options in the answer area.

NOTE: Each correct selection is worth one point.

Requirement	Solution
Automatically record the duration of work when a job number is read.	<div><div></div><div>Card</div><div>Rating</div><div>Slider</div><div>Timer</div></div>
Read the employee's number into the app.	<div><div></div><div>Barcode-scanner</div><div>Card</div><div>Image</div><div>Shape</div></div>
Display a photo of an employee when the employee badge is read.	<div><div></div><div>Camera</div><div>Card</div><div>Icon</div><div>Image</div></div>

- A. Mastered
- B. Not Mastered

Answer: A

Explanation:

Box 1: Timer

A Timer control in Power Apps is a control that can determine how your app responds after a certain amount of time passes.

Box 2: Barcode scanner

The Barcode scanner control for canvas apps scans barcodes, QR codes, and data-matrix codes on an Android or iOS device.

Box 3: Image

Image control in Power Apps is a control that shows an image from, for example, a local file or a data source.

NEW QUESTION 60

HOTSPOT - (Topic 1)

You need to configure the app to meet the requirements.

Which object properties should you configure? To answer, select the appropriate options in

NOTE: Each correct selection is worth one point.

Requirement	Property
Provide a visual indicator when the app is offline.	<div><div></div><div>Visible</div><div>OnSelect</div><div>DisplayMode</div><div>Fill</div></div>
Store data when the app is offline.	<div><div></div><div>OnSelect</div><div>LoadData</div><div>SubmitForm</div><div>Now</div></div>

- A. Mastered
B. Not Mastered

Answer: A

Explanation:

Box 1: Fill

Scenario: You must display a visual indicator in the app so that sales representatives know whether the app is offline before submitting reports.

Fill – The background color of a control.

NEW QUESTION 62

- (Topic 1)

You need to provide all app components of the application to Tailwind Traders. What should you do?

- A. Package the application and flow components into a single solution for export.
B. Run the app checker and flow checker prior to publishing each component for export.
C. Export each component separately but use the same version number for each component.
D. Publish the application and flow solutions at the same time before exporting each one.

Answer: B

Explanation:

Scenario: When identifying versions of the app solution, all dependencies, entities, and user interfaces components must be identified to avoid any unintentional issues caused by reverting individual components to a previous version.

Power Apps has added components to the rule set that encourages best practices in the Power Apps Checker. You can check your canvas apps and flows that are included in solutions and then review all issues in a single, consolidated report.

Reference:

<https://docs.microsoft.com/en-us/power-platform-release-plan/2019wave2/microsoft-powerapps/checker-includes-rules-canvas-apps-flows>

NEW QUESTION 64

HOTSPOT - (Topic 1)

You need to roll back the mobile app to an earlier version.

Requirement	Action
Identify the currently published version and view version notes.	<div><div></div><div>View the session details page for the app in Power Apps Studio.</div><div>View environment details for the app in the Power Admin portal.</div><div>View details for the app in the Power Apps Maker portal.</div></div>
Revert to an earlier version of the app.	<div><div></div><div>Select Restore on the previous version of the app.</div><div>Export the previous version of the app and import as a new version.</div><div>Delete versions of the app until the desired version is the most recent.</div></div>

What should you do? To answer, select the appropriate options in the answer area. NOTE: Each correct selection is worth one point.

Requirement	Action
Identify the currently published version and view version notes.	<div><div></div><div>View the session details page for the app in Power Apps Studio.</div><div>View environment details for the app in the Power Admin portal.</div><div>View details for the app in the Power Apps Maker portal.</div></div>
Revert to an earlier version of the app.	<div><div></div><div>Select Restore on the previous version of the app.</div><div>Export the previous version of the app and import as a new version.</div><div>Delete versions of the app until the desired version is the most recent.</div></div>

- A. Mastered
B. Not Mastered

Answer: A

Explanation:

Box 1: View the sessions details page for the app in Power Apps Studio

Use PowerApps Studio, select the App, and choose and you will be directed to the app's Versions tab in PowerApps portal. There should be one version marked Live.

Details • Share • Versions • Settings

PowerApps keeps a version history of your apps.

VERSION	MODIFIED	MODIFIED BY	POWERAPPS RELEASE ?	PUBLISHED	COMMENT
1	6/7/2017 9:01:43 AM	Karthik Bharathy	2.0.659	Live	

Box 2: Select Restore on the previous version of the app. Restore an app from your account

? Open powerapps.com, and then click or tap Apps in the left navigation bar.

? Near the right edge, click or tap the info icon for the app that you want to restore.

? Click or tap the Versions tab, and then click or tap Restore for the version that you want to restore.

Details • Share • Versions • Settings • Analytics (preview)

PowerApps keeps a version history of your apps.

VERSION	MODIFIED	MODIFIED BY	POWERAPPS RELEASE ?	PUBLISHED	COMMENT
2	8/20/2018 2:24:29 PM	Firstname Lastname	3.18081.19	Live	Restore Delete
1	7/9/2018 10:55:48 AM	Firstname LastName	3.18071.36		Restore Delete

NEW QUESTION 69

- (Topic 1)

You publish the first version of the app and solution on November 1, 2020. You need to create the version numbers for the app and the solution. Which version numbers should you use? To answer, select the appropriate options in the answer area.

NOTE: Each correct selection is worth one point.

Versions

Version 1

1.0.0.0

1.20.11.1

20.11.1.1

Answer Area

Object	Version
Solution	<div>Version</div>
App	<div>Version</div>

- A. Mastered
- B. Not Mastered

Answer: A

Explanation:

Box 1: 1.0.0.0

When identifying versions of the app solution, all dependencies, entities, and user interfaces components must be identified to avoid any unintentional issues caused by reverting individual components to a previous version.

A solution's version has the following format: major.minor.build.revision. An update must have a higher major, minor, build or revision number than the parent solution. For example, for a base solution version 3.1.5.7, a small update could be a version 3.1.5.8 or a slightly more significant update could have version 3.1.7.0. A substantially more significant update could be version 3.2.0.0.

Box 2: 20.11.1.1

Scenario:

? You must use the following version control numbering scheme:

- Major: The last two digits of the year the app is packaged
- Minor: Two digits that represent the month when the app is packaged
- Build: A number that is incremented to represent significant changes to the app
- Revision: The incremented revision for a package

New versions of the application must completely replace previous versions of the app.

NEW QUESTION 74

DRAG DROP - (Topic 1)

You need to ensure that the app can support the needs of User2 and User3, and meets the production deployment requirements. Which tools should you use? To answer, select the appropriate tool in the answer area. NOTE: Each correct selection is worth one point.

Tools	Answer Area	
<div>Solution Checker</div> <div>App Checker</div> <div>Object Detector</div> <div>Preview the app</div>	Requirement	Tool
	Accessibility	<div>Tool</div>
	Deployment	<div>Tool</div>

- A. Mastered
B. Not Mastered

Answer: A

Explanation:

Box 1: App Checker

Scenario: Several sales representatives have accessibility restrictions. User2 is visually impaired and cannot see images. User3 is unable to use a mouse. Users who have vision, hearing, or other impairments can use your canvas app more easily and successfully if you consider accessibility as you design how the app looks and behaves. If you're not sure how to make your app more accessible, you can run the AppChecker Accessibility checker in Power Apps Studio.

Box 2: Solution Checker

Scenario: Before deploying the app to production, you must ensure that the app conforms to Microsoft accessibility and performance guidelines. Use solution checker to validate your model-driven apps in Power Apps.

NEW QUESTION 77

- (Topic 1)

You need to configure functionality for submitting status reports. What should you do?

- A. Determine whether the application is offline when a user selects submit button and call the Sec () function.
B. Determine whether the application is offline when the app load
C. Use the SaveDaca () function in the OnSelect property.
D. Determine whether the application is offline when a user selects the submit button and call the SaveDaca () function.
E. Determine whether the application is offline when the app load
F. Use the LoadDaca () function in the Submit button.

Answer: C

Explanation:

Scenario: The app must be able to run both online and offline. If the mobile device on which the app runs is connected to the internet, the app must immediately submit the status report.

When data is submitted offline, the data must be stored in the app until the app is back online.

Mobile users often need to be productive even when they have limited or no connectivity. LoadData and SaveData combine to form a simple mechanism to store small amounts of data on a local device. By using these functions, you can add simple offline capabilities to your app.

The SaveData function stores a collection for later use under a name.

The LoadData function reloads a collection by name that was previously saved with SaveData. You can't use this function to load a collection from another source.

Reference:

<https://docs.microsoft.com/en-us/powerapps/maker/canvas-apps/functions/function->

NEW QUESTION 78

- (Topic 1)

You need to provide the app to Tailwind Traders. What should you do?

- A. Within Managed Properties, set the value of the Allow customizations option to tru
B. Export the app as a managed solution.
C. Use the Share App feature.
D. Within Managed Properties, set the value of the Allow customizations option to fals
E. Export the app as a managed solution.
F. Within Managed Properties, set the value of the Allow customizations option to fals
G. Export the app as an unmanaged solution.

Answer: C

Explanation:

Scenario: The completed app and all supporting components must be provided to Tailwind Traders. Tailwind Traders must not be able to make changes to any of the components.

Managed Solution: A managed solution is a finalized solution that can be distributed and installed. They are created by exporting an unmanaged solution by setting restrictions to prevent any further customizations. The whole point of Managed is locking down the Component states so they cannot be edited. Deleting the Managed Solution will remove all its customisations as well as data contained. Managed Solutions become read only once deployed so they cannot be manipulated.

Reference:

<https://powerusers.microsoft.com/t5/Power-Apps-Pro-Dev-ISV/Managed-vs-Unmanaged/td-p/495685>

NEW QUESTION 82

- (Topic 4)

An automobile company uses Power Apps. The company uses a model-driven app to manage customers and repairs.

The Customer table has a custom column of type text named Best time to call. On the Repair form, employees require the Best time to call column to be displayed

next to the customer name.
You need to modify the model-driven app to display the Best time to call column.
Which two steps should you perform? Each correct answer presents part of the solution. NOTE: Each correct selection is worth one point.

- A. Add The Best time to call column to the quick view Repair form.
- B. Create a quick view form for the Repair table.
- C. Create a quick view form for the Customer table.

Answer: CD

NEW QUESTION 83

HOTSPOT - (Topic 4)
You are creating a Power Automate flow.
You have an array that contains items with different color attributes. You plan to filter the array by using the following filter expression within the flow:
@or(equals(item()['color'], 'red'),contains(item()['color'],'blue')) The filter returns results only when the expression resolves to true.
For each of the following statements, select Yes if the statement is true. Otherwise, select No.
NOTE: Each correct selection is worth one point.

Statements	Yes	No
The filter expression yields a result if the array contains the color orange	<input type="radio"/>	<input type="radio"/>
The filter expression yields a result if the array contains the color red	<input type="radio"/>	<input type="radio"/>
The filter expression yields a result if the array contains the color sky blue	<input type="radio"/>	<input type="radio"/>

- A. Mastered
- B. Not Mastered

Answer: A

Explanation:

Box 1: No
Box 2: Yes
The item color must be red, or item color contains blue. Box 3: Yes

NEW QUESTION 84

- (Topic 4)
A company uses Microsoft Power Platform. You create a solution with components You deploy the solution in the production environment Users report issues with a process. You open the last imported solution. You need to troubleshoot the issue. What should you view?

- A. Solution dependencies
- B. Solution classic view
- C. History

Answer: D

NEW QUESTION 86

HOTSPOT - (Topic 4)
A coworker creates a canvas app.
The canvas app contains the following formula. The formula is attached to the OnVisible property of the first screen that users see:

```
Collect(
Toolbox,
{
    Tool: "Hammer",
    Quantity: 1
},
{
    Tool: "Screwdriver",
    Quantity: 2
})
```

You are updating the canvas app.
For each of the following statements, select Yes if the statement is true. Otherwise, select No.
NOTE: Each correct selection is worth one point.

Answer Area	Yes	No
The formula will update multiple records in a data source named Toolbox if the records exist.	<input type="radio"/>	<input type="radio"/>
A local collection is created to store data if a data source named Toolbox does not already exist.	<input type="radio"/>	<input type="radio"/>
If a collection named Toolbox exists the formula will clear any existing records before making any changes.	<input type="radio"/>	<input type="radio"/>

- A. Mastered
B. Not Mastered

Answer: A

Explanation:

Box 1: No

Records are added, not updated.

Box 2: Yes

The Collect function adds records to a data source. Syntax: Collect(DataSource, Item, ...)

DataSource – Required. The data source that you want to add data to. If it doesn't already exist, a new collection is created.

Item(s) - Required. One or more records or tables to add to the data source.

Box 3: No

No records are cleared.

NEW QUESTION 90

HOTSPOT - (Topic 4)

A company creates a Power Apps app that allows service representatives to record information about on-site client visits. Service representatives perform a one-hour site visit with each client each quarter.

Service representatives use the app to perform the following activities:

? View their scheduled visits for the day.

? Record notes from service visits.

? Schedule service technicians for issues uncovered during site visits.

? Scan and upload service quote forms to a folder named Service Quote folder on

Microsoft OneDrive once the customer has signed a service quote.

Service quotes that are over \$10,000 are automatically sent to the service manager for review and approval.

Visits that are not closed at the end of the day are automatically moved to the following day unless it is the last day of the quarter. All client visits not performed for the quarter are escalated to the service manager for follow-up.

You need to create flows to meet the requirements.

Which type of flows should you use? To answer, select the appropriate options in the answer area.

NOTE: Each correct selection is worth one point.

Requirement	Type of flow
Move client visits not completed for the day.	<div><div></div><div>Scheduled flow</div><div>Automated flow</div><div>Adaptive card flow</div><div>Team flow</div></div>
Approve service quote.	<div><div></div><div>Automated flow</div><div>Button flow</div><div>Scheduled flow</div><div>Team flow</div></div>

- A. Mastered
B. Not Mastered

Answer: A

Explanation:

Box 1: Adaptive card flow

Adaptive Cards are a platform-agnostic method of sharing and displaying blocks of information without the complexity of customizing CSS or HTML to render them.

Directing content to Teams channels:

Post your own adaptive card as the Flow bot to a channel

This action posts an adaptive card as a Flow bot to a specific Teams channel. In this case, you will be prompted for Teams instance, and a channel where the card will be posted. The flow-maker will have to have access to the Teams instance in order to post an adaptive card there. In this case, only URL buttons function by redirecting to the URL configured within the flow.

Box 2: Button flow

Create a button flow to run routine tasks by simply tapping a button. Customize your flow by allowing the user to provide specific details that will be used when the

flow runs.

NEW QUESTION 95

DRAG DROP - (Topic 4)

A call center manager monitors incoming phone calls. The manager analyzes the performance of phone reps by using a custom view. The view contains a custom field named Phone call Duration in Minutes.

The call center manager must present an Excel spreadsheet daily to upper management. The spreadsheet must contain the call center performance for further trending analysis and corrective actions.

You need to create the spreadsheet.

Which four actions should you perform in sequence? To answer, move the appropriate actions from the list of actions to the answer area and arrange them in the correct order.

Actions

Create a pivot table, and then use the Phone call Duration in Minutes field as a category area and the Rep field as a series

Create a pivot table, and then use the Phone Rep field as a category and the Phone call Duration in Minutes field as a series

Set the formula for phone call duration in minutes to Average and add a pie chart linked the pivot table

Export the custom view to an Excel dynamic spreadsheet

Export the custom view to an Excel dynamic pivot table

Save the spreadsheet and upload it back to the system

Export the custom view to an Excel template

Answer Area

>

<

- A. Mastered
- B. Not Mastered

Answer: A

Explanation:

Timeline
Description automatically generated with low confidence
Step 1: Export the custom view to an Excel dynamic pivot table
You can export app data to an Office Excel PivotTable to see patterns and trends in data. An Excel PivotTable is a great way to summarize, analyze, explore, and present your app data.
Step 2: Create a pivot table, and then use the Phone Rep field as a category and the Phone call Duration in Minutes as field as series
Step 3: Set the formula for phone call duration in minutes to Average and add a pie chart linked to the pivot table
Step 4: Save the spreadsheet and upload it back to the system.

NEW QUESTION 97

DRAG DROP - (Topic 4)

You are design ng a dashboard for a model driven app Users are licensed to use Dynamics 365 Seles Professional

Users must be able to filter the dashboard. You need to determine how to apply the filters.

Which type of dashboard should you use? To answer, drag the appropriate dashboard types to the correct requirements. Each dashboard type may be used once, more than once, or not at all. You may need to drag the split bar between panes or scroll to view content.

NOTE: Each correct selection is worth one point.

Dashboard types

Standard

Interactive

Power BI embedded

Answer Area

Requirement

Filter all dashboard elements using a timeframe.

Display data from multiple tables and views.

Dashboard type

- A. Mastered
- B. Not Mastered

Answer: A

Explanation:

Dashboard types

Standard

Interactive

Power BI embedded

Answer Area

Requirement

Filter all dashboard elements using a timeframe.

Display data from multiple tables and views.

Dashboard type

Interactive

Standard

NEW QUESTION 100

- (Topic 4)

Note: This question is part of a series of questions that present the same scenario. Each question in the series contains a unique solution that might meet the stated goals. Some question sets might have more than one correct solution, while others might not have a correct solution.

After you answer a question in this section, you will NOT be able to return to it. As a result, these questions will not appear in the review screen.

You are developing a model-driven app that uses a Common Data Service database. App users will have a variety of different security roles.

Development and testing must be performed using production data. Multiple testers must be used at each testing stage.

You need to provision and configure new environments for development and testing. Solution:

? Provision sandbox environments named S1 and S2.

? Copy the production environment to both S1 and S2.

? Use S1 for development and S2 for testing.

Does the solution meet the goal?

A. Yes

B. No

Answer: A

Explanation:

A sandbox environment is any non-production environment of Microsoft Dataverse. Isolated from production, a sandbox environment is the place to safely develop and test application changes with low risk.

Reference:

<https://docs.microsoft.com/en-us/power-platform/admin/environments-overview>

NEW QUESTION 104

HOTSPOT - (Topic 4)

You are a technical assistant for a legal services organization. The company uses SharePoint to manage documents and Microsoft Dataverse as the data store.

The company has strict rules about access, permissions, and privacy.

Lawyers and paralegals use Microsoft Teams for communications and collaboration. Employees use personal devices to access legal files. You do not have access to the admin area in Microsoft Power Platform.

You need to ensure that these rules are observed consistently and managed in one place.

Which type of app should you create? To answer, select the appropriate options in the answer area.

NOTE: Each correct selection is worth one point.

Answer Area

Requirement	App type
Access client billing details	<div><div></div><div>Canvas app in Microsoft Teams Canvas app in SharePoint Model-driven app in SharePoint Model-driven app in Microsoft Teams</div></div>
Log phone calls and schedule appointments with clients and the team assigned to them	<div><div></div><div>Dynamics 365 App for Outlook Microsoft Teams calendar SharePoint calendar</div></div>

A. Mastered

B. Not Mastered

Answer: A

Explanation:

Box 1: Model-driven app in Microsoft Teams

A user's ability to see and use apps is controlled by sharing the application with the user. Sharing of canvas apps is done directly with a user or Azure AD group but is still subject to Dataverse security roles. Sharing of model-driven apps is done via Dataverse security roles.

Box 2: Sharepoint Calendar

NEW QUESTION 107

- (Topic 4)

Note: This question is part of a series of questions that present the same scenario. Each question in the series contains a unique solution that might meet the stated goals. Some question sets might have more than one correct solution, while others might not have a correct solution.

After you answer a question in this section, you will NOT be able to return to it. As a result, these questions will not appear in the review screen.

You build a canvas app for a manufacturing company. The company receives parts and materials from many vendors. You create a form to collect information from packing slips.

Receivers must be able to take a picture of packing slips to receive materials instead of manually entering data in the app.

You need to ensure that users can scan packing slip information into the form. Proposed solution: Use an Entity Extraction model.

Does the solution meet the goal?

A. Yes

B. No

Answer: B

Explanation:

AI Builder entity extraction models recognize specific data in the text that you target based on your business needs.

The model identifies key elements in the text and then classifies them into predefined categories. This can help you transform unstructured data into structured data that's machine-readable. You can then apply processing to retrieve information, extract facts, and answer questions.

Note: Create a canvas app and add the text recognizer AI Builder component to your screen. This component takes a photo or loads an image from the local

device, and then processes it to detect and extract text based on the text recognition prebuilt model. If it detects text in the image, the component outputs the text and identifies the instances by showing a rectangle for each instance in the image.

Reference:

<https://knowledgefrommanish.com/powerplatform/ai-builder-entity-extraction-ai-model/>

<https://docs.microsoft.com/en-us/ai-builder/prebuilt-text-recognizer-component-in-powerapps>

NEW QUESTION 111

- (Topic 4)

Note: This question is part of a series of questions that present the same scenario. Each question in the series contains a unique solution that might meet the stated goals. Some question sets might have more than one correct solution, while others might not have a correct solution.

After you answer a question in this section, you will NOT be able to return to it. As a result, these questions will not appear in the review screen.

A company is deploying Microsoft Power Platform components to streamline a job candidate screening process.

The human resources (HR) representatives of the company plan to attend school career fairs. The HR representatives must qualify and enter potential job candidates into a Power Apps app. The HR representatives must enter the following information for each candidate:

Field name	Data type	Criteria for follow up
Name	Text	No
Degree	Text	Yes
First available hire date	Date	Yes
Initial impression	Integer 0-10	Yes
Resume	Picture	No
Not currently viable	Boolean	Yes
Follow up	Boolean	NA

If a candidate is currently unqualified for a job position but would eventually qualify based on follow-up criteria, the follow-up checkbox must be selected or cleared in the system immediately.

The company plans to create a similar Power Apps app that will contain the same business use case, but for internal employees and promotions.

You need to create a Power Apps app solution to automatically mark the candidate for follow up.

Proposed solution: Create a business rule on the appropriate data entity with a scope of entity.

Does the solution meet the goal?

A. Yes

B. No

Answer: B

Explanation:

Instead use Common Data Service workflow with a PowerQuery on the data entity.

Note: Process (Workflow) table/entity reference is a set of logical rules that define the steps necessary to automate a specific business process, task, or set of actions to be performed. Common Data Service workflow support: Filter triggers based on which attributes change - You can control which field changes trigger your automated flows. For example, trigger your flow only when the status field changes while ignoring all other fields that may change.

Reference:

<https://docs.microsoft.com/en-us/business-applications-release-notes/april19/microsoft->

NEW QUESTION 114

DRAG DROP - (Topic 4)

You create the following apps for a company that provides financial guidance services: a model-driven app for financial advisers that work in the company's offices and a canvas app for remote financial advisers.

You need to create business rules for a custom counselling entity used by all financial advisers.

Who will be affected by the business rules?

To answer, drag the appropriate financial adviser types to the correct business rules. Each financial adviser type may be used once, more than once, or not at all.

You may need to drag the split bar between panes or scroll to view content.

NOTE: Each correct selection is worth one point.

Financial adviser types	Answer Area								
Office-based financial advisers only	<table border="1"> <thead> <tr> <th>Business rule</th> <th>Financial adviser type</th> </tr> </thead> <tbody> <tr> <td>Set a field value with the scope set to Entity</td> <td>Financial adviser type</td> </tr> <tr> <td>Clear a field value with the scope set to All Forms</td> <td>Financial adviser type</td> </tr> <tr> <td>Set visibility of a field with the scope set to Entity</td> <td>Financial adviser type</td> </tr> </tbody> </table>	Business rule	Financial adviser type	Set a field value with the scope set to Entity	Financial adviser type	Clear a field value with the scope set to All Forms	Financial adviser type	Set visibility of a field with the scope set to Entity	Financial adviser type
Business rule	Financial adviser type								
Set a field value with the scope set to Entity	Financial adviser type								
Clear a field value with the scope set to All Forms	Financial adviser type								
Set visibility of a field with the scope set to Entity	Financial adviser type								
Remote financial advisers only									
Office-based and remote financial advisers									

A. Mastered

B. Not Mastered

Answer: A

Explanation:

Box 1: Office-based and remote financial advisers

Model driven apps can use all actions available on business rules, however not all business rule actions are available for canvas apps at this time.

Box 2: Office-based financial advisers only

If you're building a Canvas app, you must use table as the scope (not All forms, not a specific form)

Box 3: Office-based financial advisers only
The following actions are not available on Canvas apps :
Show or hide columns Enable or disable columns
Create business recommendations based on business intelligence.

NEW QUESTION 119

- (Topic 4)

You create a new solution publisher and include a publisher prefix value.
Which two actions can you perform? Each correct answer presents a complete solution.
NOTE: Each correct selection is worth one point.

- A. You can change contact details of a publisher after you create the publisher
- B. When you change a solution publisher prefix, you can change the schema name for existing components
- C. You can change the schema name of a publisher after creating the publisher
- D. You can add a component from one solution to another solution that has a different publisher

Answer: AD

Explanation:

Once you introduce a publisher for a component in a managed solution, you can't change the publisher for the component.

Reference:

<https://docs.microsoft.com/en-us/power-platform/alm/solution-concepts-alm#solution-publisher>

NEW QUESTION 124

- (Topic 4)

In a Common Data Service database, you create a canvas app and a custom entity. The app also reads data from the Account entity in the Common Data Service database. Entity access permissions will be controlled by the Common Data Service User security role. You create a Common Data Service solution. You need to replicate the changes to a new Common Data Service database. Which two components should you include with the canvas app? Each correct answer presents part of the solution. NOTE: Each correct selection is worth one point.

- A. Custom entity
- B. Account entity
- C. Common Data Service User security role
- D. Sitemap

Answer: BC

NEW QUESTION 129

- (Topic 4)

An inside sales staff uses three model-driven apps for their sales process. Each app includes the same custom specialized component. You must standardize the inside and outside sales process by creating a canvas app that has the same functionality as the three model-driven apps. You do not have administrator permissions. You need to incorporate the logic of the custom component in the outside sales canvas app. Where should you build the custom component?

- A. Custom control
- B. Component library
- C. Any of the three apps
- D. Solution

Answer: B

NEW QUESTION 133

HOTSPOT - (Topic 4)

You create a Power Automate cloud flow that runs when a user creates a Microsoft Dataverse lead record. The cloud flow must update a custom score column on the lead record based on other column values. The flow must perform the following activities:

- Update the Microsoft Dataverse record.
- Evaluate whether the Microsoft Dataverse record should be updated. You need to configure the flow components.

Which components should you use? To answer, select the appropriate options in the answer area.
NOTE: Each correct selection is worth one point.

Answer Area

Requirement

Update the Microsoft Dataverse record.

Evaluate whether the Microsoft Dataverse record should be updated.

Component

Action
Action
Trigger
Function

Condition
Action
Condition
Data operation

- A. Mastered
- B. Not Mastered

Answer: A

Explanation:

Answer Area

Requirement

Update the Microsoft Dataverse record.

Evaluate whether the Microsoft Dataverse record should be updated.

Component

Action

Condition

NEW QUESTION 137

DRAG DROP - (Topic 4)

You are creating entities in a Common Data Service database to capture sales data. You create an entity named Sales that includes the following fields:

Field	Description
SalesPerson	The name of the salesperson who made the sale
Quantity	The number of units sold
Rate	The sale price per unit
GrossAmount	A value obtained by multiplying the Quantity times the Rate. This value is for display purposes only
DiscountAmount	An amount that a salesperson enters into the app to discount a sale
NetAmount	A value obtained by subtracting the DiscountAmount from the GrossAmount

You create a new entity that includes a field named TotalSales. The field is used to capture the aggregated sales for each salesperson.

You need to configure the fields for the entities.

Which field types should you use? To answer, drag the appropriate field types to the correct field names. Each field type may be used once, more than once, or not at all. You may need to drag the split bar between panes or scroll to view content.

NOTE: Each correct selection is worth one point.

Field types

Rollup

Calculated

Simple

Answer Area

Field name

GrossAmount

DiscountAmount

TotalSales

Field type

Field type

Field type

- A. Mastered
- B. Not Mastered

Answer: A

Explanation:

Box 1: Calculated

Calculated columns are calculated in real-time when they are retrieved. Calculated columns can be composed using different data types. For example, an Integer calculated column may reference values from Decimal or Currency columns.

Box 2: Simple

A simple column isn't defined as a calculated or rollup column.

Box 3: Rollup

Because rollup columns persist in the database, they can be used for filtering or sorting just like regular columns.

NEW QUESTION 142

DRAG DROP - (Topic 4)

You store data about products in two Microsoft Excel worksheets. The data contains duplicate rows.

You need to consolidate data from the two worksheets into a Microsoft Dataverse custom table.

In which order should you perform the actions? To answer, move all actions from the list of

Actions

Upload the worksheets to OneDrive

Add conditional columns to perform checks on the data

Create queries for the worksheets

Append the output from the queries

Create a dataflow

Answer Area

>

<

- A. Mastered
B. Not Mastered

Answer: A

Explanation:

Step 1: Upload the worksheets to OneDrive

A data source needs to be specified. The data needs to be available. Step 2: Create a dataflow

Step 3: Create queries for the worksheets

You can shape your data selection into a form that works best for your table using a Power Query editing experience, similar to the Power Query Editor in Power BI Desktop.

Step 4: Add conditional columns to perform checks on the data Step 5: Append the output of the queries

NEW QUESTION 147

- (Topic 4)

Note: This question is part of a series of questions that present the same scenario. Each question in the series contains a unique solution that might meet the stated goals. Some question sets might have more than one correct solution, while others might not have a correct solution.

After you answer a question in this section, you will NOT be able to return to it. As a result, these questions will not appear in the review screen.

A company has locations in multiple countries and regions across four continents. The company stores the total amount of each order in the local currency of the country/region where the customer is located. The company stores the applicable exchange rates in a custom US dollars (USD) exchange rate table.

You need to create a visualization that displays the total amount of orders by country/region in USD.

Proposed solution:

Create a custom rollup field of type currency on the country/region table that aggregates all the total amounts for the orders from that country/region and display this rollup field in a Power BI chart.

Does the solution meet the goal?

- A. Yes
B. No

Answer: B

Explanation:

Instead use a calculated field.

Need to calculate the exchange rate in USD.

Calculated columns are calculated in real-time when they are retrieved. Reference:

<https://docs.microsoft.com/en-us/powerapps/developer/data-platform/calculated-rollup-attributes>

NEW QUESTION 149

- (Topic 4)

You are creating a canvas app for a company that delivers packages. The app will display one screen for each delivery attempt.

Drivers must make three attempts to deliver a package before returning the package back to a warehouse. Drivers must enter details about delivery on a second screen in the app.

You need to display a list of delivery attempts on the delivery screen.

Which two components can you add to the app to display details about the delivery attempts? Each correct answer presents a complete solution.

NOTE: Each correct selection is worth one point.

- A. Data table
B. Vertical gallery
C. Display form
D. Drop-down

Answer: AC

Explanation:

The Data table control shows a dataset.

In a canvas app, add and configure a Display form control to show all fields in a record. Reference:

<https://docs.microsoft.com/en-us/powerapps/maker/canvas-apps/controls/control-data-table> <https://docs.microsoft.com/en-us/powerapps/maker/canvas-apps/working-with-form-layout>

NEW QUESTION 152

- (Topic 4)

Note: This question is part of a series of questions that present the same scenario. Each question in the series contains a unique solution that might meet the stated goals. Some question sets might have more than one correct solution, while others might not have a correct solution.

After you answer a question in this section, you will NOT be able to return to it. As a result, these questions will not appear in the review screen.

You are creating a canvas app.

You need to automatically detect bicycles in pictures taken with the camera.

Proposed solution:

- ? Create a Category Classification custom model in AI Builder.
- ? Train the model with pictures of bicycles and then publish the trained model.
- ? Add the Object Detector control to your canvas app.

Does the solution meet the goal?

- A. Yes
- B. No

Answer: B

Explanation:

Instead create an Object Detection custom model Reference:
<https://docs.microsoft.com/en-us/ai-builder/prediction-overview> <https://docs.microsoft.com/en-us/ai-builder/object-detector-component-in-powerapps>

NEW QUESTION 155

DRAG DROP - (Topic 4)

You have an existing Power Apps environment.

You need to create a Common Data Service database for the environment.

Which three actions should you perform in sequence? To answer, move the appropriate actions from the list of actions to the answer area and arrange them in the correct order.

Actions

Select Create my database

Configure currency and language settings

Configure database collation settings

Set the environment type to **Production**

Select an existing environment

Answer Area

- A. Mastered
- B. Not Mastered

Answer: A

Explanation:

Step 1: Select an existing environment Add a database in the admin center:

- * 1. In the admin center, in the left navigation pane, select Environments.
- * 2. Select the environment to which you want to add the database.

Step 2: Select Create my database

- * 3. Select + Add database

Step 3: Configure currency and language settings

- * 4. Enter the following, and then select Add.

Setting	Description
Language	The default language for this environment.
Currency	The base currency used for reporting.
Enable Dynamics 365 apps	Select Yes and make a selection to automatically deploy apps such as Dynamics 365 Sales and Dynamics 365 Customer Service.
Deploy sample apps and data	Select Yes to include sample apps and data. Sample data gives you something to experiment with as you learn. You must select No for Enable Dynamics 365 apps for this setting to appear.
Security group	Select a security group to restrict access to this environment.

NEW QUESTION 158

- (Topic 4)

Note: This question is part of a series of questions that present the same scenario. Each question in the series contains a unique solution that might meet the stated goals. Some question sets might have more than one correct solution, while others might not have a correct solution.

After you answer a question in this section, you will NOT be able to return to it. As a result, these questions will not appear in the review screen.

You are creating a canvas app.

You need to automatically detect bicycles in pictures taken with the camera. Proposed solution:

? Create an Object Detection custom model in AI Builder.

? Train the model with pictures of bicycles and then publish the trained model.

? Add the Object Detector control to your canvas app.

Does the solution meet the goal?

A. Yes

B. No

Answer: A

Explanation:

To train an object detection model to recognize your objects, you have to gather images that contain those objects.

The first thing you'll do when you create an AI Builder object detection model is to define its domain.

Upload images

Then Train and publish your object detection model

The object detector component takes a photo or loads an image file to do an object detection scan. On a mobile device, the user chooses between taking a photo or selecting one already available in the device user interface. When an image is selected, the component automatically scans it to identify objects.

Reference:

<https://docs.microsoft.com/en-us/ai-builder/prediction-overview> <https://docs.microsoft.com/en-us/ai-builder/object-detector-component-in-powerapps>

NEW QUESTION 159

HOTSPOT - (Topic 4)

A company uses Microsoft Power Platform. The company categorizes customers into Specialty shop, Grocery store, Wholesaler, and Seasonal market groups by using a custom choice type column.

The staff uses a model-driven app with an interactive dashboard that displays all customer

You must update the app to provide the following functionality:

- Display selected customers by type in the interactive dashboard.

- Search for customers across multiple tables by postal code by entering any number of characters.

You need to configure the system.

Which configuration options should you use? To answer, select the appropriate options in the answer area.

NOTE: Each correct selection is worth one point.

Answer Area

Requirement	Configuration
Display customers by type.	<div>Enable sync with global choice. <input checked="" type="checkbox"/></div> <div>Enable the global filter. <input type="checkbox"/></div> <div>Enable the searchable property. <input type="checkbox"/></div> <div>Enable sync with global choice. <input checked="" type="checkbox"/></div> <div>Enable the sortable property. <input type="checkbox"/></div>
Search by postal code.	<div>Enable the searchable property. <input checked="" type="checkbox"/></div> <div>Find by setting in quick find. <input type="checkbox"/></div> <div>Filter by setting in quick find. <input type="checkbox"/></div> <div>Enable the searchable property. <input checked="" type="checkbox"/></div> <div>Enable the global filter on the postal code. <input type="checkbox"/></div>

A. Mastered

B. Not Mastered

Answer: A

Explanation:

Answer Area

Requirement	Configuration
Display customers by type.	<div>Enable sync with global choice. <input checked="" type="checkbox"/></div> <div>Enable the global filter. <input type="checkbox"/></div> <div>Enable the searchable property. <input type="checkbox"/></div> <div>Enable sync with global choice. <input checked="" type="checkbox"/></div> <div>Enable the sortable property. <input type="checkbox"/></div>
Search by postal code.	<div>Enable the searchable property. <input checked="" type="checkbox"/></div> <div>Find by setting in quick find. <input type="checkbox"/></div> <div>Filter by setting in quick find. <input type="checkbox"/></div> <div>Enable the searchable property. <input checked="" type="checkbox"/></div> <div>Enable the global filter on the postal code. <input type="checkbox"/></div>

NEW QUESTION 162

DRAG DROP - (Topic 4)

You have a canvas app that uses multiple inputs for calculations.

You must use Test Studio to create automated tests and confirm that the app works as expected.

You need to organize your test scenarios into a hierarchy.

In which order should you create the objects? To answer, move the appropriate actions from the list of actions to the answer area and arrange them in the correct order.

Actions

Answer Area

Test assertions

Test steps

Test suites

Test cases



- A. Mastered
B. Not Mastered

Answer: A

Explanation:

Step 1: Test suites

By default, a test suite and test case are created for you in Test Studio. Test suites are used to organize your test cases. An app can contain one or more test suites.

Step 2: Test cases

Depending on how you want to organize or group your tests, you can create multiple test cases in a test suite. Each case can test a specific feature or a subset of functionalities in your app.

Step 3: Test steps Step 4: Test assertions

A test case consists of test steps that contain actions. Test actions are written using Power

Apps expressions that perform a task. You can use the recorder to automatically generate the test steps as you interact with your app. After you record, you can update the test case, add new steps, delete steps, and write test assertions to validate the result of your test.

NEW QUESTION 164

- (Topic 4)

You are an app maker.

You want to create apps and track customizations as part of the default solution. You need to determine the impact of performing the work in the default solution. What should you conclude?

- A. The default solution does not contain all components and customizations from all solutions in the environment.
B. The prefix used when creating components as part of the default solution can be set to a specific value.
C. The default solution cannot be exported and distributed to another environment.

Answer: C

Explanation:

Default Solution. This is a special solution that contains all components in the system. The default solution is useful for discovering all the components and configurations in your system.

Why you shouldn't use the default solutions to manage customizations

There are a few reasons why you shouldn't create apps and make customizations in either of the default solutions:

? The default solution can't be exported; therefore, you can't distribute the default solution to another environment.

The default solution contains all components and customizations from all solutions in the environment.

By default, all enabled users can create apps and customize components in the Common Data Services Default Solution.

It's difficult to locate or identify the customizations you've made in the environment by using either default solution.

When you use either default solution to create components, you'll also use the default publisher assigned to the solution. This often results in the wrong publisher prefix being applied to some components.

Reference:

<https://docs.microsoft.com/en-us/power-platform/alm/use-solutions-for-your-customizations>

NEW QUESTION 167

HOTSPOT - (Topic 4)

HOTSPOT

You are designing edit forms to display individual records selected from a list in a canvas app.

The control layout must respond to a variety of screen sizes and orientations that demonstrate the following behaviors:

- Automatically resize and arrange controls from top to bottom
- Maintain the original position of the controls.
- Require no additional property changes. You need to select the layout type.

Which layouts should you use? To answer, select the appropriate options in the answer area.

Answer Area

Behavior

Automatically resize and arrange controls from top to bottom.

Maintain the original position of the controls.

Layout

Vertical container

Vertical gallery

Horizontal gallery

Vertical container

Horizontal container

Container

Container

Blank vertical gallery

Flexible height gallery

Section

- A. Mastered
- B. Not Mastered

Answer: A

Explanation:

Answer Area

Behavior

Automatically resize and arrange controls from top to bottom.

Maintain the original position of the controls.

Layout

Vertical container

Vertical gallery

Horizontal gallery

Vertical container

Horizontal container

Container

Container

Blank vertical gallery

Flexible height gallery

Section

NEW QUESTION 169

HOTSPOT - (Topic 4)

Rangers in national parks report wildlife they encounter during patrols. The rangers record observations in a notebook when they are on patrol. The rangers manually enter observation data when they are in the office. You are designing an app that allows rangers to record their observations while they are on patrol. The wildlife is modeled as a custom table named Wildlife. The model has relationships to the annotation entity and to a custom entity named Wildlife Details. In the Wildlife Details entity, rangers capture more information as they observe an animal's habitat. When observing wildlife, rangers must indicate whether an animal requires medical attention. The app must synchronize and save data to Common Data Service when connectivity is available.

You need to design the app.

What should you do? To answer, select the appropriate options in the answer area.

NOTE: Each correct selection is worth one point.

Requirement	Action
Enter notes related to wildlife records.	<div><div>Enable the Wildlife entity and annotation entity for mobile offline.</div><div>Enable the attachments entity and the annotation entity for mobile offline.</div><div>Enable the Wildlife entity for mobile offline and enable attachments on the Wildlife entity.</div><div>Enable the Wildlife entity for mobile offline and use the timeline control for the Wildlife form.</div></div>
Enter wildlife details as related records.	<div><div>Allow feedback on the Wildlife Details entity.</div><div>Enable the Wildlife Details entity for mobile offline.</div><div>Enable change tracking on the Wildlife Details entity.</div><div>Enable attachments on the Wildlife Details entity and enable the Wildlife Details entity for mobile offline.</div></div>
Indicate that an animal requires medical attention.	<div><div>Create a business rule.</div><div>Create a business process.</div><div>Create a Power Automate flow.</div></div>

- A. Mastered
- B. Not Mastered

Answer: A

Explanation:

Box 1: Enable the Wildlife entity and the annotation entity for mobile offline

Note: As part of the 2020 Wave 2 release, we made generally available offline capabilities for model driven apps for users of Power Apps. Makers and administrators can now configure apps to be available offline on a user's device, and users can continue to complete their tasks against the local cache on their phone even with intermittent or no network connectivity. When the network is re-established, the users' changes are seamlessly synchronized back to the cloud.

Box 2: Enable attachments on the Wildlife Details entity and enable Wildlife Details entity for mobile offline.

Box 3: Create a business process.

Business process flows. Ensure that people enter data consistently and follow the same steps every time they work in an app by creating a business process flow.

Note: Power Automate includes several types of processes, each designed for a different purpose:

? Automated flows. Create a flow that performs one or more tasks automatically

? Button flows.

? Scheduled flows. Create a flow that performs one or more tasks on a schedule such as once a day, on a specific date, or after a certain time.

? Business process flows. Ensure that people enter data consistently and follow the same steps every time they work in an app by creating a business process flow.

? Workflows and actions. Dynamics 365 customizers may be familiar with the classic Microsoft Dataverse processes, which are workflows and actions.

NEW QUESTION 173

- (Topic 4)

A company stores financial files in Microsoft SharePoint document libraries. When a user uploads a new file, the user's manager must approve the request. You need to design a cloud flow to meet The requirement.

Which three actions should you use? Each correct answer presents part of the solution. NOTE: Each correct selection is worth one point.

- A. When a file is created trigger
- B. Get direct reports action
- C. Wait for an approval action
- D. When an item or a file is modified trigger
- E. When an item is created trigger
- F. Assign manager action
- G. Start and wait for an approval action
- H. Get manager action

Answer: AFG

NEW QUESTION 175

- (Topic 4)

You work in a warehouse. You build an app for physical inventory counts that is used by different staff members. The typical count takes 14 hours.

The app has a warehouse screen with a gallery that contains the aisles in the warehouse. When a staff member selects an aisle record, another screen displays all the items stored in that aisle. The staff must know how long each aisle takes to do a physical inventory count.

You need to add logic to the app. What should you do?

- A. Configure a timer control, add it to the aisle screen, and then reset it when exiting the aisle screen
- B. Create and configure a stopwatch custom control, and then add it to the gallery
- C. Create and configure a stopwatch custom component, and then add it to the aisle screen
- D. Configure a timer control, add it to the gallery, and then reset it when the selection changes

Answer: C

Explanation:

Reference:

<https://www.cdata.com/kb/tech/azuredatalake-odata-powerapps.rst>

NEW QUESTION 179

- (Topic 4)

You create an automated flow by using Power Automate. The flow appears under My Flows and is connected to the development environment. The development environment has a solution to move components into a production environment.

You need to ensure that you can transfer the flow to another environment. What should you do?

- A. Add the flow to the default solution of the development environment and export as a managed solution.
- B. Change the environment for the flow.
- C. Add the flow to the existing solution.
- D. Add the flow to the default solution of the production environment.

Answer: A

Explanation:

It is very normal for a developer to build the power automate in one environment and then export that automate & import it to another destination environment.

Exporting our Solution

After validating our flows work in our test environment, we now want to promote it to our production environment. We can export our solution by finding it in our Solutions experience, clicking on the ..., selecting Export.

Reference:

<https://flow.microsoft.com/en-us/blog/solutions-in-microsoft-flow/>

NEW QUESTION 180

- (Topic 4)

A company creates multiple cases in Microsoft Dataverse each day with a status of New.

For all cases with a status of New, the system must send an email to the customer and then change the status to in Process.

You need to create a Microsoft Power Automate cloud flow to automatically send the email. What should you do?

- A. Trigger the flow on a schedule and then configure the flow to use the Compose data operation to get a list of cases and send email to each from inside a loop.
- B. Trigger the flow on a schedule and then configure the flow to use the Dataverse Listrows action to query case records using a filter and send email to each from inside a loop.
- C. Trigger the flow manually on the case and then configure the flow to send the email.

Answer: B

NEW QUESTION 181

HOTSPOT - (Topic 4)

A state planning department stores demographic data in a local SQL Server database.

The department uses a local report server to analyze the data for land development purposes.

You need to create a visual to display the demographic data.

Which component should you use? To answer, select the appropriate option in the answer area.
NOTE: Each correct selection is worth one point.

Answer Area

Requirement

Visual control.

Mandatory data for the visual control.

Component

Filled map

Filled map

Shape map

ArcGIS map

Latitude and Longitude

Location

Latitude and Longitude

Data Category

- A. Mastered
- B. Not Mastered

Answer: A

Explanation:

Answer Area

Requirement

Visual control.

Mandatory data for the visual control.

Component

Filled map

Filled map

Shape map

ArcGIS map

Latitude and Longitude

Location

Latitude and Longitude

Data Category

NEW QUESTION 183

DRAG DROP - (Topic 4)

A company uses Power Automate.

The company requires three cloud flows for the following:

- Send email notifications to a team member after an expense request is approved.
- If a document is uploaded to OneDrive. forward the document as an email attachment.
- Send an email at 4:00 PM on Fridays to remind team members to submit timesheets. You need to create the cloud flows.

Which cloud flow types should you create? To answer, drag the appropriate cloud flows to the correct activities. Each cloud flow may be used once, more than once, or not at all. You
NOTE: Each correct selection is worth one point.

Cloud flows

Automated

Scheduled

Instant

Answer Area

Activity

Send notifications after expense request approvals.

Forward new OneDrive documents as attachments.

Send timesheet reminder emails at 4:00 PM on Fridays.

Cloud flow

- A. Mastered
- B. Not Mastered

Answer: A

Explanation:

Cloud flows

Automated

Scheduled

Instant

Answer Area

Activity

Send notifications after expense request approvals.

Forward new OneDrive documents as attachments.

Send timesheet reminder emails at 4:00 PM on Fridays.

Cloud flow

Instant

Automated

Scheduled

NEW QUESTION 188

- (Topic 4)

A company uses Microsoft Teams. A coworker creates a chatbot. The coworker observes unexpected behavior with the chatbot. You need to troubleshoot the chatbot.

Which two actions should you recommend to the coworker? Each correct answer presents part of the solution.

NOTE: Each correct selection is worth one point.

- A. Ask the coworker to assign you to the owner role for the team.
- B. In Advanced tools, select Monitor.
- C. Ask the coworker to add you to their team.
- D. Select the chatbot and then select the Share button.

Answer: AB

NEW QUESTION 192

- (Topic 4)

DRAG DROP

A company uses Power Apps and Microsoft Dataverse.

The company has three solutions that you must move to a target environment:

- One solution is created for security roles. You must be able to add roles to the solution in the target environment
- One solution is created for table additions and modifications. Table structures must be updated in the solution in the target environment.
- One solution is for customizations. The custom actions must not be modified in the solution in the target environment

You need to create the solutions.

Which type of solutions should you create? To answer, drag the appropriate solutions to the correct requirements- Each solution may be used once, more than once, or not at all You may need to drag the split bar between panes or scroll to view content.



- A. Mastered
- B. Not Mastered

Answer: A

Explanation:



NEW QUESTION 197

- (Topic 4)

You are developing a canvas app to monitor time. The app includes a Text Input control named TIC1 and a Timer control named TIM1.

You need to set TIM1 to a default value. What should you do?

- A. In the OnChange property of TIC1, set the value of the Text property for TIC1 to a context variable that stores the duration value
- B. Assign the value of the variable to the OnTimerStart property for TIM1.
- C. Assign the Text property of TIC1 to the Duration property of TIM1.
- D. Assign the Text property of TIC1 to the OnSelect property of a TIM1.
- E. Write code in the OnChange property of TIC1 that assigns the value of the Duration property of the Timer control to Text property of the TIC1. In the OnChange property of TIC1, assign the value to the Duration property for TIM1.

Answer: C

Explanation:

The OnTimerStart, OnTimerEnd and OnSelect are the configurations where you can add your code.

Reference:

<https://sharepains.com/2019/08/22/all-about-timers-in-powerapps/>

NEW QUESTION 201

DRAG DROP - (Topic 4)

You are configuring a new Common Data Service environment by using the Power Apps Maker portal.

You need to create an entity that uses the prefix xyz.

Which four actions should you perform in sequence? To answer, move the appropriate actions from the list of actions to the answer area and arrange them in the correct order.

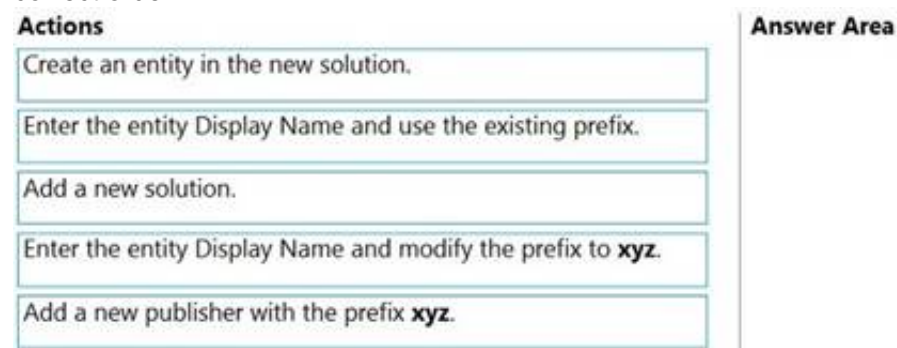

- A. Mastered
- B. Not Mastered

Answer: A

Explanation:

Actions

Create an entity in the new solution.

Enter the entity Display Name and use the existing prefix.

Add a new solution.

Enter the entity Display Name and modify the prefix to **xyz**.

Add a new publisher with the prefix **xyz**.

Answer Area

Add a new publisher with the prefix **xyz**.

Add a new solution.

Create an entity in the new solution.

Enter the entity Display Name and modify the prefix to **xyz**.

NEW QUESTION 205

DRAG DROP - (Topic 4)

An insurance broker uses a Microsoft Dataverse environment with custom tables. You create a Power Apps app to manage vehicle insurance policies.

The app has a drop-down field that allows users to categorize a policy holder's driving record. This category field is not mandatory.

You need to ensure that insurance agents enter the correct categories when creating a new vehicle policy.

Which three actions should you perform in sequence? To answer, move the appropriate actions from the list of actions to the answer area and arrange them in the correct order.

Actions

In the vehicle policy table, click on Add subcomponents and navigate to Business rules.

Add a Recommendation card, select the driver record drop-down field and enter the recommendation details.

In the vehicle policy table, navigate to Business rules.

Add a business rule and enter a meaningful business rule name.

Click on the Condition card, select the Vehicle Policy and check for new driver.

Answer area

A. Mastered
B. Not Mastered

Answer: A

Explanation:

Actions

In the vehicle policy table, click on Add subcomponents and navigate to Business rules.

Add a Recommendation card, select the driver record drop-down field and enter the recommendation details.

Answer area

1 In the vehicle policy table, navigate to Business rules.

2 Add a business rule and enter a meaningful business rule name.

3 Click on the Condition card, select the Vehicle Policy and check for new driver.

NEW QUESTION 206

DRAG DROP - (Topic 4)

You create a custom field on the Account entity.

Members of TeamA must have full access to the field. Members of TeamB must have no access to the field.

You need to configure security.

Which three actions should you perform in sequence? To answer, move the appropriate actions from the list of actions to the answer area and arrange them in the correct order.

Actions

Add TeamA to the field security profile.

Create a field security profile and set all the permissions for the custom attribute to **Yes**.

Add TeamB to the field security profile.

Create a field security profile and set all the permissions for the custom attribute to **No**.

Enable field-level security for the field.

Answer Area

A. Mastered
B. Not Mastered

Answer: A

Explanation:

Step 1: Enable field security for the field

Step 2: Create a field security profile and set all the permissions for the custom attribute to Yes.

Your Partner of IT Exam

visit - <https://www.examible.com>

Step 3: Add TeamA to the field security profile.

Note: Field-level security is available for the default fields on most out-of-box entities, custom fields, and custom fields on custom entities. Field-level security is managed by the security profiles. To implement field-level security, a system administrator performs the following tasks.

? Enable field security on one or more fields for a given entity.

? Associate one more existing security profiles, or create one or more new security profiles to grant the appropriate access to specific users or teams.

NEW QUESTION 209

DRAG DROP - (Topic 4)

DRAG DROP

You are Designing a Power Virtual Agents chatbot in Microsoft Teams. You create an outline to describe how a conversation should be structured.

You need to configure the chatbot.

Which chatbot component should you use? To answer, drag the appropriate components to the correct conversation elements. Each component may be used once, more than once, or not at all. You may need to drag the spirt bar between panes or scroll to view content.

NOTE: Each correct selection is worth one point.



A. Mastered

B. Not Mastered

Answer: A

Explanation:



NEW QUESTION 210

- (Topic 4)

You create a personal view.

You need to ensure that other users can access the view. What should you do?

A. Email the users a link to the view.

B. Set the view as the default view.

C. Share the view with the users.

D. Assign the view to the users.

Answer: C

NEW QUESTION 213

- (Topic 4)

Note: This question is part of a series of questions that present the same scenario. Each question in the series contains a unique solution that might meet the stated goals. Some question sets might have more than one correct solution, while others might not have a correct solution.

After you answer a question in this section, you will NOT be able to return to it. As a result, these questions will not appear in the review screen.

A company is deploying Microsoft Power Platform components to streamline a job candidate screening process.

The human resources (HR) representatives of the company plan to attend school career fairs. The HR representatives must qualify and enter potential job candidates into a Power Apps app. The HR representatives must enter the following information for each candidate:

Field name	Data type	Criteria for follow up
Name	Text	No
Degree	Text	Yes
First available hire date	Date	Yes
Initial impression	Integer 0-10	Yes
Resume	Picture	No
Not currently viable	Boolean	Yes
Follow up	Boolean	NA

If a candidate is currently unqualified for a job position but would eventually qualify based immediately.

The company plans to create a similar Power Apps app that will contain the same business use case, but for internal employees and promotions.

You need to create a Power Apps app solution to automatically mark the candidate for follow up.

Proposed solution: Create a custom action that has defined dataflows.

Does the solution meet the goal?

- A. Yes
B. No

Answer: B

Explanation:

Instead use Common Data Service workflow with a PowerQuery on the data entity.

Note: Process (Workflow) table/entity reference is a set of logical rules that define the steps necessary to automate a specific business process, task, or set of actions to be performed. Common Data Service workflow support: Filter triggers based on which attributes change - You can control which field changes trigger your automated flows. For example, trigger your flow only when the status field changes while ignoring all other fields that may change.

Reference:

<https://docs.microsoft.com/en-us/business-applications-release-notes/april19/microsoft-flow/automated-parity-classic-common-data-service-workflows>

NEW QUESTION 216

- (Topic 4)

You are creating an employee directory canvas app. The app must display name, address, and a photo of each employee. You need to select a control type that will display the

- A. Address input
B. List box
C. Gallery
D. Data table

Answer: C

NEW QUESTION 221

HOTSPOT - (Topic 4)

A company is building a Power Apps app to track key project tasks.

Users assign tasks a risk status on a scale of 0 to 100 by using a slider input control named RiskStatus on the app. The highest risks use the risk status value of 100.

For each task, the user selects a button named RiskLevel to send the name of the task and RiskStatus number to key project stakeholders. The color of the button must change to the color listed in the following table based on the value of the RiskStatus control. The default color for the button is green.

RiskStatus slider value	Risk description	RiskLevel button color
0–50	No/Low risk	Green
51–100	High risk	Red

You need to configure the solution to change the color of the RiskLevel button.

How should you configure the app? To answer, select the appropriate options in the answer area.

NOTE: Each correct selection is worth one point.

Question	Response
Where do you enter the formula to change the button color?	<div> <input type="text"/> </div> <div> <input type="text"/> On the RiskStatus slider. <input type="text"/> On the RiskLevel button. <input type="text"/> In the variables of the Power Apps app. <input type="text"/> On the OnStart property of the Power Apps app. </div>
Which formula should you use?	<div> <input type="text"/> </div> <div> <input type="text"/> If (RiskStatus.Value > 75) (return Red;) <input type="text"/> If (RiskStatus.Value > 75, Red, Green) <input type="text"/> If (RiskStatus.Value > 75 ? Red : Green) <input type="text"/> RiskLevel.Fill = RiskStatus.Value > 75 ? Red : Green; </div>

- A. Mastered
B. Not Mastered

Answer: A

Explanation:

Box 1: On the RiskLevel button.

On the RiskLevel button fill property.

Box 2: Risklevel.Fill = RiskStatus.Value > 75 ? Red : Green;

Most every type of control in a Power App, has a Fill property, for the fill color.

NEW QUESTION 226

- (Topic 4)

A company uses Microsoft platforms for all accessibility, compliance, and security auditing.

The auditing and compliance division of the company flags a newly created Power Apps canvas app due to accessibility issues. The app must be unpublished until it conforms to Microsoft accessibility requirements and recommendations.

You need to identify all accessibility issues for a solution. What should you use?

- A. Microsoft Accessibility Conformance Reports
- B. Microsoft Compliance Center
- C. Power Apps Studio
- D. Microsoft Accessibility Guides
- E. Microsoft Visual Studio

Answer: C

Explanation:

- ? Find accessibility issues
- ? In the upper-right corner of Power Apps Studio, select the icon for the App checker.
- ? App checker icon.
- ? In the menu that appears, select Accessibility.
- ? A list of issues appears, sorted first by severity and then by screen.
- ? Select the arrow next to an item to show details about it.
- ? Accessibility checker details.
- ? Select the back arrow to return to the list of items.
- ? If you decide to address an issue, select it to open the affected property.
- ? After you change one or more properties, select Re-check to update the list of issues.

Reference:

<https://docs.microsoft.com/en-us/powerapps/maker/canvas-apps/accessibility-checker> <https://support.microsoft.com/en-us/accessibility/enterprise-answer-desk>

NEW QUESTION 228

DRAG DROP - (Topic 4)

DRAG DROP

A company uses Power Automate. You manage two cloud flows named A and B. Users must perform the following activities:

- Manage the properties of cloud flow A.
- Manually trigger cloud flow B

You need to set up privileges for the business users by using the principle of least privilege Which privilege types should you grant for each activity? To answer, drag the appropriate privilege types to the correct activities. Each privilege type may be used once, more than once, or not at all. You may need to drag the split bar between panes or scroll to view content.

Note: Each correct selection is worth one point.

Privilege types		Answer Area	Activity	Privilege type
Microsoft Power Platform Admin			Manage the properties of cloud flow A.	
Co-owner			Manually trigger cloud flow B.	
Run-only				

- A. Mastered
- B. Not Mastered

Answer: A

Explanation:

Privilege types		Answer Area	Activity	Privilege type
Microsoft Power Platform Admin			Manage the properties of cloud flow A.	Co-owner
Co-owner			Manually trigger cloud flow B.	Run-only
Run-only				

NEW QUESTION 230

HOTSPOT - (Topic 4)

A company is creating new app for use by technicians.

Previous versions of the app do not render properly on tablets and phones. You need to ensure that the new app renders properly on all devices.

Which design element should you use? To answer, select the appropriate options in the answer area.

NOTE: Each correct selection is worth one point.

Requirement	Design element
Create an app that does not specify a screen size in the design	<div><div></div><div>Phone form factor</div><div>Tablet form factor</div><div>Blank canvas app</div><div>Model-driven app</div></div>
Lock the screen size for an app that needs to be set to a specific resolution	<div><div></div><div>Aspect ratio</div><div>Orientation</div><div>Image positioning</div><div>Display mode</div></div>

- A. Mastered
- B. Not Mastered

Answer: A

Explanation:

- Box 1: Tablet form factor Box 2: Aspect version
 Customize a canvas app by changing its screen size.
 ? Sign in to Power Apps.
 ? Open the app to edit.
 ? Select Settings.
 ? Select Display.
 ? (Tablet apps only) Under Aspect ratio, perform either of these steps:
 ? Select the ratio that matches the target device for this app.
 ? Select Custom to set your own size, and then specify a width between 50 - 3840 and a height between 50 - 2160.

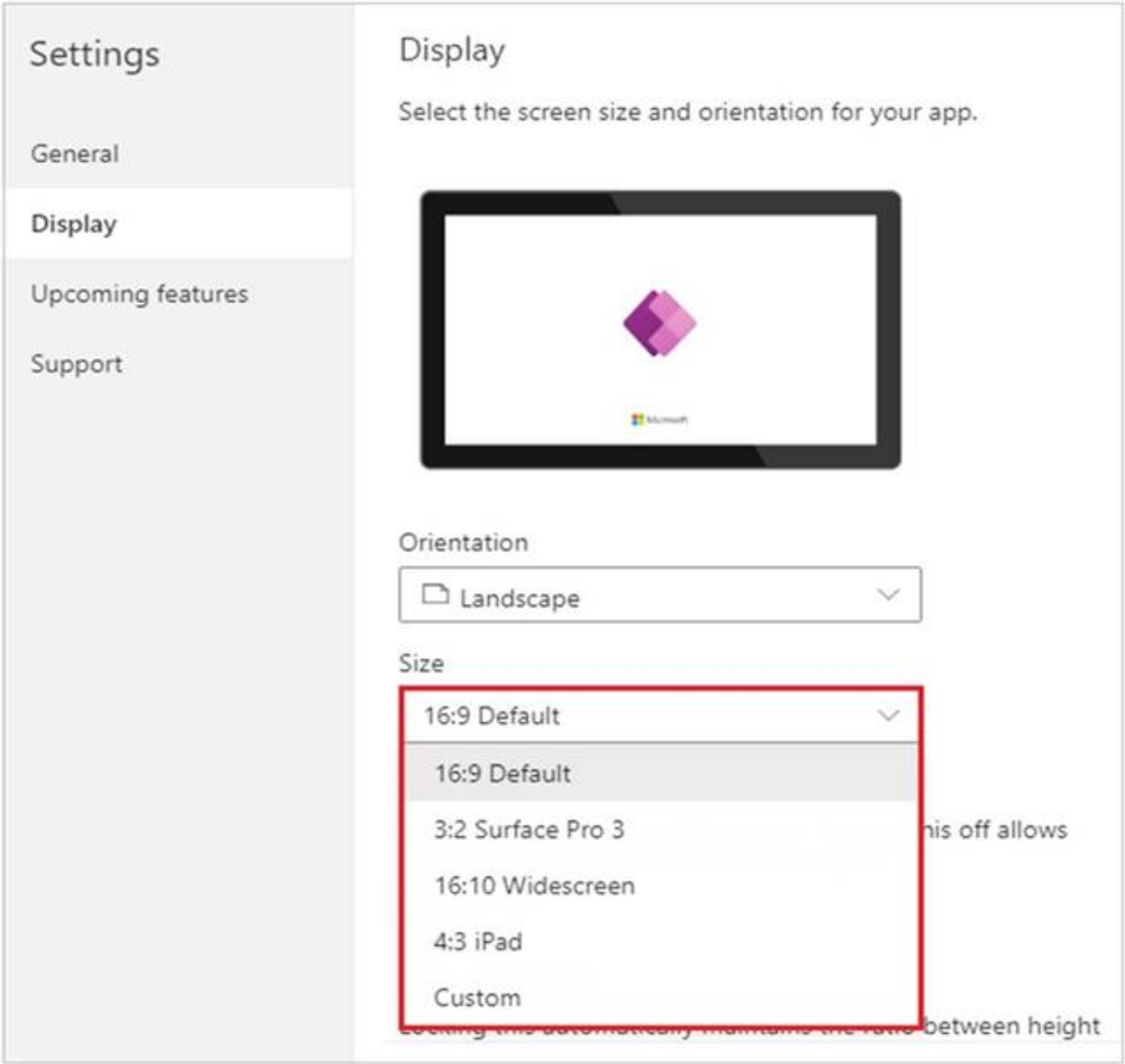

NEW QUESTION 231

HOTSPOT - (Topic 4)
 A company is building a canvas app.
 A user needs to understand which data they can make available for the 500 contacts that are present in the Contact table. All relevant data must be shown in the app. Single fields must show one record and grids must show multiple records. Only the primary fields for each related table should be shown for a contact.

Display name	Relationship name	Related table	Relationship type	Type	Customizable
Company Name	contact_customer_contacts	Contact	Many-to-one	Managed	Yes
Connected From	contact_connections1	Connection	One-to-many	Managed	Yes
Owning Team	Team_contacts	Team	Many-to-one	Standard	Yes

Use the drop-down menus to select the answer choice that answers each question based on the information presented in the graphic.
 NOTE: Each correct selection is worth one point.

How should you design a screen to display the Connection table information for each contact in the Contacts table?

Use a grid for the Contact table and a grid for the Connection table

Use a single field for the Contact table and a grid for the Connection table

Use a grid for the Contact table and a single field for the Connection table

Use a single field for the Contact table and a single field for the Connection table

How should you design a screen to display the Team table information for each contact in the Contact table?

Use a grid for the Contact table and a grid for the Team table

Use a single field for the Contact table and a grid for the Team table

Use a grid for the Contact table and a single field for the Team table

Use a single field for the Contact table and a single field for the Team table

- A. Mastered
- B. Not Mastered

Answer: A

Explanation:

Box 1: Use a single field for Contact table and a grid for the Connection table The Contact table is on 1-side of the 1-to-many relation to the Connection table.
Box 2: Use a single field for Team table and a grid for the Connect table The Team table is on 1-side of the 1-to-many relation to Contact.

NEW QUESTION 236

HOTSPOT - (Topic 4)
HOTSPOT

Inspectors for a city building department use a Microsoft Teams channel, inspectors use SharePoint to view construction bylaws, rules, and regulations. The city clerk email inspectors links to new bylaw proposal, inspectors vote on the proposals and provide additional feedback. You need to demonstrate to the city clerk how they can automate the process. Which option should you use? To answer, select the appropriate options in the answer area.
NOTE: Each correct selection is worth one point.

Answer Area

Flow element	Option
Type of flow.	<div>Cloud flow</div> <div>Desktop flow</div> <div>Business process flow</div>
Trigger type.	<div>Manually trigger a flow.</div> <div>For a selected message in Microsoft Teams.</div> <div>For a selected file in SharePoint.</div> <div>When a flow is run from a business process flow.</div>
Flow step to replace emailing the links.	<div>Get changes for an item in SharePoint.</div> <div>Post an adaptive card to a channel and wait for a response.</div> <div>Post a choice of options to a user in Teams.</div> <div>Send an email with options.</div>

- A. Mastered
- B. Not Mastered

Answer: A

Explanation:

Answer Area

Flow element	Option
Type of flow.	<div>Cloud flow</div> <div>Desktop flow</div> <div>Business process flow</div>
Trigger type.	<div>Manually trigger a flow.</div> <div>For a selected message in Microsoft Teams.</div> <div>For a selected file in SharePoint.</div> <div>When a flow is run from a business process flow.</div>
Flow step to replace emailing the links.	<div>Get changes for an item in SharePoint.</div> <div>Post an adaptive card to a channel and wait for a response.</div> <div>Post a choice of options to a user in Teams.</div> <div>Send an email with options.</div>

NEW QUESTION 238

HOTSPOT - (Topic 4)

A company uses Power Apps and Microsoft Dataverse. You create a model-driven app that has no flows, workflows, or plug-ins. The app requires a main form that has a form field named reference number. The reference number must perform the following activities:
• Autogenerate when new records are created.
• Follow the format xx/yy, where xx is an incremental number and yy indicates the last two digits of the current year.
You need to ensure that each record created in the Microsoft Dataverse table follows this format. Which features should you use? To answer, select the appropriate options in the answer area. NOTE: Each correct selection is worth one point.

Answer Area

Activity	Feature
Choose data type.	<div>Auto-number</div> <div>Whole number</div> <div>Date</div> <div>Auto-number</div> <div>Text</div>
Create format.	<div>{SEQNUM:2}/{DATETIMEUTC:yy}</div> <div>{SEQNUM:2}/{DATETIMEUTC:yy}</div> <div>{SEQNUM:2}/{DATETIMEUTC:2}</div> <div>{SEQNUM:##}/{DATETIMEUTC:yy}</div>
Set seed value.	<div>10</div> <div>#1</div> <div>100</div> <div>10</div>

- A. Mastered
B. Not Mastered

Answer: A

Explanation:

Answer Area

Activity	Feature
Choose data type.	<div>Auto-number</div> <div>Whole number</div> <div>Date</div> <div>Auto-number</div> <div>Text</div>
Create format.	<div>{SEQNUM:2}/{DATETIMEUTC:yy}</div> <div>{SEQNUM:2}/{DATETIMEUTC:yy}</div> <div>{SEQNUM:2}/{DATETIMEUTC:2}</div> <div>{SEQNUM:##}/{DATETIMEUTC:yy}</div>
Set seed value.	<div>10</div> <div>#1</div> <div>100</div> <div>10</div>

NEW QUESTION 242

HOTSPOT - (Topic 4)

: 189 HOTSPOT

A company is building several Power Apps apps to help with sales operations collaboration. You need to identify the right solution for data storage. Which solution should you use? To answer select the appropriate options in the answer area. NOTE: Each correct selection is worth one point.

Answer Area

Characteristic	Solution
Limits the number of records that can be added.	<div>Microsoft Dataverse for Teams</div> <div>Microsoft Dataverse</div> <div>Microsoft Dataverse for Teams</div>
Allows for advanced development tasks for apps specific to Microsoft Teams.	<div>Microsoft Dataverse</div> <div>Microsoft Dataverse</div> <div>Microsoft Dataverse for Teams</div>
Has the most granular level of security to account for column-level security in Microsoft Teams.	<div>Microsoft Dataverse</div> <div>Microsoft Dataverse</div> <div>Microsoft Dataverse for Teams</div>

- A. Mastered
B. Not Mastered

Answer: A

Explanation:

Answer Area

Characteristic	Solution
Limits the number of records that can be added.	<div>Microsoft Dataverse for Teams</div> <div>Microsoft Dataverse</div> <div>Microsoft Dataverse for Teams</div>
Allows for advanced development tasks for apps specific to Microsoft Teams.	<div>Microsoft Dataverse</div> <div>Microsoft Dataverse</div> <div>Microsoft Dataverse for Teams</div>
Has the most granular level of security to account for column-level security in Microsoft Teams.	<div>Microsoft Dataverse</div> <div>Microsoft Dataverse</div> <div>Microsoft Dataverse for Teams</div>

NEW QUESTION 244

- (Topic 4)

Note: This question is part of a series of questions that present the same scenario. Each question in the series contains a unique solution that might meet the stated goals. Some question sets might have more than one correct solution, while others might not have a correct solution.

After you answer a question in this section, you will NOT be able to return to it. As a result, these questions will not appear in the review screen.

You are developing a model-driven app that uses a Common Data Service database. App users will have a variety of different security roles.

Development and testing must be performed using production data. Multiple testers must be used at each testing stage.

You need to provision and configure new environments for development and testing. Solution:

? Provision a trial environment named T1 and a sandbox environment named S1.

? Copy the production environment to T1 and S1.

? Use T1 for development and S1 for testing.

Does the solution meet the goal?

A. Yes

B. No

Answer: B

Explanation:

Using trial environments, companies and customers can try out new features and solutions. Do not use a trial environment for development.

A sandbox environment is any non-production environment of Microsoft Dataverse. Isolated from production, a sandbox environment is the place to safely develop and test application changes with low risk.

Reference:

<https://docs.microsoft.com/en-us/power-platform/admin/trial-environments> <https://docs.microsoft.com/en-us/power-platform/admin/sandbox-environments>

NEW QUESTION 248

- (Topic 4)

A company is using Microsoft Power Platform and Microsoft Teams to approve work contracts.

A manager must view all approved contracts in the past year that the company sent or received. The manager must approve any pending contracts. The solution must minimize effort.

You need to recommend a solution for the company. What should you recommend?

A. Create a Microsoft Teams team with a tab that exposes all approvals.

B. Install the Microsoft Teams approvals app.

C. Embed a Power Apps app within a Microsoft Teams channel.

D. Create a Power BI dashboard that includes all approval requests.

E. Embed a SharePoint list into a Microsoft Teams channel.

Answer: B

NEW QUESTION 250

- (Topic 4)

You create a custom table as part of a solution in the development environment. You deploy major version solutions as managed solutions to production. The organization does not allow new solutions to be created in the production environment.

When a minor update is made to a column length, users cannot enter entire values. You need to allow users to enter entire values in the column.

Solution: Uninstall the most recent version of the solution from the production environment. Does the solution meet the goal?

A. Yes

B. No

Answer: B

NEW QUESTION 254

- (Topic 4)

Note: This question is part of a series of questions that present the same scenario. Each question in the series contains a unique solution that might meet the stated goals. Some question sets might have more than one correct solution, while others might not have a correct solution.

After you answer a question in this section, you will NOT be able to return to it. As a result, these questions will not appear in the review screen.

You are creating a canvas app.

You need to automatically detect bicycles in pictures taken with the camera. Proposed solution:

? Create a Category Classification custom model in AI Builder.

? Train the model with pictures of bicycles and then publish the trained model.

? Add the Object Detector control to your canvas app.

Does the solution meet the goal?

A. Yes

B. No

Answer: B

Explanation:

Instead create an Object Detection custom model Reference:

<https://docs.microsoft.com/en-us/ai-builder/prediction-overview> <https://docs.microsoft.com/en-us/ai-builder/object-detector-component-in-powerapps>

NEW QUESTION 258

DRAG DROP - (Topic 4)

A company must use a Power Apps app custom control that is exported from a different canvas Power Apps app.

You need to insert the custom control into the Power Apps app.

Where should you complete the actions? To answer, drag the appropriate locations to the correct actions. Each location may be used once, more than once, or not

at all. You may need to drag the split bar between panes or scroll to view content.
NOTE: Each correct selection is worth one point.

Objects	Answer Area						
<div>Display</div> <div>Screens</div> <div>Components</div>	<table border="1"><thead><tr><th>Action</th><th>Location</th></tr></thead><tbody><tr><td>Import a custom control from a file.</td><td><div></div></td></tr><tr><td>Add an alignment to the custom control to display it in the middle of the Power Apps app screen.</td><td><div></div></td></tr></tbody></table>	Action	Location	Import a custom control from a file.	<div></div>	Add an alignment to the custom control to display it in the middle of the Power Apps app screen.	<div></div>
Action	Location						
Import a custom control from a file.	<div></div>						
Add an alignment to the custom control to display it in the middle of the Power Apps app screen.	<div></div>						

- A. Mastered
B. Not Mastered

Answer: A

Explanation:

Box 1: Components

- * 1. To add code components to a canvas app:
- * 2. Navigate to Power Apps Studio.
- * 3. Create a new canvas app or edit an existing app to which you want to add the code component.
- * 4. Go to Insert > Custom > Import component.

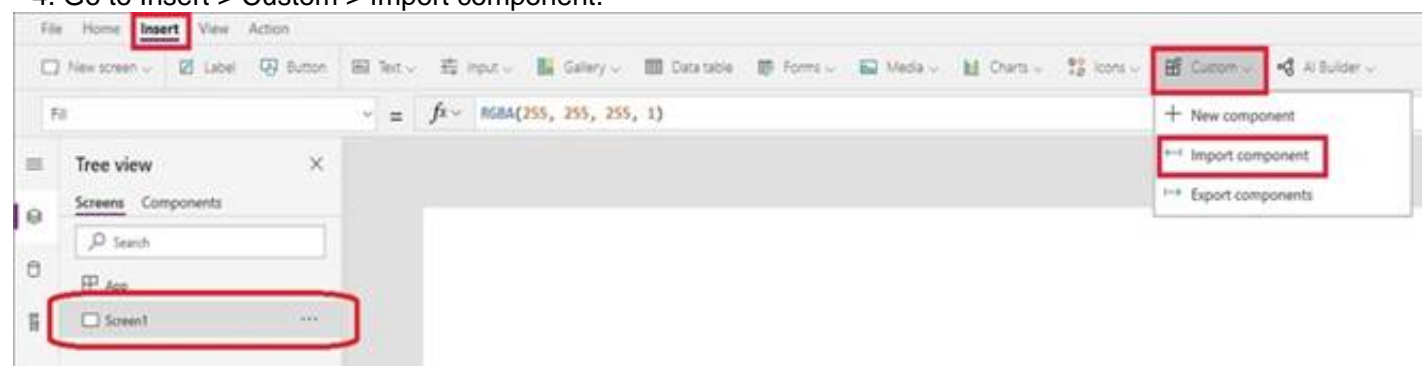

NEW QUESTION 260

- (Topic 4)

You use a Microsoft SharePoint list to record information about customers.

You must perform a series of actions only when a new item is added to a SharePoint list. You need to configure a Power Automate flow.

Which trigger should you use?

- A. When an item is created
B. When an item is created or modified
C. When a file is created (properties only)
D. For a selected item

Answer: A

Explanation:

Trigger - When an item is created Triggers when an item is created.

MS Flow will trigger when an item is created in the list. It will return all list item properties which can be used in the Flow.

Reference:

<https://www.c-sharpcorner.com/article/sharepoint-based-triggers-in-ms-flow-part-2/>

NEW QUESTION 262

HOTSPOT - (Topic 4)

You need to store a list of products and their colors. You have a Power Apps app that includes the following elements:

- ? a text box for the product name
- ? a drop-down list for the product color
- ? a button to add a product to the list
- ? a status message that shows whether the addition of a product to the list was successful

The button uses the following formula:

```
Collect(
colProductList,
{
Product: txtProductName.Text, Color: drpColors.Selected.Value
});
Set(
vStatusMessage, "Added '" & txtProductName.Text & "'"
);
timStatusMessage.Start;
```

For each of the following statements, select Yes if the statement is true. Otherwise, select No.

NOTE: Each correct selection is worth one point.

Statements	Yes	No
You must explicitly declare the collection before you can add product names and colors to the collection.	<input type="radio"/>	<input type="radio"/>
The formula stores the product name and the color in a collection.	<input type="radio"/>	<input type="radio"/>
vStatusMessage is a context variable that is used to store the status message.	<input type="radio"/>	<input type="radio"/>

- A. Mastered
- B. Not Mastered

Answer: A

Explanation:

Box 1: No

The Collect function adds records to a data source. If the data source doesn't already exist, a collection is created.

Box 2: Yes

Box 3: No

Use the Set function to set the value of a global variable, which temporarily holds a piece of information, such as the number of times the user has selected a button or the result of a data operation.

NEW QUESTION 265

DRAG DROP - (Topic 4)

You have a model-driven app that has an entity named Marinas. You have an entity named Boats that list the boats associated with each marina.

You must add a list of boats to the Marinas form. You must also add an option for users to select different views including boat owners and marina members.

You need to embed the list of boats associated with a Marina record in the entity form.

In which order should you perform the actions? To answer, move all actions from the list of actions to the answer area and arrange them in the correct order.

Actions

Add a Subgrid component to a form

Select Show related records and then select the related entity and default view for the subgrid

Save and publish the form

Select the Allow users to change view option

Answer Area

>

<

^

v

- A. Mastered
- B. Not Mastered

Answer: A

Explanation:

Step 1: Add a Subgrid component to a form

You add a subgrid component the same way as you add any other component.

Step 2: Select Show related records and then select the related entity and default view for the subgrid

Configure a subgrid component.

Properties available to configure when using a subgrid component on a form using the form designer include:

? Show related rows

When selected, the subgrid displays only rows related to the current row that is displayed on the form.

Step 3: Select the Allow users to change view option Configure a subgrid component.

Properties available to configure when using a subgrid component on a form using the form designer include:

? Allow users to change view

When selected, app users can change from the Default view to another view of the table

selected in the Table property. Step 4: Save and publish the form

NEW QUESTION 267

DRAG DROP - (Topic 4)

You create a canvas app. You run App checker to validate the app. App checker returns error results.

You need to locate where the errors occur.

Which areas should you review? To answer drag the appropriate areas to the correct error messages. Each area may be used once, more than once, or not at all

You may need to drag the spirt bar between panes or scroll to view content.

NOTE: Each correct selection is worth one point.



- A. Mastered
- B. Not Mastered

Answer: A

Explanation:



NEW QUESTION 271

- (Topic 4)

You are creating a canvas app.

You need to display a limited list of choices to the end user. You must standardize the values and appearance of the list across all forms.

Which two actions should you perform? Each correct answer presents part of the solution.

NOTE: Each correct selection is worth one point.

- A. Add a drop-down field in the app
- B. Create a Global Option Set
- C. Add a new business rule
- D. Add a component to the component library

Answer: AB

Explanation:

A global Option Set can be shared across entities. Reference:

<https://powerapps.microsoft.com/en-us/blog/option-sets-and-many-to-many-relationships-for-canvas-apps/>

NEW QUESTION 274

- (Topic 4)

You create and publish a canvas app component library to perform complex calculations.

You discover an error in one of the calculations. You correct the issue and publish the canvas app.

You need to ensure that the co-worker uses the updated version of the component library.

What should you do?

- A. Export the updated component library and instruct the co-worker to import the updated version into the canvas app
- B. Inform the co-worker to edit the canvas app and manually add the updated version of the component library
- C. Instruct the co-worker to edit the canvas app and update the component library

Answer: C

Explanation:

You can modify an existing component library and save any changes with additional version notes. However, the updated component library version must be published for use in existing apps that use the component library.

Makers of other apps are notified of updated components being available. The notification appears when makers edit the apps in canvas app studio. They can choose to update the components:

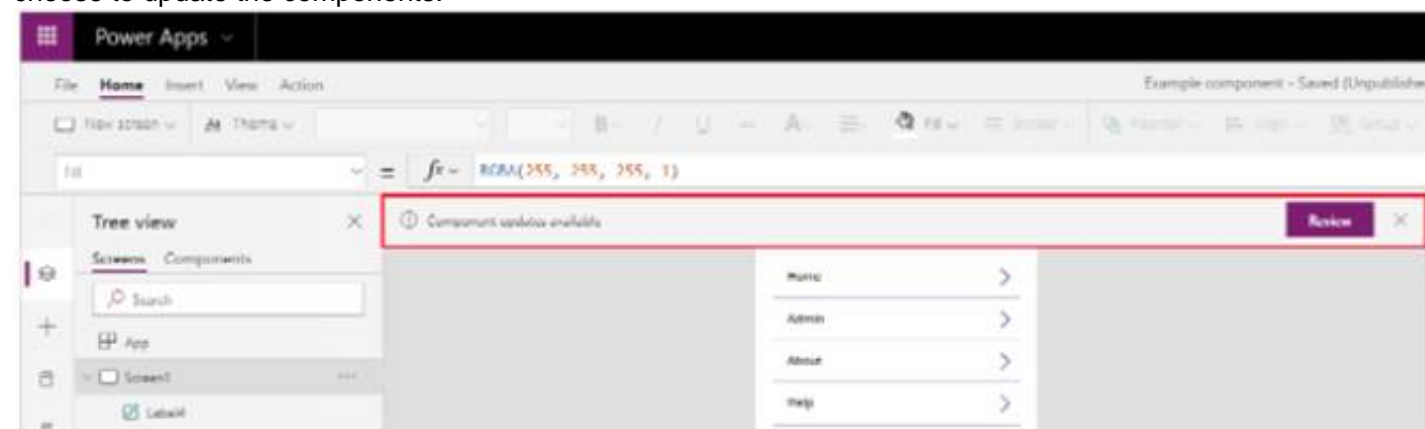

Select Review, and you'll see the option to update the component:

<https://docs.microsoft.com/en-us/powerapps/maker/canvas-apps/component-library>

NEW QUESTION 278

.....

Relate Links

100% Pass Your PL-100 Exam with Examible Prep Materials

<https://www.exambible.com/PL-100-exam/>

Contact us

We are proud of our high-quality customer service, which serves you around the clock 24/7.

Viste - <https://www.exambible.com/>