

Microsoft

Exam Questions PL-500

Microsoft Power Automate RPA Developer



NEW QUESTION 1

- (Exam Topic 1)

You need to configure permissions for the Purchase order quantity flow. Which permission should you assign?

- A. Co-owner
- B. Run-only user
- C. Owner
- D. User

Answer: D

NEW QUESTION 2

- (Exam Topic 1)

You need to resolve the fulfillment status flow issue.

Which three actions should you perform? Each correct answer presents part of the solution. NOTE: Each correct selection is worth one point.

- A. Ensure that the flow instance does not remain in the queue for more than three hours.
- B. Ensure that the flow is not using elevated privileges.
- C. Ensure that all users are signed out from the target machine.
- D. Use different local Windows accounts for all machines.
- E. Trigger the flow by using an on-premises data gateway.

Answer: BDE

NEW QUESTION 3

- (Exam Topic 2)

You need to troubleshoot the issue saving ProdManager.

For each of the following statements, select Yes if the statement is true. Otherwise, select No. NOTE: Each correct selection is worth one point.

Answer Area			
Statement		Yes	No
You can resolve the issue by adding the current user as a co-owner of ProductionMonitor.		<input type="radio"/>	<input type="radio"/>
You can resolve the error by using the Connection References page to add missing embedded connection references to ProductionMonitor.		<input type="radio"/>	<input type="radio"/>
You can resolve the issue by changing the value of the Run only users setting for ProductionMonitor from Connections used to Provided by run-only user .		<input type="radio"/>	<input type="radio"/>

- A. Mastered
- B. Not Mastered

Answer: A

Explanation:

Answer Area			
Statement		Yes	No
You can resolve the issue by adding the current user as a co-owner of ProductionMonitor.		<input checked="" type="radio"/>	<input type="radio"/>
You can resolve the error by using the Connection References page to add missing embedded connection references to ProductionMonitor.		<input checked="" type="radio"/>	<input type="radio"/>
You can resolve the issue by changing the value of the Run only users setting for ProductionMonitor from Connections used to Provided by run-only user .		<input checked="" type="radio"/>	<input type="radio"/>

NEW QUESTION 4

- (Exam Topic 3)

You are developing automation solutions for a company.

You need to use an environment variable in a cloud flow.

Which three actions should you perform in sequence? To answer, move the appropriate actions from the list of actions to the answer area and arrange them in the correct order.

Actions

Add an environment variable to a solution.

Create a cloud flow in a solution.

Navigate to https://flow.microsoft.com.

Navigate to https://admin.powerplatform.com.

Select the desired environment variable.

Answer Area

>

<

- A. Mastered
- B. Not Mastered

Answer: A

Explanation:

Actions

Add an environment variable to a solution.

Create a cloud flow in a solution.

Navigate to https://flow.microsoft.com.

Navigate to https://admin.powerplatform.com.

Select the desired environment variable.

Answer Area

Create a cloud flow in a solution.

Add an environment variable to a solution.

Navigate to https://admin.powerplatform.com.

NEW QUESTION 5

- (Exam Topic 3)

You are developing automation solutions that process sensitive employee data for a company. You plan to implement the sensitive variables feature in Power Automate for desktop.

What are three characteristics of the sensitive variables feature? Each correct answer presents a complete solution.

NOTE: Each correct selection is worth one point.

- A. Only variables that are passwords can be marked as sensitive.
- B. You can view the values of variables marked as sensitive within desktop flow logs by using the Microsoft Power Platform admin center.
- C. Sensitive variables are not visible within desktop flow logs in the Power Automate portal.
- D. You can mark any variable as sensitive.
- E. You can reference and manipulate variables that are marked as sensitive from within desktop flows.

Answer: ACD

NEW QUESTION 6

- (Exam Topic 3)

A company publishes a list of contacts each day as an HTML table on a web page. The company has a customer relationship management (CRM) application that runs on employee desktop devices.

You need to implement an RPA solution that reads data from the HTML table and create records in the CRM application.

Which four actions should you perform in sequence? To answer, move the appropriate actions from the list of actions to the answer area and arrange them in the correct order.

Actions

Launch a new web browser instance.

Use the Get details of element on web page action to read data from the HTML table into a variable.

Use the Run application action to start the CRM application.

Use the Extract data from web page action to read data from the HTML table into a variable.

Use a dynamic selector to save data from the HTML table into a variable.

Use a For each loop to write data from the variable to the CRM application.

Answer area

>

<

- A. Mastered
- B. Not Mastered

Answer: A

Explanation:

NEW QUESTION 7

- (Exam Topic 3)

You develop automation solutions for a company. You need to package the solutions. What should you use? To answer, select the appropriate options in the answer area. NOTE: Each correct selection is worth one point.

- A. Mastered
- B. Not Mastered

Answer: A

Explanation:

NEW QUESTION 8

- (Exam Topic 3)

You have a machine that runs an automation solution. You need to move the machine to a different environment. Which three actions should you perform in sequence? To answer, move the appropriate actions from the list of actions to the answer area and arrange them in the coned order.

- A. Mastered
- B. Not Mastered

Answer: A

Explanation:

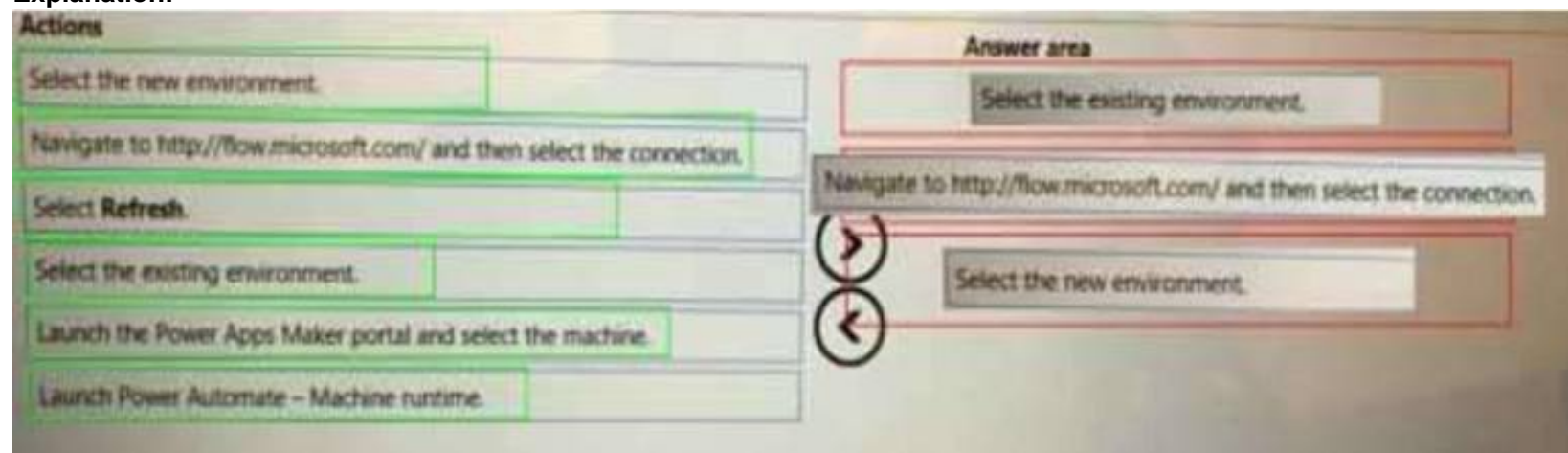

NEW QUESTION 9

- (Exam Topic 3)

You are creating a solution that will use a Choice field for approvals.

You need to ensure that other users can use the Choice field with their Microsoft Dataverse tables.

What should you use?

- A. Environment variable
- B. Local choice
- C. Global choice

Answer: C

NEW QUESTION 10

- (Exam Topic 3)

You create a process map by using Process advisor. You plan to create a cloud flow based on the process map. You need to develop the cloud flow.

Which two Process advisor features can you use? Each correct answer presents a complete solution. NOTE: Each correct selection is worth one point.

- A. Automatically build a cloud flow based on the process map.
- B. Recommend automation opportunities based on the process map,
- C. Suggest input variables to use in the cloud flow.
- D. Suggest connectors to use in the cloud flow.

Answer: AB

NEW QUESTION 10

- (Exam Topic 3)

You are trying to record the process that a hospitality facility uses to check in patients. You need to identify bottlenecks and variations in the process. What should you use?

- A. Process Advisor
- B. Flow checker
- C. AI Builder
- D. Solution checker

Answer: D

NEW QUESTION 12

- (Exam Topic 3)

A developer creates a desktop flow. You need to debug the flows.

Which debugging tools should you use? To answer, select the appropriate options in the answer area. NOTE: Each correct selection is worth one point.

Answer Area

Scenario	Debugging tool
Run each action and then pause the flow after the action completes. Open the variables pane to check a value before continuing the flow.	<div>Run delay</div> <div>Find in code</div> <div>Run from here</div> <div>Run next action</div>
Automatically stop the flow at a specific action.	<div>Pause</div> <div>Run delay</div> <div>Stop flow</div> <div>Breakpoint</div>
Define the time that the flow pauses after running each action.	<div>Run delay</div> <div>Run from here</div> <div>Run next action</div> <div>Wait for process</div>

- A. Mastered
- B. Not Mastered

Answer: A

Explanation:
Answer Area

Scenario	Debugging tool
Run each action and then pause the flow after the action completes. Open the variables pane to check a value before continuing the flow.	<div>Run delay</div> <div>Find in code</div> <div>Run from here</div> <div>Run next action</div>
Automatically stop the flow at a specific action.	<div>Pause</div> <div>Run delay</div> <div>Stop flow</div> <div>Breakpoint</div>
Define the time that the flow pauses after running each action.	<div>Run delay</div> <div>Run from here</div> <div>Run next action</div> <div>Wait for process</div>

NEW QUESTION 15

- (Exam Topic 3)

A company uses Microsoft 365 apps. You are building a flow that is triggered when a new email arrives. If an email message contains a Microsoft Excel workbook attachment the solution must post the Excel data to an external customer relationship management (CRM) system that runs on a user's workstation. The CRM system is not accessible by using an API. You need to design the solution. Which three actions should you perform? Each correct answer presents part of the solution. NOTE: Each correct selection is worth one point.

- A. Implement the Create file action from the OneDrive connector in a cloud flow.
- B. Create a desktop flow.
- C. Implement the When a new email arrives trigger in a cloud flow.
- D. Implement the Retrieve email messages action from a desktop flow.
- E. Create a desktop flow and define an input variable of type file.

Answer: ACE

NEW QUESTION 17

- (Exam Topic 3)

You develop a desktop flow. You need to debug the flow. Which three tools can you use? Each correct answer presents a complete solution. NOTE: Each correct selection is worth one point.

- A. Static results
- B. Run from here
- C. Breakpoints
- D. Configure run after

E. Run next action

Answer: BCE

NEW QUESTION 20

- (Exam Topic 3)

You have a flow that interacts with different SharePoint sites. You add the flow to a solution.

You redeploy the solution to production each time you make a change to the flow. You do not want to change the SharePoint site URL every time you redeploy the solution.

You need to configure the solution. Which solution component should you use?

- A. Environment variable
- B. Web resource
- C. Managed identity
- D. Connection reference

Answer: D

NEW QUESTION 24

- (Exam Topic 3)

You are developing a solution for a medical practice. The solution must use an artificial intelligence (AI) model to evaluate medical X-ray images and detect broken bones.

You need to create the AI model for the solution. Solution: Use Azure Computer Vision to create the model. Does the solution meet the goal?

- A. Yes
- B. No

Answer: B

NEW QUESTION 26

- (Exam Topic 3)

You are designing automation processes.

You need to configure the run mode for each automation scenario.

Which run modes should you use? To answer, drag the appropriate run modes to the correct scenarios. Each run mode may be used once, more than once, or not at all. You may need to drag the split bar between panes or scroll to view content.

NOTE: Each correct selection is worth one point.

Run modes		Scenario	Run mode
Attended		Automate the transfer of data from a file you save locally in an active user session to an application installed on your machine.	Run mode
Unattended		Run 10 credit card checks in parallel in a system without API.	Run mode
		Trigger an automation to update data in a customer relationship management app after an approval process completes.	Run mode

- A. Mastered
- B. Not Mastered

Answer: A

Explanation:

Run modes		Scenario	Run mode
Attended		Automate the transfer of data from a file you save locally in an active user session to an application installed on your machine.	Unattended
Unattended		Run 10 credit card checks in parallel in a system without API.	Unattended
		Trigger an automation to update data in a customer relationship management app after an approval process completes.	Attended

NEW QUESTION 27

- (Exam Topic 3)

A company hires you to develop a solution that helps the company manage new hires. Users will enter information about the new employee into an app and the app will save the information to a database.

The app must be simple to use and must rely on a data model. You must implement a workflow that automatically notifies the IT department when new employee records are created in the database.

You need to create the solution.

Which three actions should you perform in sequence? To answer, move the appropriate actions from the list of actions to the answer area and arrange them in the correct order.

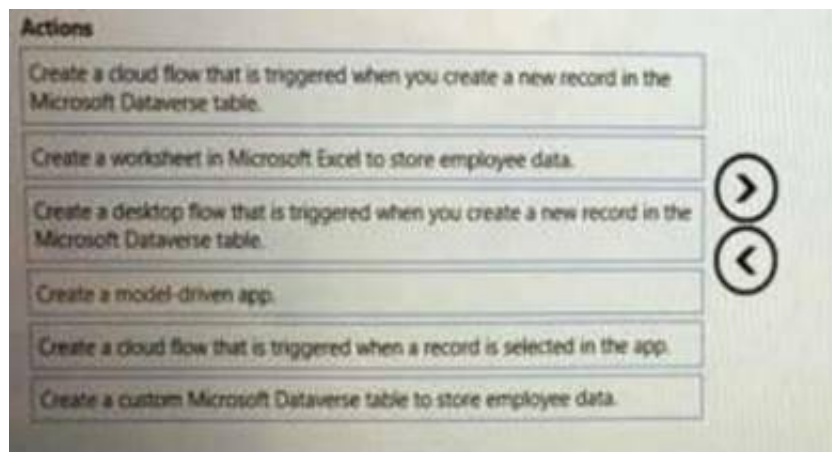

- A. Mastered
- B. Not Mastered

Answer: A

Explanation:

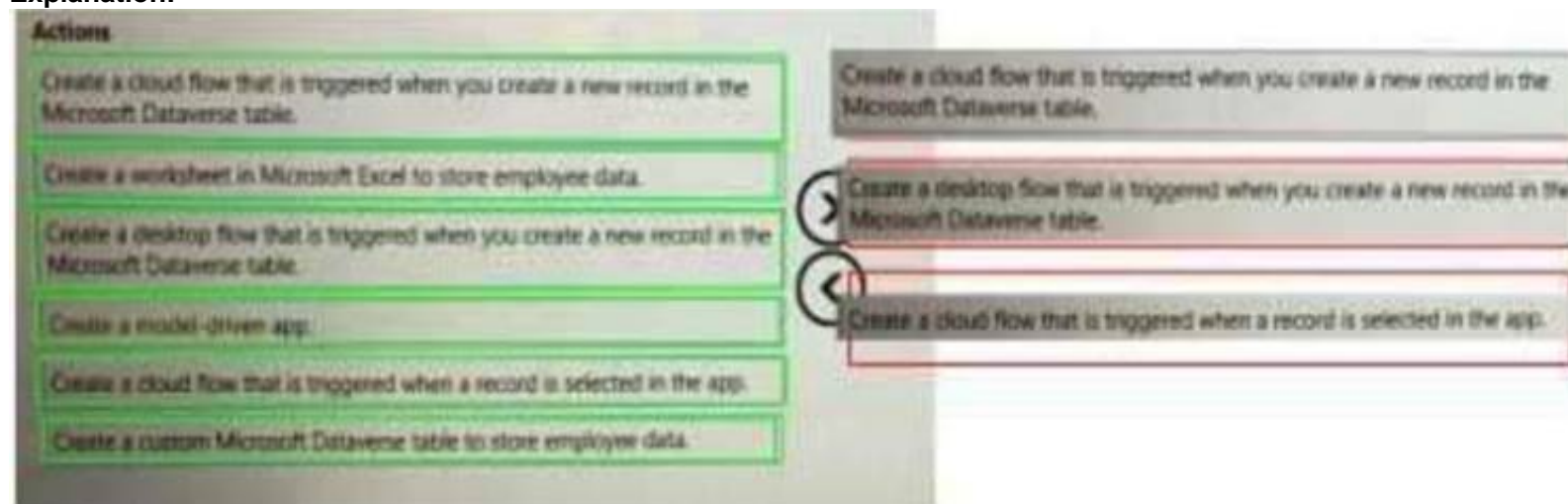

NEW QUESTION 31

- (Exam Topic 3)

You develop a Microsoft Power Platform solution for a client.

You must test the solution in a user acceptance testing (UAT) environment before deploying the solution to production. You must ensure that the configurations for the UAT and production environments are identical. You must minimize administrative effort.

You need to ensure that the environments are identical. Which Microsoft Power Platform feature should you use?

- A. Copy environment
- B. Edit environment properties
- C. Move environment
- D. Reset environment
- E. Restore environment

Answer: AB

NEW QUESTION 35

- (Exam Topic 3)

You create an unattended Office 365 automation. The automation stops running.

You suspect that the runtime identity used by the automation caused the automation to stop running. Which two issues can the runtime identity cause in this scenario? Each correct answer presents a complete solution. NOTE: Each correct selection is worth one point.

- A. The automation is attempting to open files that cannot be opened or edited based on per-user access permissions
- B. The automation is not set up to handle an additional sign-in UI element.
- C. The unattended automation process suppressed an alert that was generated.
- D. The location of a specific user interface element has changed.

Answer: BD

NEW QUESTION 37

- (Exam Topic 3)

You are creating a custom selector for a Microsoft Excel workbook by using a Power Automate desktop flow.

Selector builder

Selectors

2

☒

Pane 'Budget2022'

3

☒

Pane 'Sheet Budget'

4

☒

DataGrid 'Grid'

5

☒

Table 'BudgetData'

6

☒

Data Item "'A' 3'

Used	Attribute	Operator	Value
<input checked="" type="checkbox"/>	Class	Equal to	XLDESK
<input type="checkbox"/>	Enabled	Equal to	True
<input type="checkbox"/>	Id	Equal to	
<input type="checkbox"/>	Name	Equal to	
<input type="checkbox"/>	Ordinal	Equal to	-1
<input type="checkbox"/>	Process	Equal to	EXCEL

> pane[Class="XLDESK"] > pane[Class="ExcelGrid"][Id\$="Budget2022.xlsx"] > pane[Id@="Budget[0-9]*"] > datagrid [Id="Grid"] > table[Name\$="BudgetData"] > dataitem[Id="'A' + RowIdx%"]

☒ Custom

Update

Cancel

Questions	Response
A user accidentally changes the name of the Microsoft Excel file to Final_Budget2022.xlsx . Will the selector still work?	<div>Yes</div> <div>No</div>
A Microsoft Excel file contains a worksheet with the name Budget . Will the selector be able to find the worksheet?	<div>Yes</div> <div>No</div>
Which value will be extracted by using this selector?	<div>The value from cell A3.</div> <div>The value of a cell where the ID equals ARowIdx.</div> <div>The value of any cell defined by RowIdx variable in column A.</div> <div>The value of any cell defined by the ARowIdx variable in column A.</div>
A user needs to change the name of a table to Budget2022 in a sheet. Which part of the selector must the user modify?	<div>Update both the pane ID in line 3 and table name in line 5.</div> <div>Update the pane ID in line 3.</div> <div>Update the table name in line 5.</div>

A. Mastered
B. Not Mastered

Answer: A

Explanation:

Questions	Response
A user accidentally changes the name of the Microsoft Excel file to Final_Budget2022.xlsx . Will the selector still work?	<div>Yes</div> <div>No</div>
A Microsoft Excel file contains a worksheet with the name Budget . Will the selector be able to find the worksheet?	<div>Yes</div> <div>No</div>
Which value will be extracted by using this selector?	<div>The value from cell A3.</div> <div>The value of a cell where the ID equals ARowIdx.</div> <div>The value of any cell defined by RowIdx variable in column A.</div> <div>The value of any cell defined by the ARowIdx variable in column A.</div>
A user needs to change the name of a table to Budget2022 in a sheet. Which part of the selector must the user modify?	<div>Update both the pane ID in line 3 and table name in line 5.</div> <div>Update the pane ID in line 3.</div> <div>Update the table name in line 5.</div>

Passing Certification Exams Made Easy

visit - <https://www.surepassexam.com>

NEW QUESTION 39

- (Exam Topic 3)

You create a solution within a Microsoft Power Platform environment. The environment includes all connections required for the solution. You need to create a connection reference for the flows.

Which four actions should you perform in sequence? To answer, move the appropriate actions from the list of actions to the answer area and arrange them in the order.

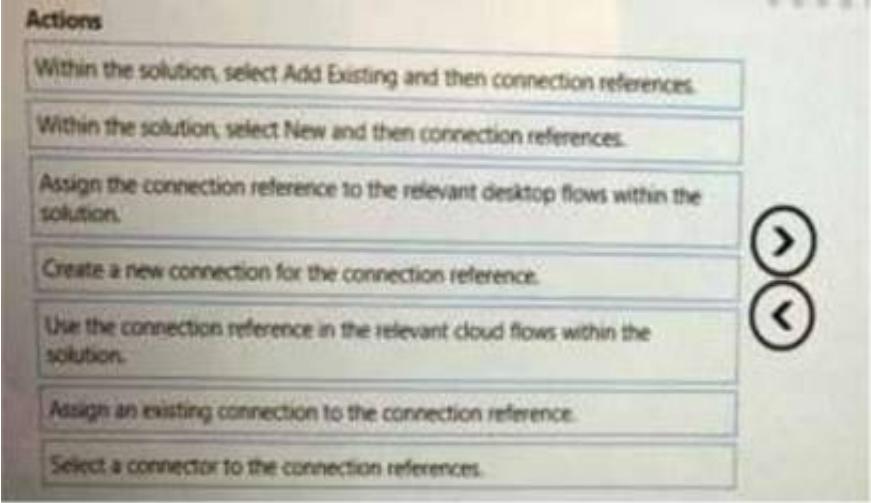

- A. Mastered
- B. Not Mastered

Answer: A

Explanation:

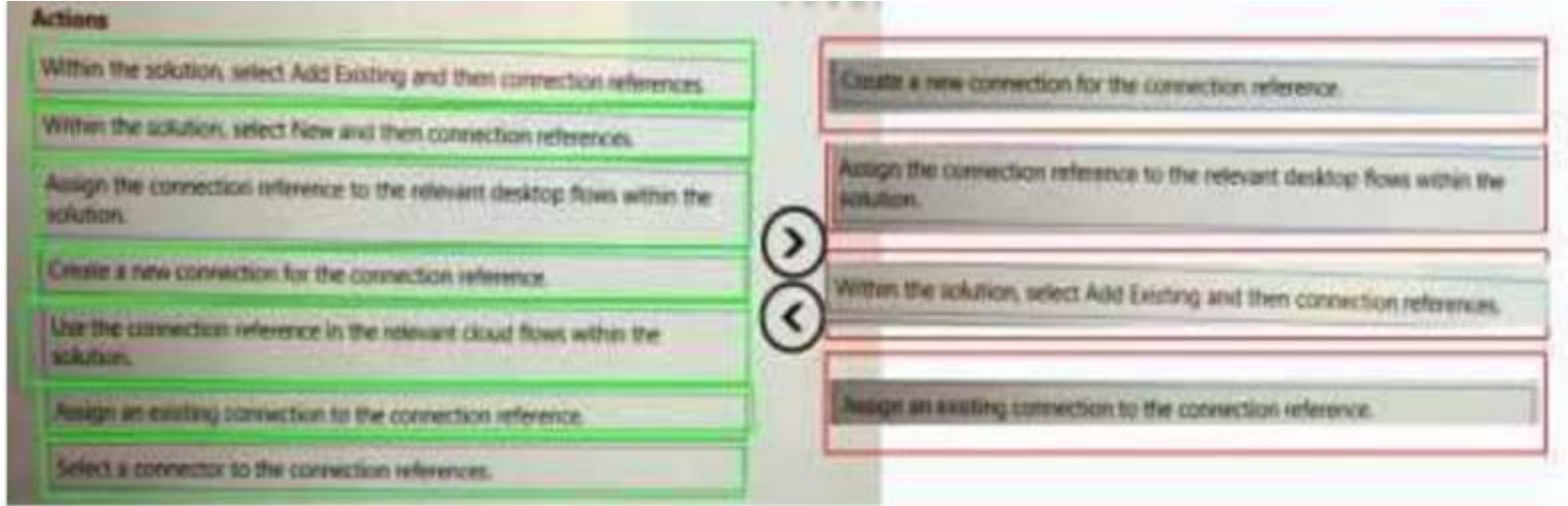

NEW QUESTION 43

.....

Thank You for Trying Our Product

We offer two products:

1st - We have Practice Tests Software with Actual Exam Questions

2nd - Questions and Answers in PDF Format

PL-500 Practice Exam Features:

- * PL-500 Questions and Answers Updated Frequently
- * PL-500 Practice Questions Verified by Expert Senior Certified Staff
- * PL-500 Most Realistic Questions that Guarantee you a Pass on Your First Try
- * PL-500 Practice Test Questions in Multiple Choice Formats and Updates for 1 Year

100% Actual & Verified — Instant Download, Please Click
[Order The PL-500 Practice Test Here](#)