

# Exam Questions 220-1101

CompTIA A+ Certification Exam: Core 1

<https://www.2passeasy.com/dumps/220-1101/>



#### NEW QUESTION 1

A technician needs to fix a Cat 5 cable issue. The cable, which is connected to a network jack, fails when it is moved around. Which of the following items must the technician use to fix the issue? (Select TWO).

- A. Scissors
- B. Network tap
- C. Magnetized screwdriver
- D. Tone generator
- E. RJ45 connector
- F. Crimper

**Answer:** AE

#### NEW QUESTION 2

A technician is configuring a workstation to be used as a VM host. After installing the necessary software, the technician is unable to create any VMs. Which of the following actions should be performed?

- A. Disable the BIOS password.
- B. Enable TPM.
- C. Enable multithreading.
- D. Enable Fast Startup.

**Answer:** B

#### Explanation:

If you want to install Windows 11 on a virtual machine using Hyper-V, you will have to use a “Generation 2” VM and enable the “trusted platform module” (TPM) and Secure Boot options. Otherwise, the OS won’t install.

Starting with Windows 11, Microsoft is changing the system requirement and making TPM 2.0 and Secure Boot a prerequisite to perform an in-place upgrade or clean install the new version on any device. This is in addition to the new 4GB of RAM and at least 64GB of storage.

quoted from here:

<https://pureinfotech.com/enable-tpm-secure-boot-hyperv-install-windows-11/> Furthermore, Multithreading is not a requirement for hyper-v hosting.

#### NEW QUESTION 3

A network technician has been tasked with creating a patch cable. The RJ45 connectors will not stay attached to the cable. Which of the following tools is needed to fix this issue?

- A. Cable tester
- B. Crimper
- C. Punchdown tool
- D. Loopback plug

**Answer:** B

#### Explanation:

A crimper is a tool that is used to crimp (attach) an RJ45 connector onto the end of a patch cable. The crimper applies pressure to the connector to make a permanent connection between the connector and the cable, ensuring that the connector will stay attached to the cable.

A cable tester is used to test the connectivity of a network cable. A punchdown tool is used to terminate network cables in a patch panel or keystone jack. A loopback plug is a diagnostic tool that is used to test network interfaces by simulating network traffic.

#### NEW QUESTION 4

A desktop support technician is tasked with upgrading a laptop so that it has the fastest data access possible. Which of the following BEST satisfies this requirement?

- A. mSATA SSD
- B. M.2 NVMe SSD
- C. 2.5 SATA SSD
- D. 2.5 SATA HDD

**Answer:** B

#### NEW QUESTION 5

A user wants a second monitor installed on a laptop. The VGA/DVI or HDMI cables have already been connected. Which of the following should the technician do to configure the laptop to show both screens?

- A. Power cycle the laptop.
- B. Plug in the monitor to the USB port.
- C. Adjust the monitor display settings.
- D. Power cycle the monitor.

**Answer:** C

#### NEW QUESTION 6

A thermal printer that is used to print order tickets in a factory has been experiencing issues following the failure of the air conditioner during the summer. Each ticket has blank spots or is missing text. Which of the following would MOST likely solve these issues?

- A. Restore function to the air conditioner.

- B. Clean the heating element.
- C. Replace the paper rolls.
- D. Install new toner.

**Answer:** D

#### NEW QUESTION 7

Which of the following types of devices MOST often uses a Thunderbolt cable?

- A. Linux PC
- B. Android mobile
- C. Apple laptop
- D. Chromebook

**Answer:** C

#### Explanation:

CompTIA study guide says Apple Devices use thunderbolt and lightning cables the most, but it is being implemented in Windows and Linux products.

#### NEW QUESTION 8

Which of the following network types would be used in a server room to connect virtual servers to high-speed storage?

- A. WAN
- B. PAN
- C. MAN
- D. SAN

**Answer:** D

#### NEW QUESTION 9

Which of the following would MOST likely be used to obtain electronic images of a large number of printed documents?

- A. NFC device
- B. ADF/flatbed scanner
- C. Camera/webcam
- D. QR scanner

**Answer:** B

#### NEW QUESTION 10

Which of the following connectors can be plugged into a Thunderbolt 3 port on a laptop?

- A. miniUSB
- B. microUSB
- C. USB-A
- D. USB-C

**Answer:** C

#### Explanation:

Thunderbolt 3 is a USB-C port, so any device with a USB-C connector can be plugged into it. MiniUSB, microUSB and USB-A are not compatible with Thunderbolt 3.

#### NEW QUESTION 10

A technician is receiving reports that the entire office sporadically loses network connectivity throughout the day. The technician determines the root cause to be EMI. Which of the cable mediums would be the MOST cost effective without sacrificing system performance?

- A. Coaxial
- B. Shielded Cat 6
- C. Plenum Cat 5e
- D. Multimode fiber

**Answer:** B

#### Explanation:

Electromagnetic interference (EMI) is unwanted noise or interference in an electrical path or circuit caused by an outside source. Hence shielded Cat 6 is better

#### NEW QUESTION 12

A technician is replacing a computer with a connected point-of-sale system using a 9-pin serial adapter. The new computer does not have a 9-pin serial port. Which of the following ports can an adapter be installed on in order to connect to the point-of-sale system?

- A. HDMI
- B. Bluetooth
- C. USB
- D. Lightning

**Answer:** A

#### NEW QUESTION 15

A customer is using a satellite internet connection that is experiencing slowness. A technician notices high latency while pinging, but the download test is performing perfectly with very good download speeds. Which of the following represents the NEXT action the technician should perform?

- A. Restart the modem and run an online internet connection and speed diagnostic tool.
- B. Guide the customer on how to upgrade the internet plan with the provider in order to improve latency.
- C. Explain to the customer this is not an issue; this situation is normal for this type of internet connection.
- D. Replace the modem because it is not working correctly based on the test result.

**Answer:** A

#### NEW QUESTION 20

A technician wants to deploy a .msi package to a corporate network. The technician needs to verify the application deployment will not affect other legacy applications on the end users' computers. Which of the following would the technician consider the MOST appropriate for this situation?

- A. Virtual network
- B. Application virtualization
- C. Cross-platform virtualization
- D. Virtual sandbox
- E. Virtual desktop

**Answer:** A

#### NEW QUESTION 25

A user brings an older laptop to the help desk and reports issues with the keyboard. Upon inspection, the technician does not see any external damage but notices that many keystrokes do not register in a word processor. The laptop works fine when the technician tests it with an external keyboard. Which of the following actions would MOST likely resolve the issue?

- A. Disable the sticky keys feature.
- B. Clean the keyboard.
- C. Reset the BIOS settings to default.
- D. Charge the laptop.

**Answer:** C

#### NEW QUESTION 30

An organization maintains various record types, including health and criminal justice records. Which of the following cloud environments is the organization MOST likely to use to limit the attack surface?

- A. Public
- B. Hybrid
- C. Community
- D. Private

**Answer:** D

#### NEW QUESTION 33

Which of the following network services allows a networked device to always be assigned the same IP address based on the device's MAC address?

- A. DHCP
- B. LDAP
- C. UTM
- D. DNS

**Answer:** A

#### NEW QUESTION 36

Which of the following cables replaced the Apple 30-pin connector and is also reversible?

- A. USB-C
- B. Lightning
- C. miniUSB
- D. DisplayPort

**Answer:** B

#### Explanation:

Lightning Connector: Apple introduced this brand-new connector back in 2012. It is over 80% smaller than the 30-pin connector and is reversible.  
[https://www.cablewholesale.com/support/technical\\_articles/whats\\_your\\_port.php#:~:text=Lightning%20Connec](https://www.cablewholesale.com/support/technical_articles/whats_your_port.php#:~:text=Lightning%20Connec)

#### NEW QUESTION 39

Which of the following network devices is used to separate broadcast domains?

- A. Switch
- B. Wireless access point
- C. Router
- D. Hub

**Answer:** A

#### NEW QUESTION 43

A technician is setting up a new desktop computer and will be installing the hard drive directly on the motherboard without using cables to connect it. Which of the following will the technician be installing?

- A. Thunderbolt
- B. eSATA
- C. M.2
- D. SCSI

**Answer:** C

#### NEW QUESTION 44

A technician was called in to look at a user's PC. The user reported the PC was very sluggish. The HDD light on the PC was constantly on without blinking. The PC itself was slow receiving input and took a very long time to load the OS. The technician also noticed updates had failed. Which of the following is MOST likely the cause of these issues?

- A. The hard disk drivers have been corrupted
- B. The HDD cables need reseating.
- C. A RAID disk failed.
- D. The HDD has no free space.

**Answer:** A

#### NEW QUESTION 45

Which of the following utilizes TCP ports 20/21 and transfers data in cleartext?

- A. SNMP
- B. SSH
- C. FTP
- D. Telnet

**Answer:** C

#### NEW QUESTION 50

A technician receives a ticket that states a mobile payment device is having issues with its contactless payment feature. The device is not detecting payment options. Which of the following is the MOST likely cause of the issue?

- A. NFC
- B. Bluetooth
- C. Wi-Fi
- D. Lightning adapter

**Answer:** B

#### NEW QUESTION 55

A user is unable to access the internet on a PC. A technician examines the PC and runs the following commands:

```
ipconfig /all
ping 8.8.8.8
ping comptia.org
```

Which of the following steps in the troubleshooting process does this series of commands represent?

- A. Establish a theory.
- B. Verify full system functionality.
- C. Establish a plan of action.
- D. Identify the problem.

**Answer:** B

#### NEW QUESTION 59

An office manager reports that a printer is experiencing performance issues. Printouts are smudging when they are handled, and, recently, whenever the manager tries to print oversized documents, the paper jams before anything is printed on it.



- A. Mastered
- B. Not Mastered

**Answer:** A

**Explanation:**

A picture containing text, electronics, printer Description automatically generated

**NEW QUESTION 64**

Which of the following is a valid use for PaaS?

- A. Off-site backups
- B. An application development environment
- C. A virtual server installation and configuration model
- D. A web application for asset management

**Answer:** B

**NEW QUESTION 68**

A technician installs a new printer for a workstation and tries to print a test page, but the page does not print. The technician looks at the print queue and notices that the printer is called 'Generic Printer.' Which of the following BEST describes what the technician should do to fix this issue?

- A. Connect the printer with a USB cable rather than over the network.
- B. Install the appropriate printer drivers for the OS.
- C. Install the correct toner in the printer.
- D. Set the printer trays to allow duplex printing

**Answer:** B

**NEW QUESTION 73**

A technician is working on a help desk ticket for a user who wants the filament replaced in a 3-D printer. Which of the following should the technician do to remove the old filament and load the new one?

- A. Preheat the nozzle to melting temperature.
- B. Cut a sharp angle on the end of the strand.
- C. Push the filament along until resistance is felt.
- D. Withdraw the filament and remove the spool.

**Answer:** D

**Explanation:**

A technician is working on a help desk ticket for a user who wants the filament replaced in a 3-D printer. To remove the old filament and load the new one, the technician should preheat the nozzle to melting temperature. After the nozzle is heated, the technician should withdraw the filament and remove the spool. Then, cut a sharp angle on the end of the new strand, and push it along until resistance is felt.

**NEW QUESTION 75**

A technician is troubleshooting a point-of-sale printer that is printing blank receipts. Which of the following should the technician do to resolve the issue?

- A. Verify the correct type of paper is loaded.
- B. Install the latest print driver.
- C. Check to see if the default printer has been changed.
- D. Ensure the printer is connected to power.



**Answer:** D

#### NEW QUESTION 77

A user on a SOHO network is unable to watch online videos, even at 240 pixels. The technician runs ipconfig from the user's computer and records the following:

```
Connection-specific DNS Suffix .: lan
Link-local IPv6 Address . . . . .: fe80::1585:7fb2:b05f:7102%12
IPv4 Address. . . . .: 192.168.1.131
Subnet Mask . . . . .: 255.255.255.0
Default Gateway . . . . .: 192.168.1.1
```

The technician then connects a test laptop to the router via the user's Cat 5 cable and records the following information:

```
Download: 85 mbps
Upload: 22 mbps
Ping: 28 ms
```

Which of the following is MOST likely causing the user's issue?

- A. Incorrect IP address
- B. Faulty NIC
- C. Misconfigured default gateway
- D. Bad network cable

**Answer:** B

#### NEW QUESTION 80

A system administrator has been tasked with allowing SMTP traffic through the system's host-based firewall. Which of the following ports should the administrator enabled?

- A. 23
- B. 25
- C. 80
- D. 161

**Answer:** A

#### NEW QUESTION 85

Which of the following components enables the input on a mobile device's touch screen?

- A. OLED
- B. Digitizer
- C. Inverter
- D. CMOS sensor

**Answer:** B

#### NEW QUESTION 90

A technician is investigating the output shown on a monitor. The output is clear, but it has a pink hue. The technician has replaced the video card and updated the graphics drivers. Which of the following would be the MOST likely cause?

- A. Physical cabling issues
- B. Burned-out bulb
- C. Display burn-in
- D. Incorrect data source

**Answer:** A

#### NEW QUESTION 91

Which of the following should the data center hardware technician implement to ensure maximum uptime for customers' virtual machines?

- A. Line conditioner
- B. AC voltage regulator
- C. Uninterruptible power supply
- D. Cloud storage backup

**Answer:** C

#### NEW QUESTION 92

Which of the following concepts would be used by an online retailer to quickly add more web servers during peak sales times?

- A. Community cloud
- B. Rapid elasticity
- C. High availability
- D. Metered service

**Answer:** B

#### NEW QUESTION 94

A user on the marketing team uses various multimedia applications that consume a lot of memory. The user needs to install more RAM to run these applications effectively. When the user opens the computer case, the user sees four slots in two sets of colors. Which of the following memory types is MOST likely required?

- A. Dual-channel
- B. Triple-channel
- C. Single-channel
- D. Quad-channel
- E. Error correction code RAM

**Answer:** A

#### NEW QUESTION 95

A technician replaced a motherboard on a server, and now the 64-bit hypervisor is not loading correctly. Which of the following needs to be enabled for the hypervisor to run?

- A. Hardware prefetcher
- B. Hyperthreading
- C. vPro
- D. VT-d

**Answer:** D

#### Explanation:

[https://techlibrary.hpe.com/docs/iss/proliant-gen10-uefi/s\\_enabling\\_VT-d.html](https://techlibrary.hpe.com/docs/iss/proliant-gen10-uefi/s_enabling_VT-d.html)

#### NEW QUESTION 98

A technician has set up a new conference room with a TV and a video soundbar. The technician wants to test the system with a conference call. During the test, the TV speaker produces sound, but the soundbar does not. Which of the following is the MOST likely cause of the issue?

- A. The volume on the TV needs to be turned up.
- B. The conference call needs to be unmuted for audio.
- C. An incorrect HDMI cable is being used.
- D. The TV's HDMI-ARC port is not being use

**Answer:** D

#### Explanation:

HDMI-ARC (Audio Return Channel) is an HDMI connection that allows audio to be sent from the TV to an external sound system, such as a soundbar. If the TV's HDMI-ARC port is not being used, then the soundbar will not receive any audio from the TV and thus will not produce any sound. To resolve the issue, the technician should ensure that the TV's HDMI-ARC port is being used to connect the TV to the soundbar.

#### NEW QUESTION 103

A technician responds to a help desk ticket that indicates a user's workstation is not booting. The technician initially suspects a failed hard drive. The technician performs diagnostics and confirms the hard drive is fully operational. Which of the following steps should the technician complete NEXT?

- A. Reinstall the operating system.
- B. Configure a new RAID array.
- C. Report the status of the drive and close the ticket.
- D. Consider another possible cause of the issue.
- E. Restore the latest backup of the system.

**Answer:** D

#### Explanation:

Since the hard drive appears to be functioning normally, the technician should investigate other potential causes of the issue. This could include checking the BIOS settings, verifying the connections to the hard drive, and testing the RAM. Once these steps have been completed, the technician can then take the necessary steps to resolve the issue.

#### NEW QUESTION 104

A technician recently received a written warning for causing a system-wide outage. The outage was a result of an unscheduled patch being manually pushed during production hours. Which of the following could have MOST likely prevented the technician from receiving the warning?

- A. Following corporate procedures
- B. Testing before deployment
- C. Documenting the findings
- D. Establishing a plan of action

**Answer:** A

#### Explanation:

Following corporate procedures would have been the most likely factor that could have prevented the technician from receiving the written warning. Following established procedures, such as change management, helps ensure that changes made to the production environment are thoroughly tested, approved, and implemented in a controlled and safe manner, reducing the risk of system-wide outages and other unintended consequences.



### NEW QUESTION 109

A user attempted to install an application on a desktop, and the installation attempt failed. A technician compares these installation files to those on another user's machine and finds the files are different. Which of the following should the technician do NEXT?

- A. Attempt to reinstall the application.
- B. Verify the system functionality.
- C. Test the functionality of the antivirus.
- D. Complete the final report.
- E. Determine the source of the installation file.

Answer: A

### NEW QUESTION 110

A small ISP has hired a new technician Joe, the new technician, is being trained to configure customers\* home networks The trailing instructor gives me technician a starter kit with cables, cable ends, and other network equipment and asks mm to build a working network.

The computer should be connected to have internet connectivity and the phone should be connected to have a dial tone.

#### INSTRUCTIONS

Use the appropriate cables. cable ends, tools and equipment to configure the network ana connect an components accordingly

There are 3 steps and the simulation starts on step 1.

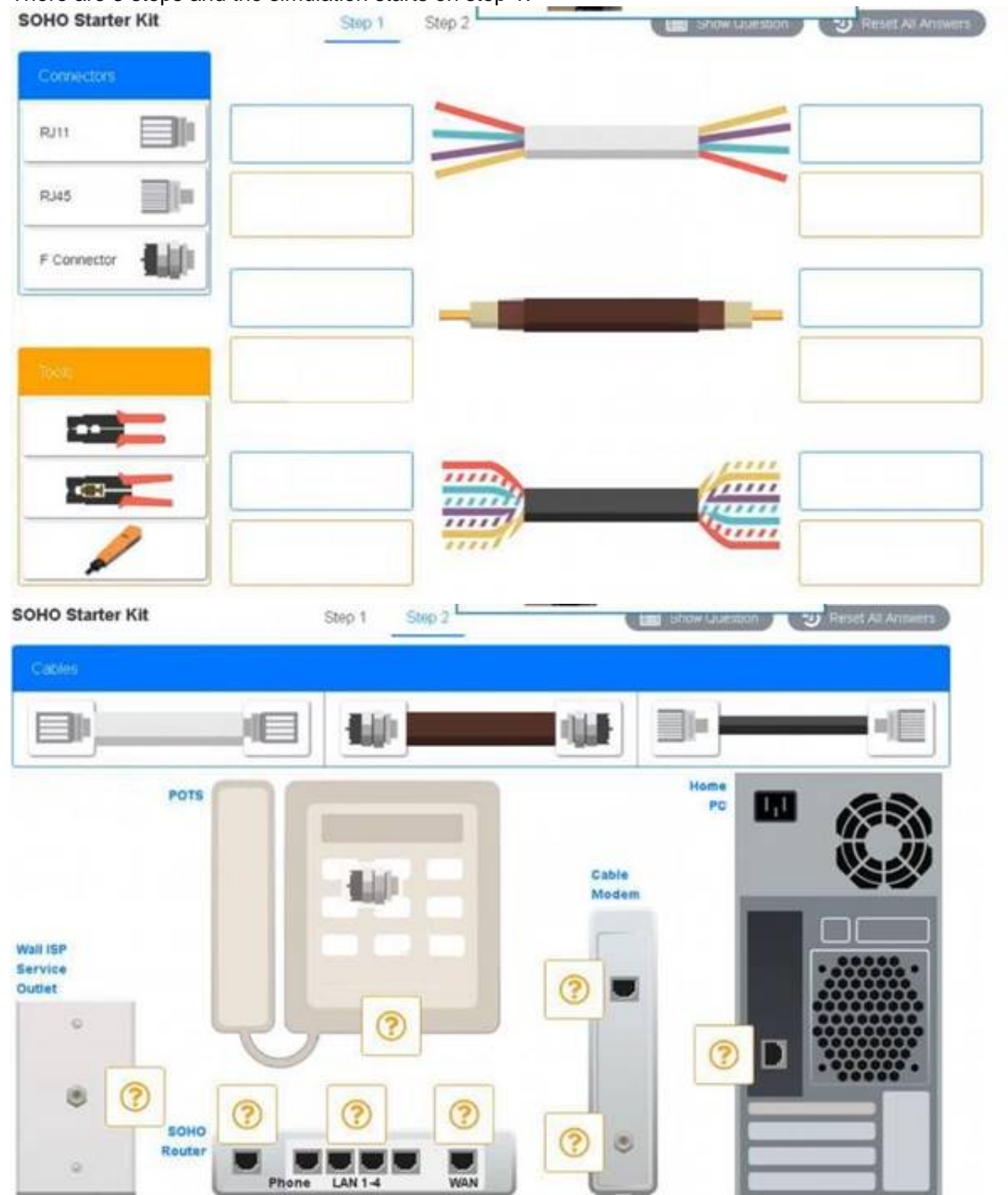

- A. Mastered
- B. Not Mastered

Answer: A

#### Explanation:

Answer of both steps below.

A picture containing text, screenshot, indoor Description automatically generated

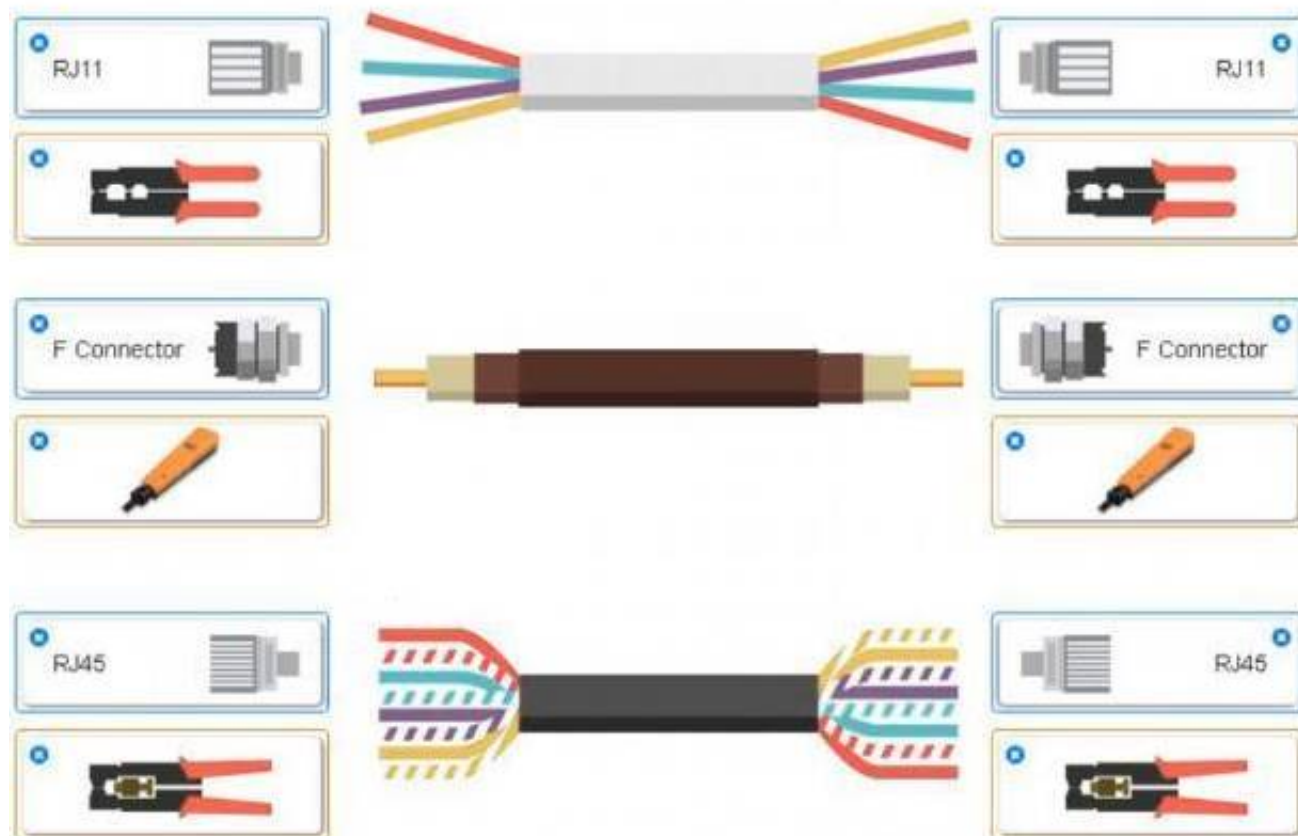
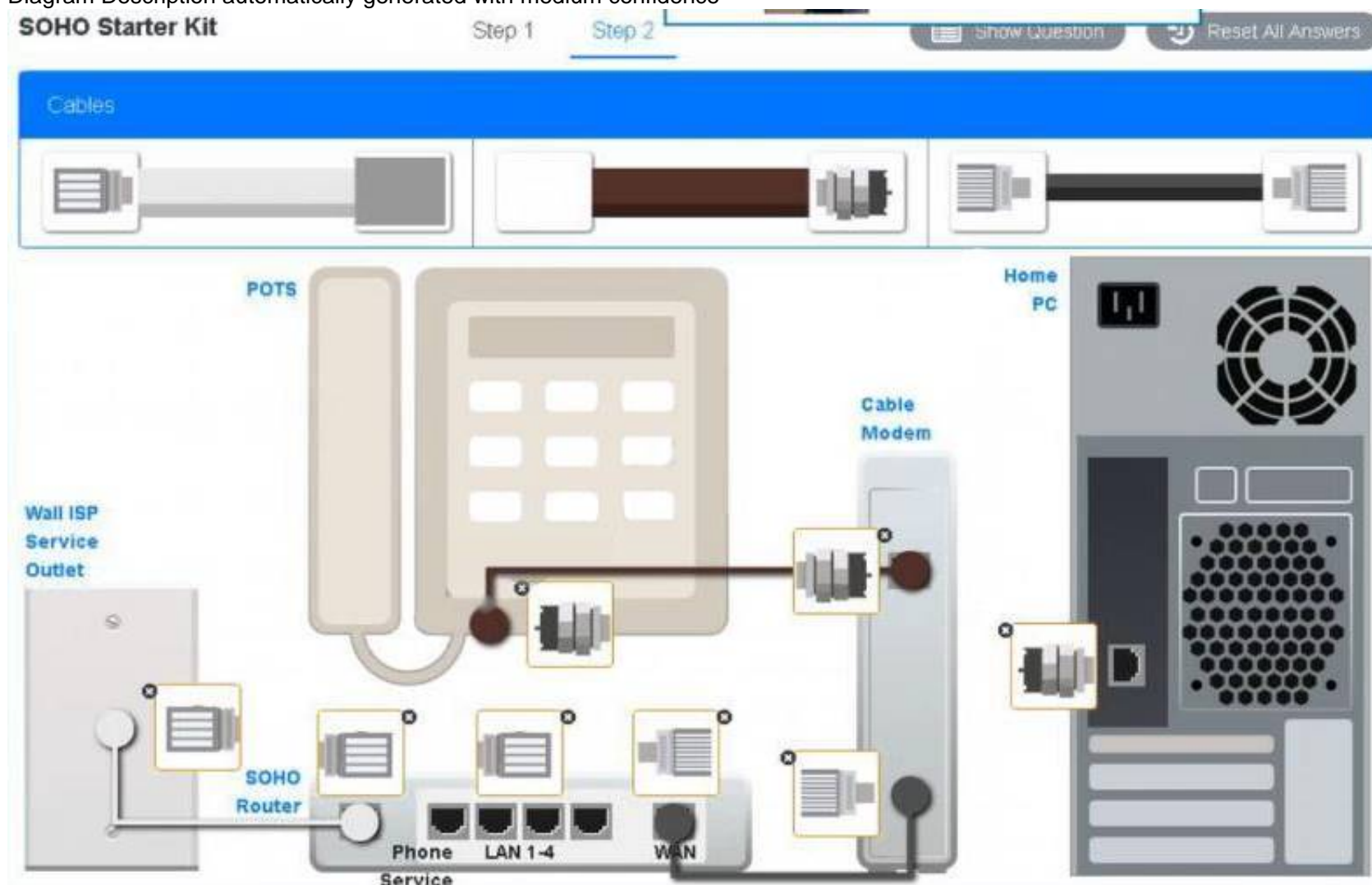

Diagram Description automatically generated with medium confidence



#### NEW QUESTION 115

The owner of a restaurant reports that wireless network connections are lost intermittently throughout the day. Which of the following steps should a technician take to troubleshoot the issue? (Select TWO).

- A. Identify the location of devices that utilize 2.4GHz.
- B. Check to see if the phones are IJTP or STP lines.
- C. Test to see if the copper electrical Wires are causing interference.
- D. Map all of the wireless signals in the restaurant.
- E. Verify T568B is being used in the wiring closet patch panel.
- F. Schedule timed router reboots throughout the day.

**Answer: AD**

#### Explanation:

The correct answers are A. Identify the location of devices that utilize 2.4GHz and D. Map all of the wireless signals in the restaurant. In order to troubleshoot the issue, the technician should first identify the location of devices that utilize the 2.4GHz frequency, as this can cause interference with the wireless signal. Additionally, the technician should map all of the wireless signals in the restaurant in order to identify any potential sources of interference. Checking to see if the phones are IJTP or STP lines, testing to see if the copper electrical wires are causing interference, verifying T568B is being used in the wiring closet patch panel, and scheduling timed router reboots throughout the day are not necessary steps for troubleshooting this issue.

#### NEW QUESTION 119

A user that works in sales is reporting that the output on each page printed from a laser has duplicate images. Which of the following should be performed FIRST to eliminate the ghost images?

- A. Change the paper weight setting.
- B. Replace the printer's fuser.
- C. Upgrade the printer firmware.
- D. Clean the toner drums and rollers

**Answer:** C

#### NEW QUESTION 124

A user working in the field reported the GPS stopped working on a phone. The user's older, in-car GPS continued to function. Later, the user reported that the phone's GPS started working again. Which of the following MOST likely caused the phone's GPS to fail?

- A. The cell phone was in conservation mode
- B. The cell phone had lost service to the carrier
- C. The cell phone received a firmware update
- D. The cell phone had overheated

**Answer:** A

#### NEW QUESTION 125

A colleague has a laptop that has been working as expected for several years wall outlet. The MOST likely component that needs to be replaced is the:

- A. power adapter.
- B. battery.
- C. system fan.
- D. hard drive.

**Answer:** B

#### NEW QUESTION 128

A technician just finished assembling a new PC for a client. Upon POST, the device presents an unspecified beep code and turns off automatically after five seconds. The technician double-checks the bill of materials for the new build and confirms all items have been installed. Which of the following should the technician do NEXT?

- A. Ensure thermal paste is being used on the CPU.
- B. Check to make sure that any video cards have auxiliary power cabling connected.
- C. Verify the header panel connector is properly connected.
- D. Spot-check that the I/O shield for the motherboard is properly installed.

**Answer:** C

#### Explanation:

The technician should verify the header panel connector is properly connected. A beep code is a diagnostic tool used by motherboards to indicate issues with hardware components. This beep code may be indicating an issue with the connection between the motherboard and the case's header panel connector. This connector is responsible for providing power to the system and any connected peripherals. Therefore, the technician should verify the connection is secure and properly connected before attempting any other troubleshooting steps.

#### NEW QUESTION 132

A technician is replacing the RAM on an entry-level server with hot-swappable components. Which of the following should the technician do NEXT?

- A. Replace the RAM while the server is at a cool temperature
- B. Replace the RAM while the server is running
- C. Power down the server completely and then replace the RAM
- D. Verify that the OS supports hot swapping the RAM

**Answer:** C

#### NEW QUESTION 135

A technician made several upgrades to a computer and then determined the power supplied by the PSU is insufficient. Which of the following would MOST likely cause the insufficiency? (Select TWO).

- A. Replacing the HDD with an SSD
- B. Upgrading the firmware
- C. Adding an optical drive
- D. Adding more RAM
- E. Adding a CMOS battery
- F. Upgrading the graphics card

**Answer:** CF

#### Explanation:

<https://www.buildcomputers.net/power-consumption-of-pc-components.html>

#### NEW QUESTION 140

Which of the following would be BEST reason to use a virtual machine as a sandbox?

- A. To test new software in a safe environment
- B. To increase the efficient use of computing resources
- C. To run multiple machines on the same hardware
- D. To have dedicated hardware for a single system

**Answer:** A

#### NEW QUESTION 143

A technician is troubleshooting a projector that will not display any Images. The technician has verified the computer output and cable are providing a good video signal. Which of the following should the technician do NEXT?

- A. Calibrate the image.
- B. Replace the bulb.
- C. Test the output resolution.
- D. Clean the fans.

**Answer:** A

#### NEW QUESTION 144

A technician is troubleshooting a smartphone that has a large dark area on the screen. The screen has no damage to indicate that it is cracked. Which of the following BEST describes why a blot is on the screen?

- A. Digitizer damage
- B. Improper charging
- C. Ambient light sensor damage
- D. Liquid damage

**Answer:** A

#### Explanation:

A blot on the screen of a smartphone is most likely caused by damage to the digitizer, which is the part of the device responsible for interpreting touch input. Improper charging is unlikely to cause a blot on the screen, as is damage to the ambient light sensor. Liquid damage is a possibility, but it is more likely to cause discoloration or other physical damage to the screen.

#### NEW QUESTION 146

Several users who share a multifunction printer in an office have reported unintended, thin, vertical lines that cover the entire height of every page printed from the printer. Which of the following steps should a technician complete in order to MOST likely resolve this issue?

- A. Replace the printer paper with a new ream.
- B. Clear the print spooler on each computer.
- C. Reinstall the printer driver on each computer
- D. Perform the drum-cleaning procedure.

**Answer:** D

#### NEW QUESTION 149

Which of the following is the SAFEST way to replace RAM on a server that has a redundant power supply?

- A. Unplug one power cable.
- B. Verify the RAM temperature.
- C. Utilize a grounding strap.
- D. Replace the RAM while the server is running.

**Answer:** C

#### Explanation:

Utilizing a grounding strap is the safest way to replace RAM on a server that has a redundant power supply. This is because the grounding strap prevents electrostatic discharge (ESD) when handling the RAM, which can cause damage to the RAM and the server. Therefore, it is important to always use a grounding strap when handling RAM or other sensitive components.

#### NEW QUESTION 150

A small office has a wireless network with several access points for roaming laptop use. Users occasionally report that the wireless connection drops or becomes very slow. Users have confirmed that this issue only happens when connected to the office wireless network. Which of the following would MOST likely be the cause?

- A. Hidden SSID
- B. Device interference
- C. Ethernet port flapping
- D. High ISP latency

**Answer:** B

#### NEW QUESTION 152

While implementing a non-carrier-grade wireless backhaul, a technician notices the current channel selection is extremely polluted with various RF signals. Upon



performing a spectral analysis, the technician discovers a channel containing almost no RF pollution. Unfortunately, the technician is unable to select that channel. Which of the following is the MOST likely reason for this issue?

- A. The channel is reserved for licensed band use.
- B. The channel selection is defective; contact the manufacturer.
- C. The channel must be unlocked by the vendor.
- D. The device requires a firmware update to unlock the channel.

**Answer:** D

#### NEW QUESTION 156

.....

## THANKS FOR TRYING THE DEMO OF OUR PRODUCT

Visit Our Site to Purchase the Full Set of Actual 220-1101 Exam Questions With Answers.

We Also Provide Practice Exam Software That Simulates Real Exam Environment And Has Many Self-Assessment Features. Order the 220-1101 Product From:

<https://www.2passeasy.com/dumps/220-1101/>

## Money Back Guarantee

### 220-1101 Practice Exam Features:

- \* 220-1101 Questions and Answers Updated Frequently
- \* 220-1101 Practice Questions Verified by Expert Senior Certified Staff
- \* 220-1101 Most Realistic Questions that Guarantee you a Pass on Your FirstTry
- \* 220-1101 Practice Test Questions in Multiple Choice Formats and Updatesfor 1 Year